

P1
2050 PAVING 1 - VEHICLE CARRIAGEWAY

Surface Course: 40mm AC14 Close surf 100/150 PSV65 to BS EN13108-1 Asphalt Concrete
Ref: Brett 'Invicta FLOW' (Code: INF2160MO and INF2160PE)
Binder Course: 60mm DBM to BS.4987 20mm Nominal Size Stone, 100 Pen Binder. Stone to be crushed rock or slag. All to CL.906 S.F.H.W.
Base Course: 90mm DBM to BS.4987, 40mm Nominal Size Stone, 100 Pen Binder. All to CL.906 S.F.H.W.
Sub-base: 325mm DOT Type 1 granular material
Geotextile: Tensar TX190L Geogrid or similar approved. (subject to tensar approval of CBR testing). The Contractor shall carry out further testing to validate the precise C.B.R. Value.

NOTE:
Detail retained for costing purposes. All surface and sub-base to Engineer's details to comply with Adoptable Standards for Carriageway construction. Please refer to Engineer's details.

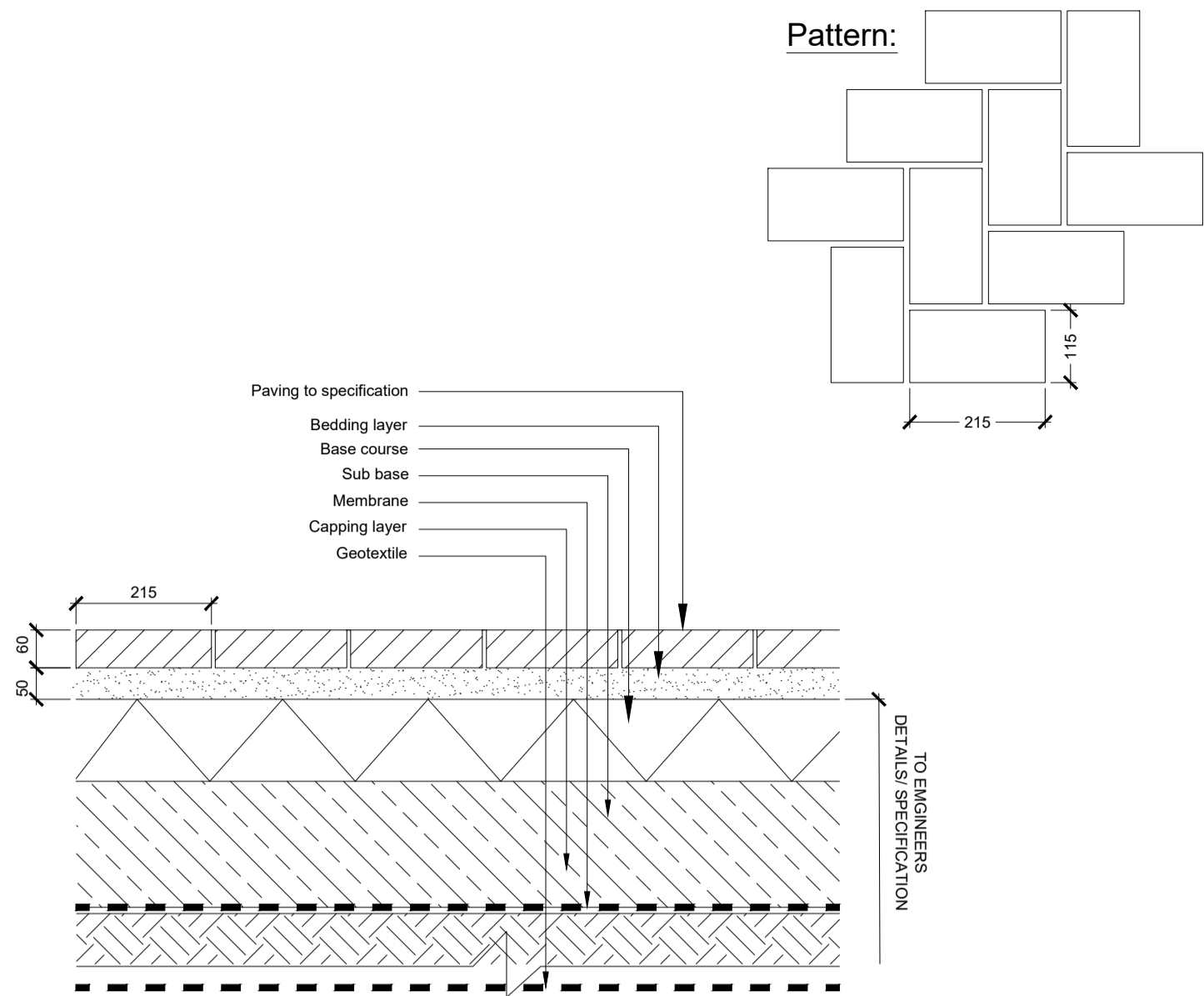

P2
2050 PAVING 2 - PERMEABLE BLOCK PAVING TO ROAD & FOOTPATH

Paving: Pre-cast concrete paving with natural aggregate finish to vehicle & pedestrian areas
Ref: Brett 'Invicta FLOW' (Code: INF2160MO and INF2160PE)
Size: 215 * 115 * 60mm
Colour: Moonstone (50%) & Pearl (50%)
Pattern: Herringbone 90 - 50/50 bond (laid as per the Paving drawing indicates)
Supplier: Brett Landscaping or similar approved
Bedding layer: 50mm compacted thickness of bedding stone to BS EN13242:2002, Type 2/6.3 Gc 80/20
(Below detail to Engineers design & specification)
Base course: 130mm Recipe mix AC 32 dense base 40/60 to EN13108-1 (to be punctured on a 750 x 750mm grid using a 75mm drilled hole prior to laying bedding course and blocks. Holes to be filled with bedding aggregate)
Sub base: 200mm min. compacted thickness of course aggregate subbase to BS EN 13242:2002 Type 4/20.
Membrane: 2000 gauge impermeable membrane base and sides
Capping Layer: 350mm 6F2 Capping
Geotextile: Terram 1000 base and sides

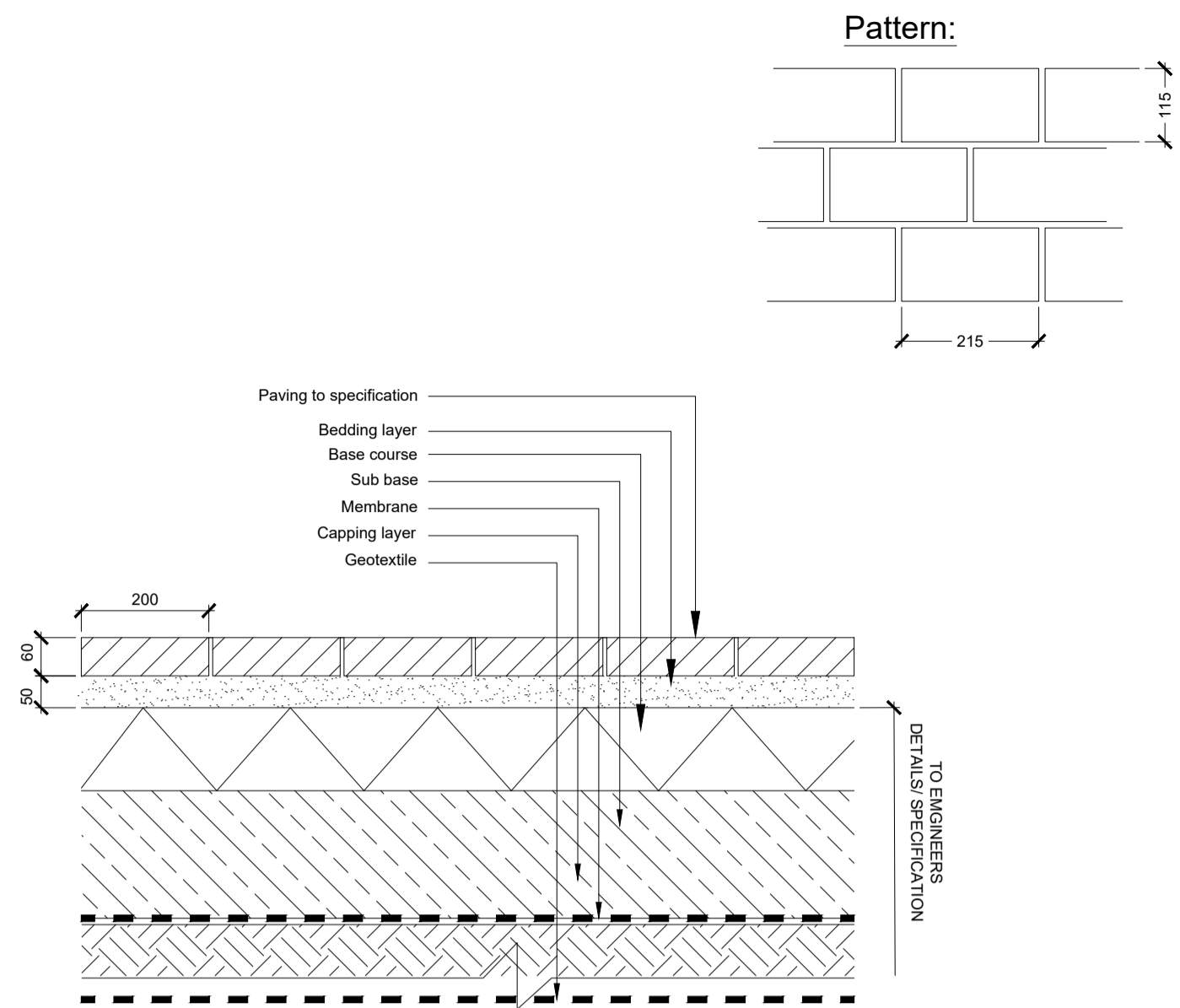

P3
2050 PAVING 3 - PERMEABLE BLOCK PAVING TO CENTRAL VEHICLE ROUTE

Paving: Pre-cast concrete paving with natural aggregate finish to vehicle & pedestrian areas
Ref: Brett 'Invicta FLOW' (Code: INF2160ON)
Size: 215 * 115 * 60mm
Colour: Onlyx
Pattern: Staggered stretcher bond - 50/50 bond (laid as per the Paving drawing indicates)
Supplier: Brett Landscaping or similar approved
Bedding layer: 50mm compacted thickness of bedding stone to BS EN13242:2002, Type 2/6.3 Gc 80/20
(Below detail to Engineers design & specification)
Base course: 130mm Recipe mix AC 32 dense base 40/60 to EN13108-1 (to be punctured on a 750 x 750mm grid using a 75mm drilled hole prior to laying bedding course and blocks. Holes to be filled with bedding aggregate)
Sub base: 200mm min. compacted thickness of course aggregate subbase to BS EN 13242:2002 Type 4/20.
Membrane: 2000 gauge impermeable membrane base and sides
Capping Layer: 350mm 6F2 Capping
Geotextile: Terram 1000 base and sides

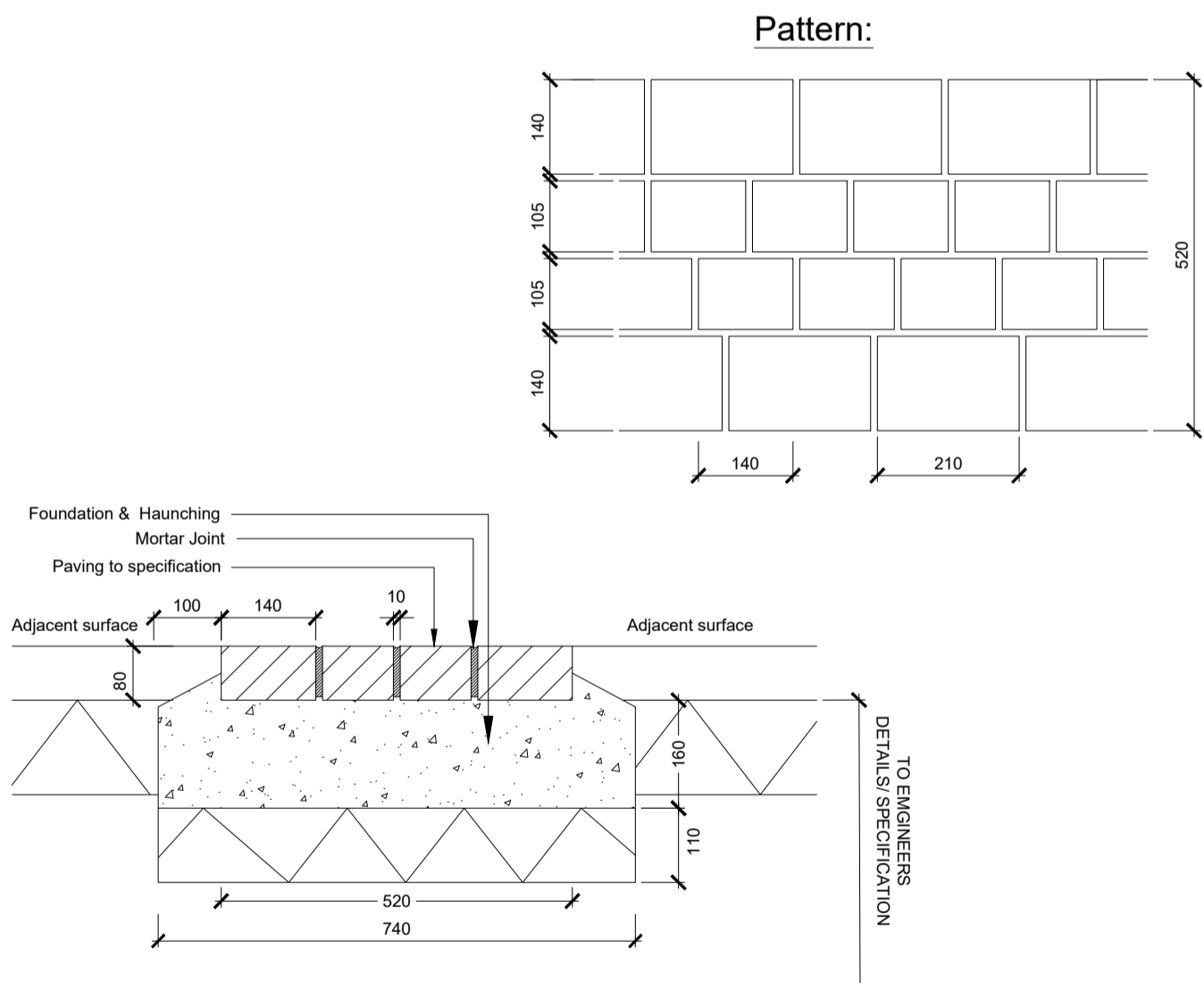

P4
2050 PAVING 4 - BANDING TO COMMUNAL AREAS

Paving: PCC Textured granite effect sett paving for banding
Ref: Brett 'Lugano' Graphite Grey
Size: 210 * 140 * 80mm for band edges (Ref: LUL80GG)
105 * 140 * 80mm for inner stones (Ref: LUS80GG)
Colour: Graphite Grey
Pattern: Staggered stack bond - (laid as per the Paving drawing indicates)
Supplier: Brett Landscapes or similar approved

(Below detail to Engineers design & specification)
Foundation: Foundation on 160mm Grade ST2 concrete bed & haunch to BS 7263 Part 1 1994
Sub-base: 110mm Type 1 below concrete bed
Membrane: 2000 gauge impermeable membrane base and sides
Capping Layer: 350mm 6F2
Joins: 10mm concave mortar joint using a standard Class II 3:1 sand/cement mortar with additional strengthening additive such as Styrene Butadiene Resin, for enhanced bonding and water resistance. Colour: Dark Grey (e.g Marshall's DARK BLACK GREY - PM66)

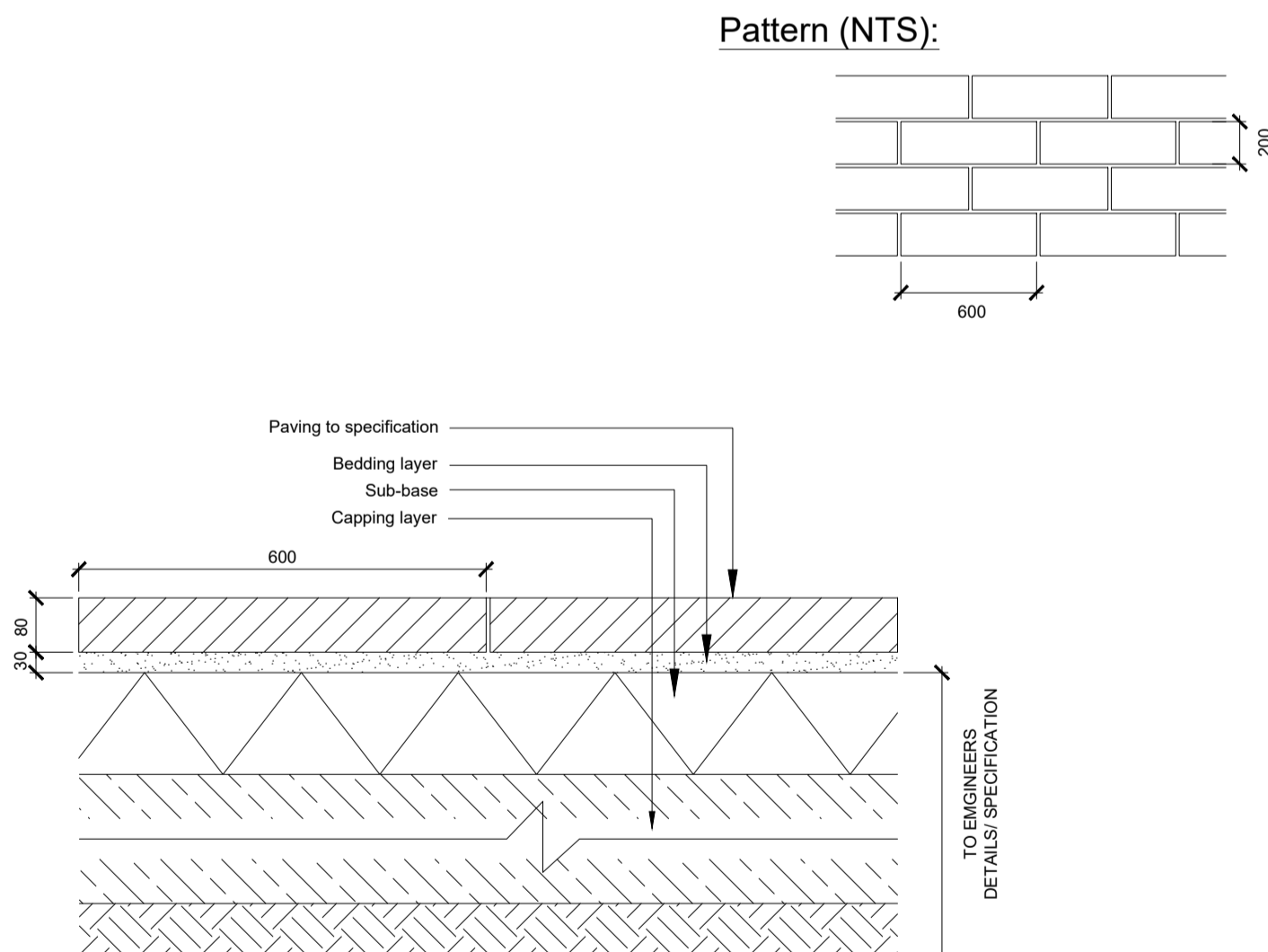

P5
2050 PAVING 5 - PAVING TO PRIVATE GROUND FLOOR TERRACES (IMPERMEABLE)

Paving: Pre-cast concrete paving with natural aggregate finish to private frontages
Ref: Brett Landscaping 'Invicta'
Size: 600 * 200 * 80mm
Colours: a) Pearl (Ref: IN6280PE) 50% mix
b) Moonstone (Ref: IN6280NO) 50% mix
Pattern: Staggered stretcher bond - 50/50 bond (laid as per the Paving drawing indicates)
Supplier: Brett Landscapes or similar approved
Bedding layer: 50mm Compacted sharp sand (compacted to 30mm)
(Below detail to Engineers design & specification)
Sub base: 200mm min. compacted thickness of course aggregate subbase to BS EN 13242:2002 Type 4/20.
Membrane: 2000 gauge impermeable membrane base and sides
Capping Layer: 350mm 6F2 Capping
Geotextile: Terram 1000 base and sides

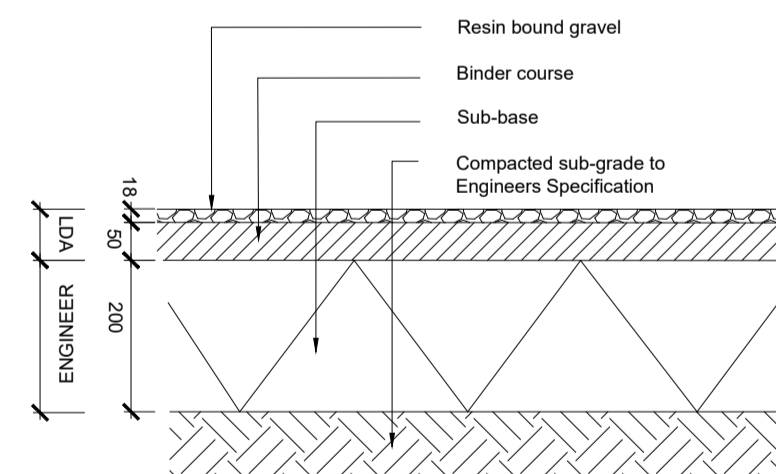

P6
2050 PAVING 6 - RESIN BOUND GRAVEL TO RAILWAY FEATURE & COMMUNAL GARDEN PATH

Paving: Ref: Sureset resin bound gravel or similar approved
Colour: Stirling Midnight mix 6mm
Laying Course: 18mm
Base Course: 50mm Open surf AC10 or AC14
Sub-base: 200mm min. compacted thickness of course aggregate sub base to BS EN 13242:2002 Type 4/20.
Sub-grade: All sub-grade works to Engineers specification
Supplier: SureSet UK Ltd, 32 Deverill Rd, Sutton Veny, Wainminster BA12 7B. Tel: 01985 841180
NOTE: Type 1 in accordance with EN BS 7533-2

CDM Regulations 2015

ALL current drawings and specifications for the project must be read in conjunction with the Designer's Hazard and Environmental Assessment Record.

notes

- The contractor is responsible for checking dimensions, tolerances and references. Any discrepancy to be verified with the Architect before proceeding with the works.
- Where an item is covered by drawings to different scales the larger scale drawing is to be worked to.

P1	ISSUED FOR PLANNING	13.02.23
REV	AMENDMENT	DATE

Client:
GREYSTAR

GREYSTAR™
The Global Leader in Rental Housing

Project:
CROWN TRADING CENTER, HAYES, LONDON

Title:
DETAILS - SURFACING 01

Scale:
1:10 | A1

Date
APR 2021
Drawn
DS
Checked
PW



L.D.A
LANDSCAPE DESIGN ARCHITECTURE
17a Cannon Hill Rd
Coventry
CV4 7AZ
Tel: 02476 696666 Mob: 07977 453787
info@landscapedesignarchitecture.co.uk

Drawing no. L1115 - 3.1 - 2050

Job no. L1115

Revision. P1