



**ROOF LIGHTS on pitch roof**  
Rooflights to be double glazed + to meet 'U' value of min. 2.0 W/m sq.K.  
All roof lights to be A-A fire rated.  
  
Double up rafters on the side of opening, supporting double trimmers above & below opening. Bolt together with M12 bolts at 450 c/s.  
Must be 450mm minimum clear opening with non opening fasteners.

Slim line frame for pitched roof.  
Reset within roof tiles.  
Can be fixed to roof pitch as low as 12 deg. & as high as 90 deg.

- New internal walls
- New external walls
- Walls to be demolished
- New doors/windows
- Proposed work shaded
- Rooflight

**JULIET BALCONY** - Balcony glass to be 21.5mm laminated toughened  
Railing to be min 1.1 meter high from SILL  
Strength - handrail/glass pressure must be able to take 1.5kN/m and to meet BS 6180:2011 and be tested for impact loading in accordance with BS 6206 and BS EN 12600.  
"Frameless Juliette system, Code: FBAL 100 R from Balconette" or similar

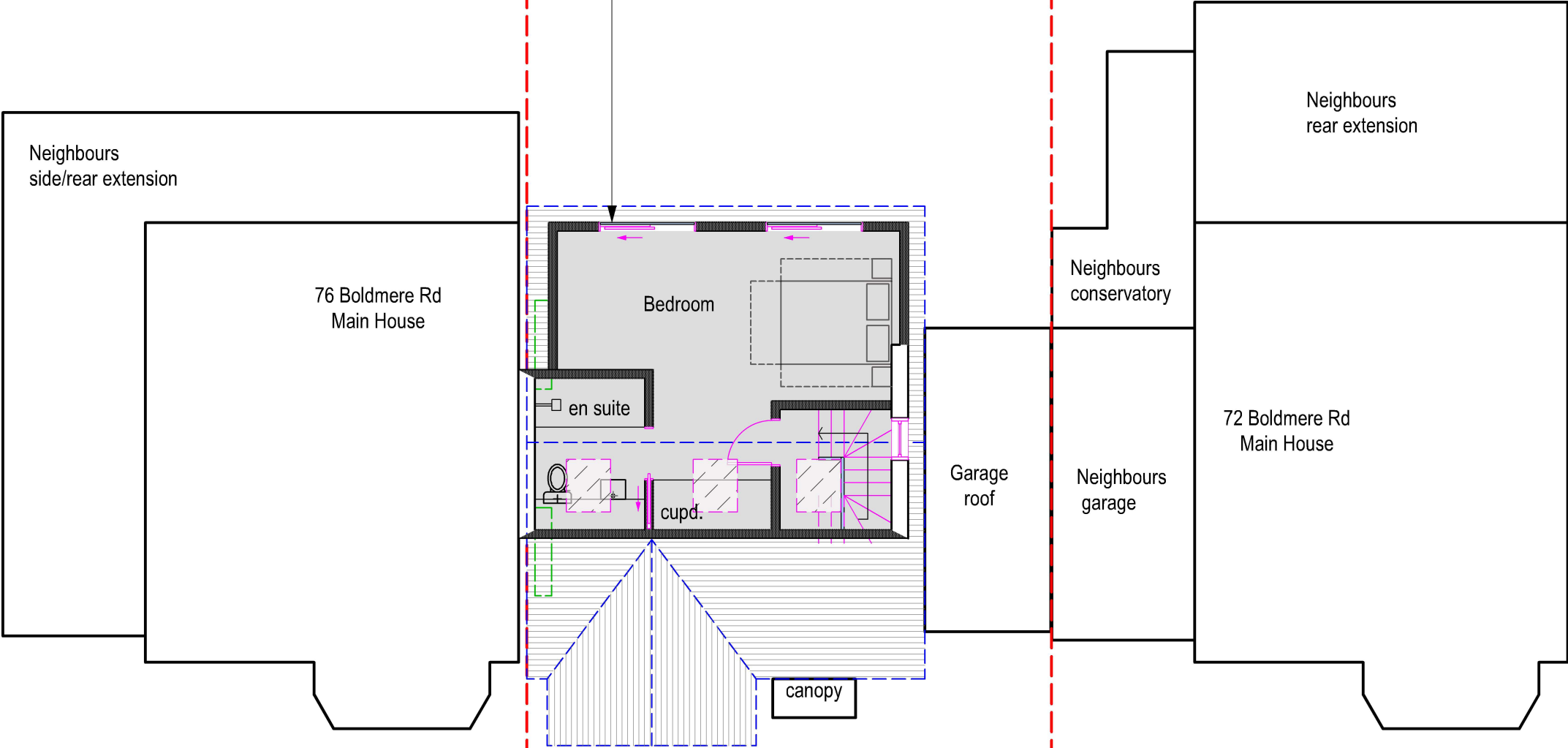

10 **PROP ROOF PLAN**  
Scale: 1:100

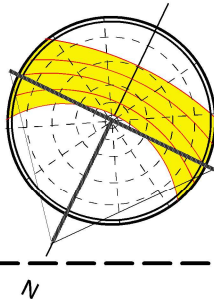

**PROPOSED**



tel : 0796 222 3141  
email : sandeep@sskarchitects.co.uk

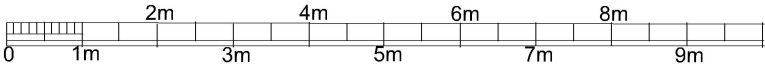

scale - 1 : 100 @ A3

**Purpose - Certificate of lawful development**

All dimensions to be checked on site. All omissions & discrepancies to be reported to the designer.	PROJECT: 74 Boldmere Rd. Pinner, HA5 1PP	DATE: 20/02/2024
© SSK architects owns the copyright of this drawing which must not be reproduced in whole or part without the written permission.	DWG NO: <b>PROP LOFT</b>	REVISION: <b>10</b>