

Note: This Drawing is for planning purpose and should not be used for construction.
All dimensions should be confirmed on site and any deviation should be reported back to designer.

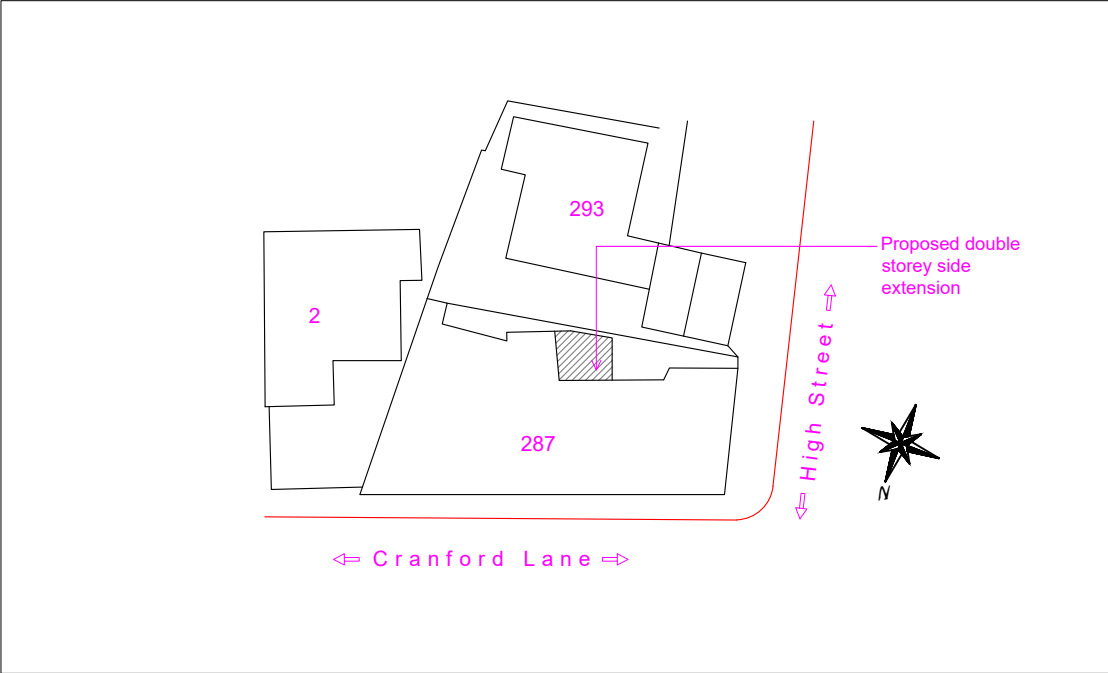

Site Plan @ Scale 1:500



Location Plan @ 1:1250

Proposed Development:
Mixed use ground floor Restaurant and first floor HMO along with double storey side extension

Site Address:
287 Harlington High Street
Hayes
UB3 5DG

Revisions:		
Rev	Date	Description
A	15/01/2025	

Drawing Description:
Site plan & Location Plan

Drawing No:
ART/2025/CU287HS/SPLP

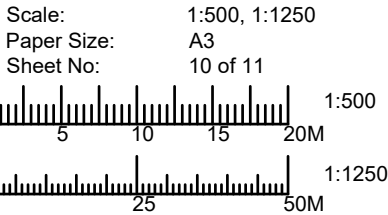

ART CONSULTANTS (UK) LTD
113 LONG LANE
STANWELL
TW19 7AL
M:07960071377
E: ARTCONSULTANTSUK@GMAIL.COM