

ZC 43, 42 Reinstatement Information Note

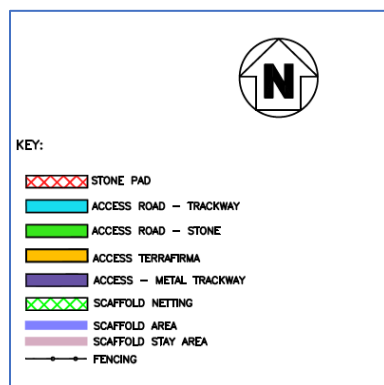
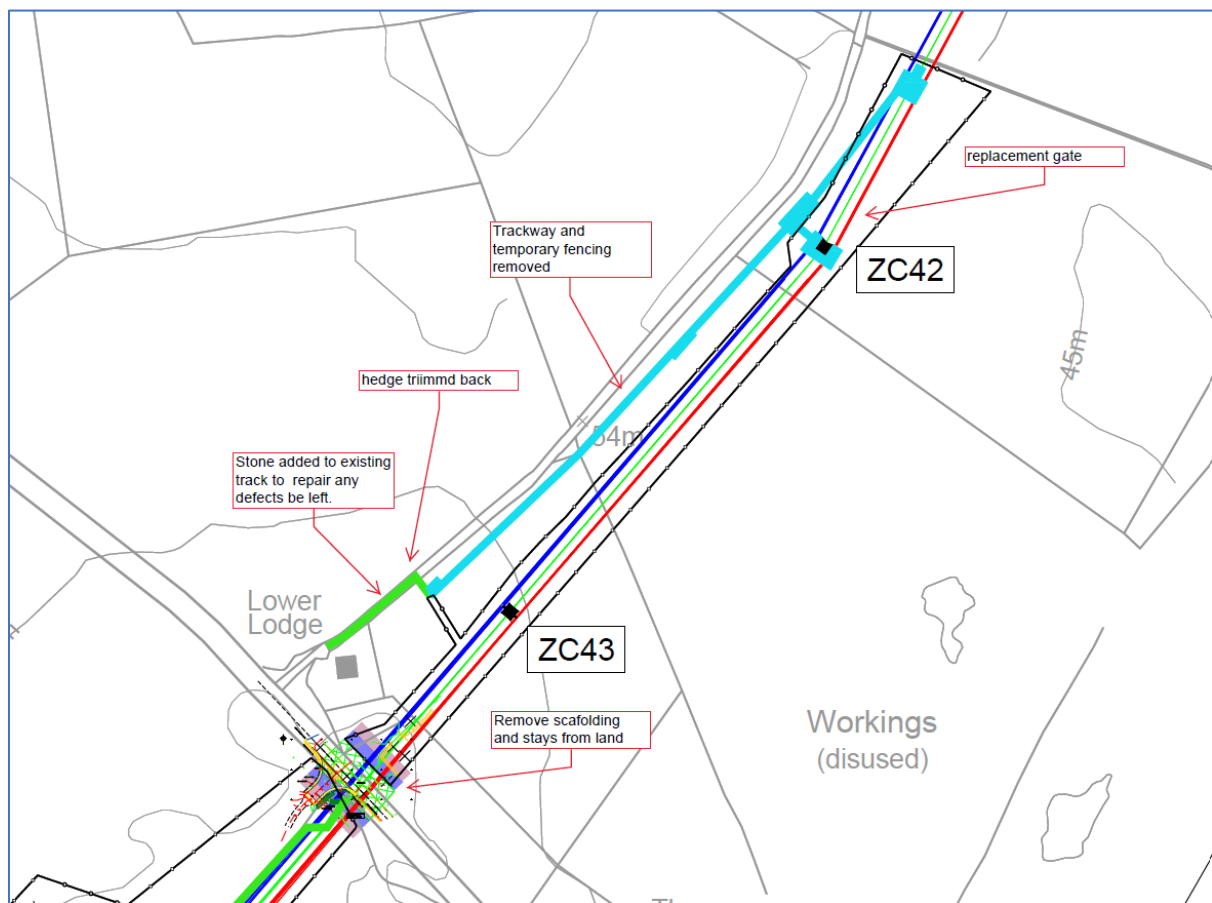

Reinstatement & gate upgrade at ZC42 access.

The access to ZC42 has undergone a significant upgrade creating a safe access and egress entrance. There has been minor vegetation clearance and minor ground regrading under ecology supervision which has removed the risk of slips, trips and falls due to uneven ground conditions and overgrown brambles which surrounded the old decaying unstable access gate. The old gate has been replaced with a superior seven rail hot dipped galvanised field gate with a spring bolt fastening system with new superior hot dipped galvanised gate posts.

Location Plan



ZC 43, 42 Reinstatement Information Note

Photographs of Access		
		Before works
		After works