

- NOTES
- N1 - 110MM PIPE TO SOAKAWAY OR EXISTING SURFACE WATER DRAINAGE.
 - N2 - CONNECT TO EXG SEWER, TBC ON SITE

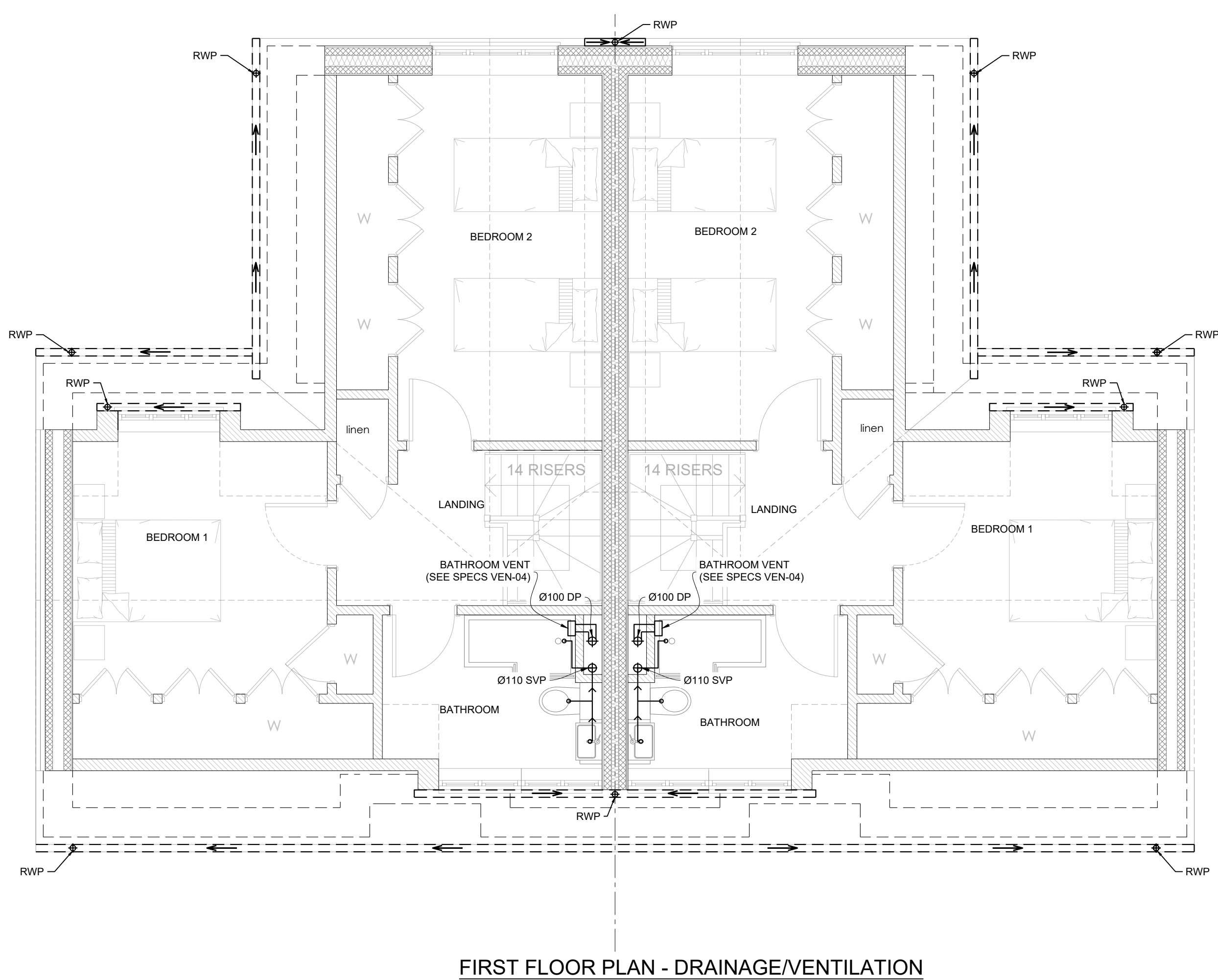
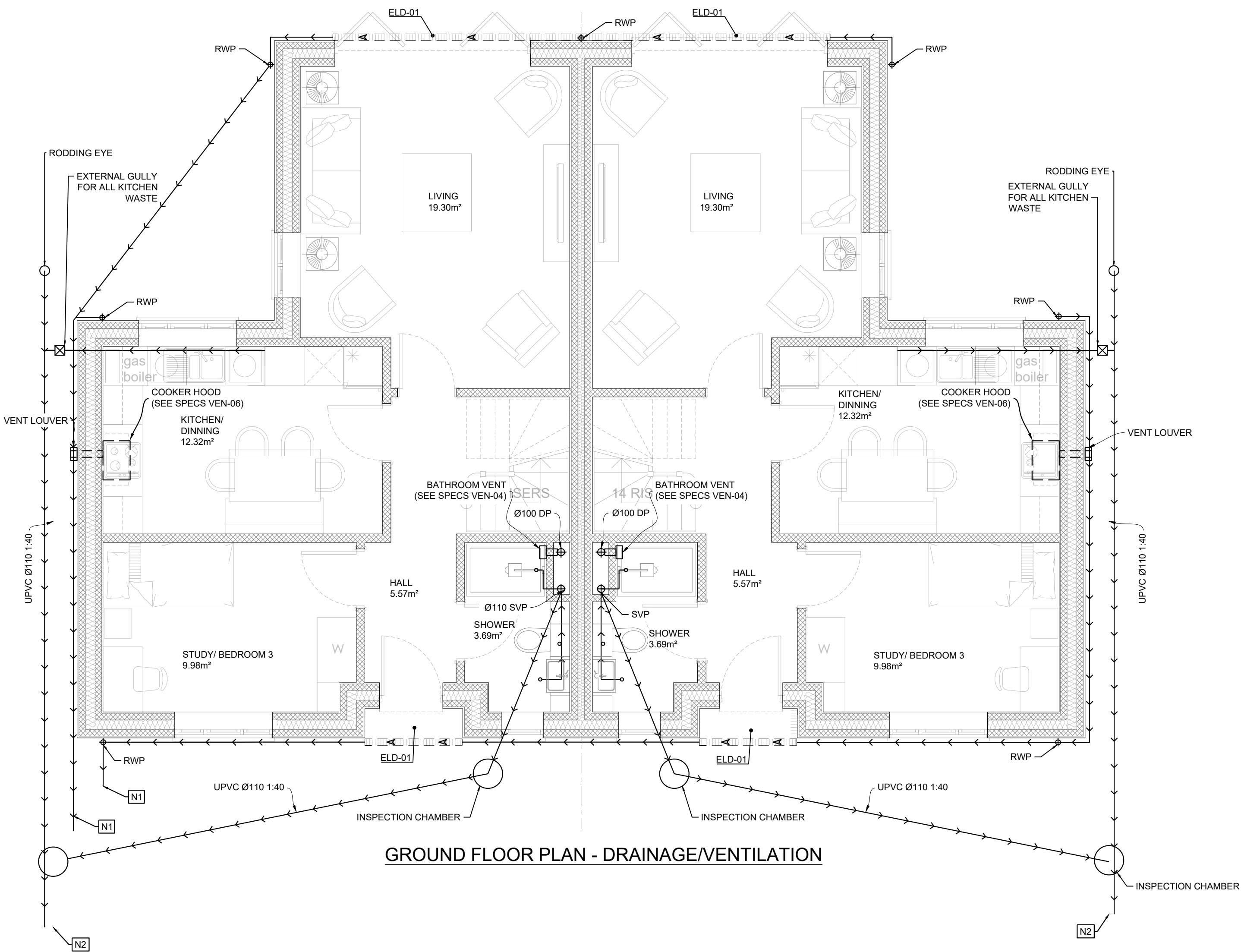

Studio 1, The Hub,
3 Drove Road,
Newhaven BN9 0AD

t: 01323 325354
t: 01932 506111
e: support@staac.co.uk

NOTES:
THIS DRAWING IS TO BE READ IN CONJUNCTION
WITH ALL RELEVANT ARCHITECTURAL
DRAWINGS, CALCULATIONS, SPECIFICATIONS
AND GENERAL INFORMATION SHEET.
ALL FIGURED DIMENSIONS TO BE VERIFIED ON
SITE PRIOR TO COMMENCEMENT OF WORK.
EXISTING STRUCTURE INCLUDING FOUNDATIONS,
BEAMS, WALLS AND LINTELS CARRYING NEW AND
ALTERED LOADS ARE TO BE EXPOSED AND
CHECKED FOR ADEQUACY AND REPORTED BACK
TO ENGINEERS PRIOR TO COMMENCEMENT OF
WORK AND AS REQUIRED BY THE BUILDING
CONTROL OFFICER.

Please be aware that site visits will incur a £250
fee. Any alterations required will be charged as per the
original fee proposal.

Rev No.	Description
0	First issue
1	/
2	//

Client: Paul Neal Corsa Consultants

Address: Green Walk Garages Ruislip HA4
8NL

Project: New build

Drawing title: Floor plans -
Drainage/Ventilation

Project No 23076

Date 05-12-23

Drawn by JG

Drawing No BR04

Scale 1:50@A1 / 1:100@A3

