

DROPPED BN KERB DETAIL (0mm UPSTAND)

AS DENOTED BY

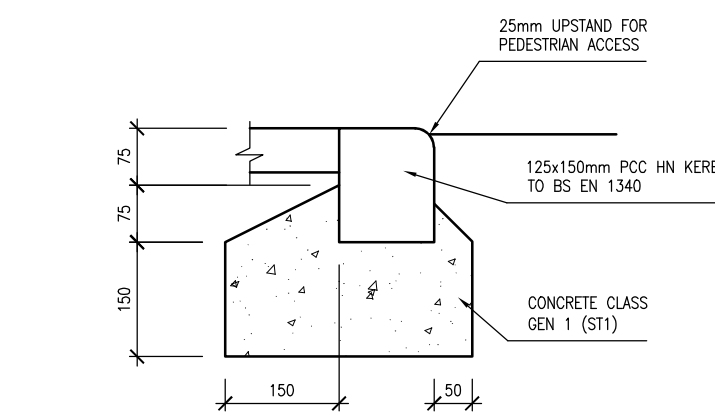

DROPPED BN KERB DETAIL (25mm UPSTAND)

AS DENOTED BY

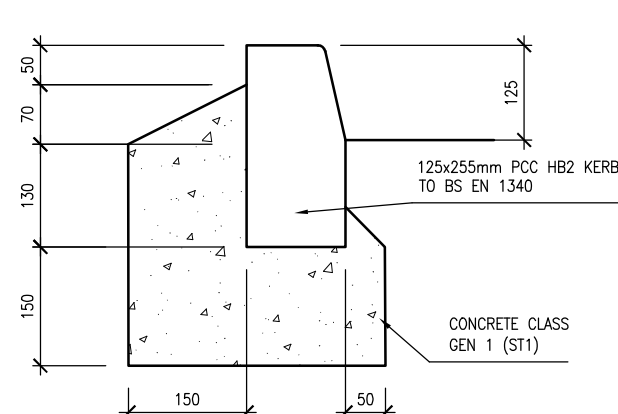

FULL HEIGHT KERB DETAIL

AS DENOTED BY

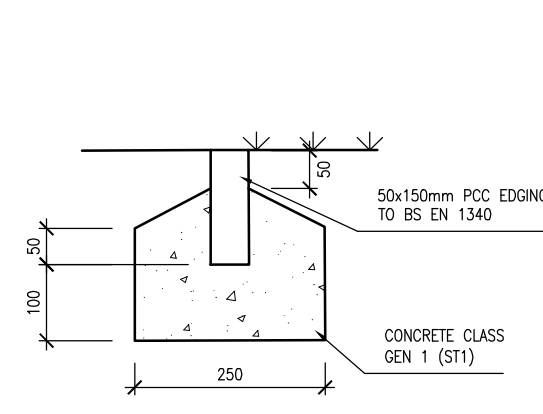

PCC EDGING KERB

AS DENOTED BY

LEGEND

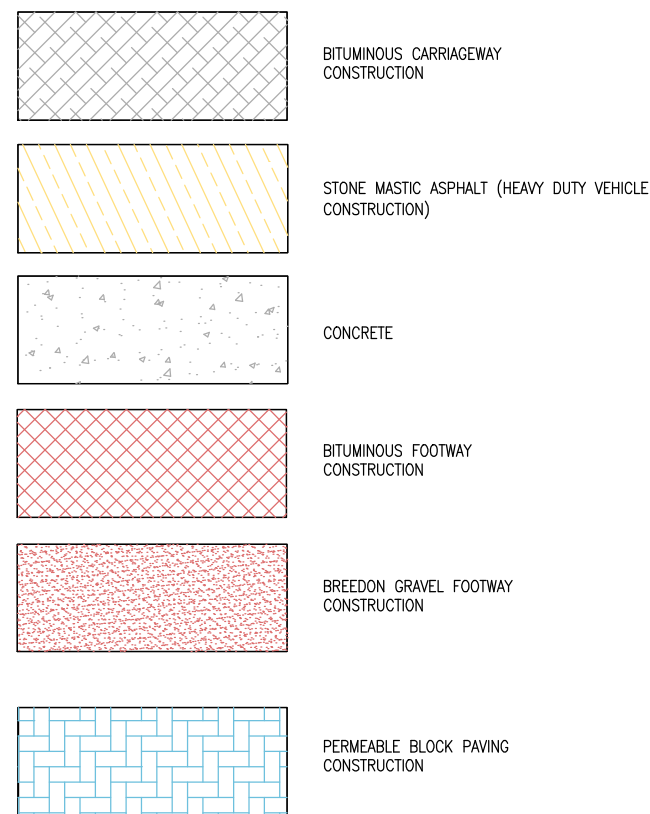

125mm UPSTAND PCC HB KERB
25mm UPSTAND DROPPED PCC BN KERB
0mm UPSTAND DROPPED PCC BN KERB (ALSO DENOTED WITH 'DN' WHERE FORMING PEDESTRIAN DROPPED KERB)
FLUSH PCC EDGINGS
SITE BOUNDARY

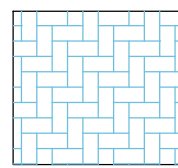
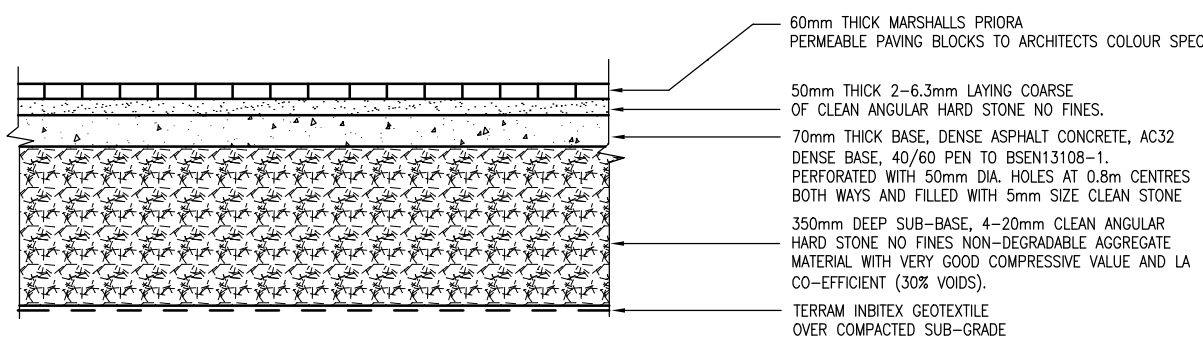

PRIVATE PARKING/DRIVE PERMEABLE BLOCK PAVING

(PRIVATE DRIVE/ROAD FOR CARS LIGHT VEHICLES, PLUS EMERGENCY ACCESS - MARSHALLS CAT 4 LOAD)

NOTE: PERMEABLE BLOCKS TO BE Laid IN HERRINGBONE PATTERN WITH DOUBLE STRETCHER BOND AGAINST THE KERBLINES.

PERMEABLE STONE SPECIFICATIONS AS BS 7533 PART 13

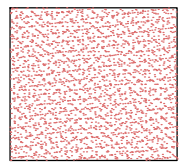
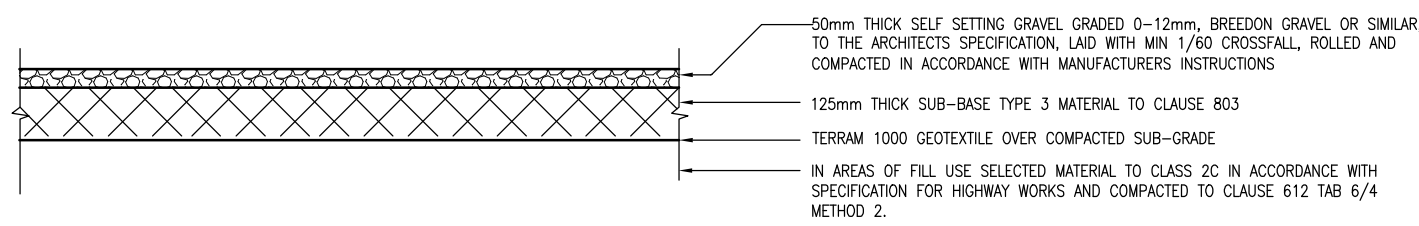

SELF SETTING GRAVEL

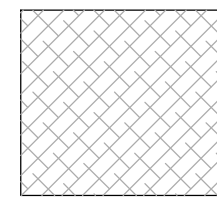

PRIVATE BITUMINOUS CARRIAGEWAY CONSTRUCTION

(PRIVATE ROAD HAVING FREQUENT USE BY COMMERCIAL VEHICLES)

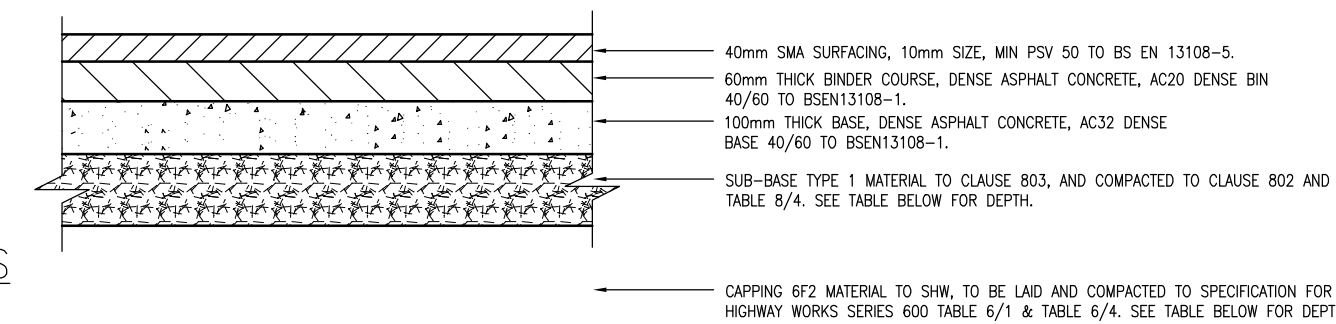

SUB-BASE ONLY OPTION TO NHBC STANDARDS	
CBR VALUE TO BE TESTED ON SITE AND SUB-BASE/ CAPPING LAYER THICKNESS AGREED ON SITE WITH ENGINEER AND SHALL BE WITHIN THE FOLLOWING RANGES. ANY SOFT SPOTS OR FILL AREAS TO BE BUILT UP IN 6F2.	
CBR <2%	SUB-BASE ONLY (TYPE 1) CONTACT ENGINEER FOR ADVICE
CBR 2% TO 3%	325mm
CBR 3% TO 5%	250mm
CBR >5%	150mm

NOTE: CBR TESTS TO BE TAKEN ON SITE. FORMATION TO BE INSPECTED BY HIGHWAY ENGINEER. ANY SOFT SPOTS TO BE EXCAVATED AND REPLACED WITH 6F2 CRUSHED CONCRETE CAPPING, AS PER TABLE BELOW.

SUB-BASE & CAPPING OPTION - EQUIVALENT TO NHBC STANDARDS		
CBR VALUE TO BE TESTED ON SITE AND CAPPING LAYER THICKNESS AGREED ON SITE WITH ENGINEER AND SHALL BE WITHIN THE FOLLOWING RANGES. ANY SOFT SPOTS OR FILL AREAS TO BE BUILT UP IN 6F2.		
CBR <2%	SUB-BASE	CAPPING
CBR 2% TO 3%	CONTACT ENGINEER FOR ADVICE	CONTACT ENGINEER FOR ADVICE
CBR 3% TO 5%	150mm	300mm
CBR >5%	150mm	225mm
		150mm

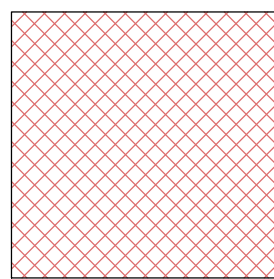
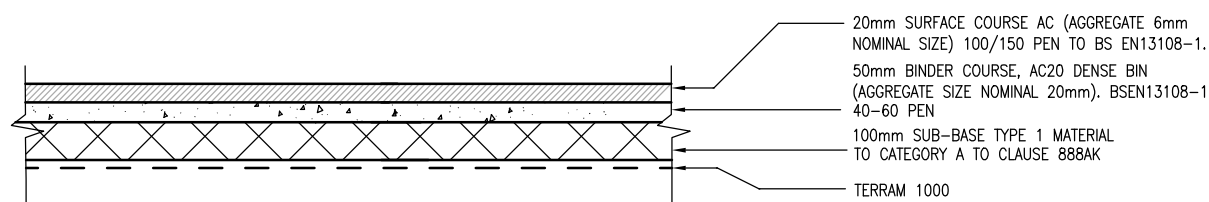

BITUMINOUS FOOTWAY CONSTRUCTION

IN AREAS OF FILL, LEVELS TO BE MADE UP IN CAPPING MATERIAL TO CLAUSE 6B8W, OR STABILISED FILL TO CLAUSE 613, 614, 615 OR 643 TO ACHIEVE A MIN 5% CBR.

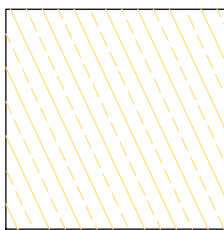
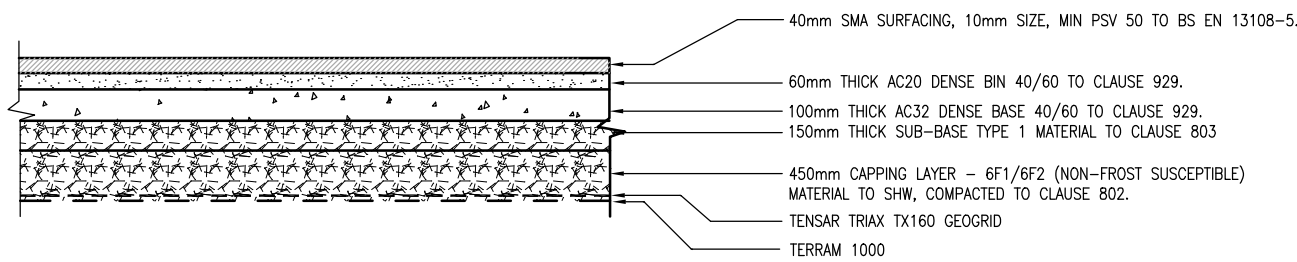

SMA CONSTRUCTION (HEAVY DUTY VEHICLES)

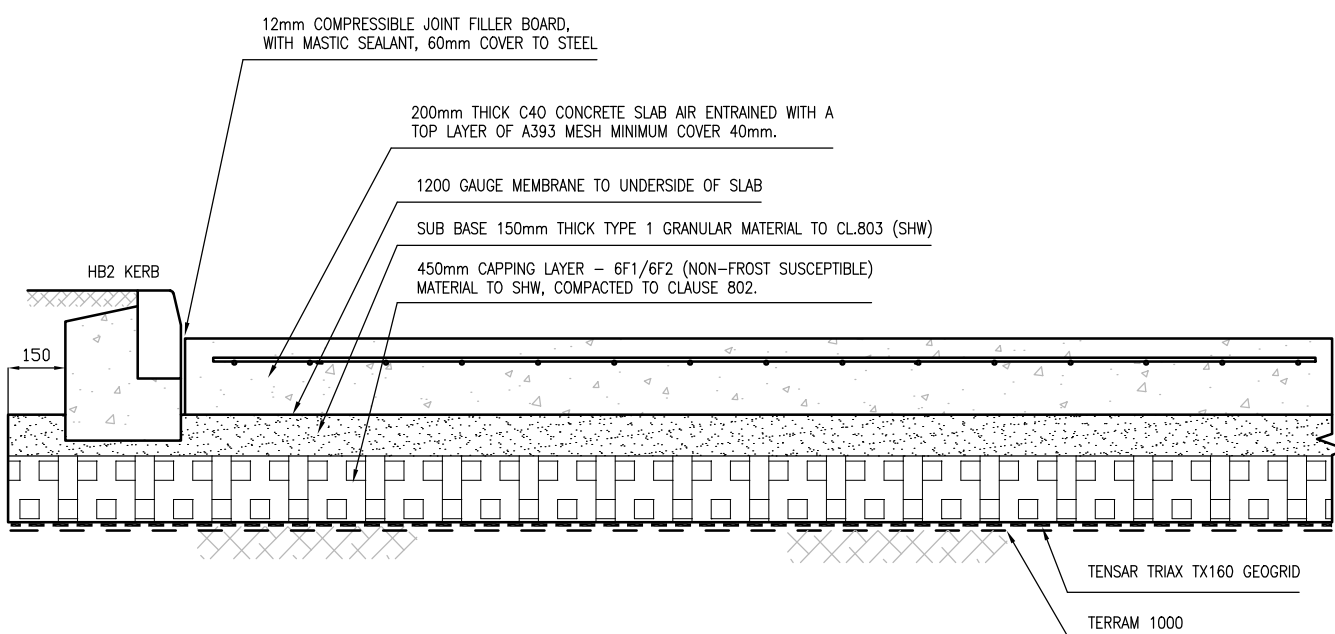

TRADITIONAL CONCRETE SLAB ISOLATION JOINT

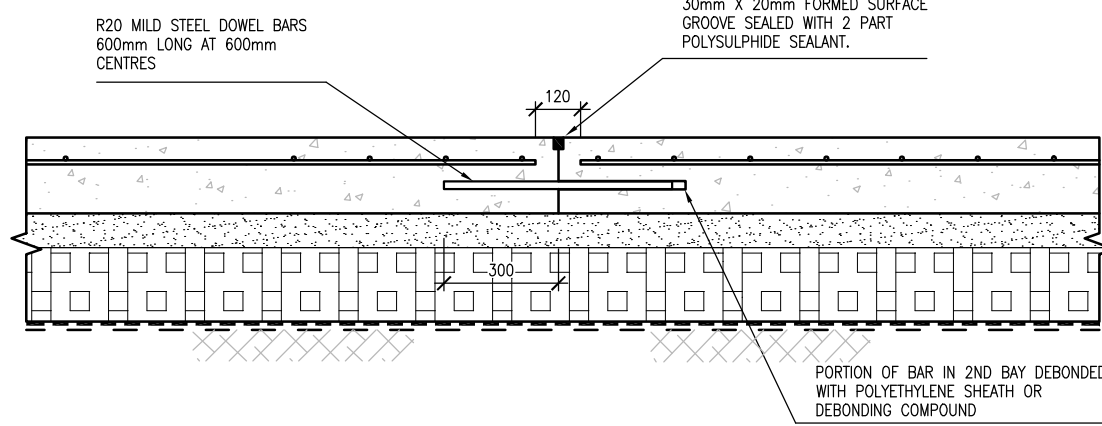

TRADITIONAL CONCRETE SLAB CONTRACTION JOINT

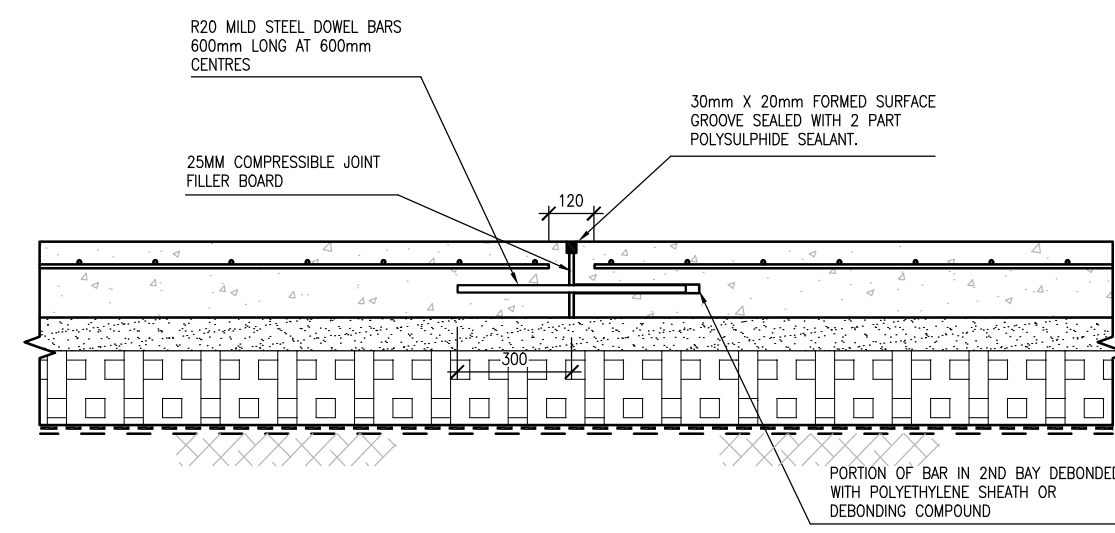

TRADITIONAL CONCRETE SLAB DEBONDED LONGITUDINAL JOINT

NOTES

GENERAL NOTES :

- 1..ALL COYLE KENNEDY DRAWINGS TO BE READ IN CONJUNCTION WITH ARCHITECTS DRAWINGS AND ALL OTHER RELEVANT DRAWINGS.
- 2..ALL SETTING OUT, INSULATION, DPC, SCREED AND RADON PROTECTION DETAILS BY ARCHITECT.
- 3..DETAILED SPECIFICATIONS (IF NOT ISSUED) ARE AVAILABLE AT ENGINEERS OFFICE FOR INSPECTION BY CONTRACTORS, BY APPOINTMENT.
- 4..DETAILS OF SUBSTRUCTURE GAS/WATER PROOFING MEMBRANES TO BE BY A REPUTABLE, COMPETENT SUPPLIER.
- 5..ALL SITE DEVELOPMENT WORKS SHOULD COMPLY WITH THE "RECOMMENDATIONS FOR SITE DEVELOPMENT WORKS FOR HOUSING AREAS" PUBLISHED BY THE DEPARTMENT OF THE ENVIRONMENT.
- 6..THE CONTRACTOR SHALL BE DEEMED TO HAVE ALLOWED FOR, WITHIN HIS TENDER, EMPLOYING A COMPETENT STRUCTURAL ENGINEER WITH ADEQUATE PROFESSIONAL INDEMNITY INSURANCE TO ASSESS, DESIGN AND DETAIL SUCH TEMPORARY WORKS AS ARE NECESSARY TO OFFER SUPPORT TO EXISTING AND/OR CONSTRUCTED ELEMENTS DURING THE CONSTRUCTION PERIOD. THIS APPLIES TO ELEMENTS WITHIN THE SITE AND NEIGHBOURING THE SITE.
- 7..THE CONTRACTOR IS DEEMED TO HAVE VISITED THE SITE AND CONSULTED WITH RELEVANT AUTHORITIES AND BE SATISFIED IN RELATION TO THE SITES SURROUNDINGS, EXISTING SERVICES, LEVELS, BOUNDARIES, GROUND CHARACTERISTICS AND ANY OTHER SITE CONSTRAINTS.
- 8..ALL WORK TO BE CARRIED OUT IN ACCORDANCE WITH THE CURRENT BUILDING REGULATIONS.
- 9..WHERE LEANMX IS SPECIFIED ALL LEANMX TO BE GRADE GEN 3. UNLESS NOTED OTHERWISE.
- 10..ALL LEVELS ARE STRUCTURAL LEVELS (U.L.O.).
- 11..ALL COLUMNS CENTERED ON GRIDS (U.L.O.).
- 12..DO NOT SCALE FROM DRAWINGS, USE FIGURED DIMENSIONS ONLY

F_o - 8/1

Rev.	Revision	Date
------	----------	------

DRAWING STATUS					
P	PRELIMINARY	A	APPROVAL	T	TENDER
C	CONSTRUCTION	R	RECORD	I	INFORMATION

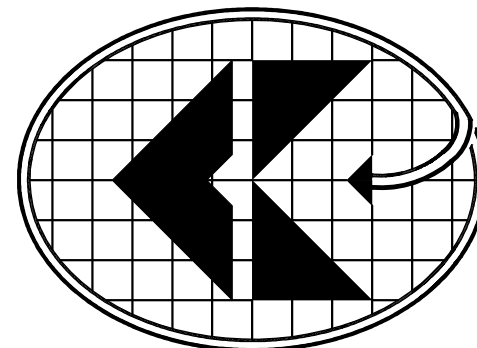

COYLE KENNEDY
Consulting Engineers

Third Floor,
GW Business Centre,
Great West House,
Great West Road,
Brentford TW8 9DF,
England

Tel: +44(0)203 393 1174 Website: www.coylekennedy.com
Fax: +44(0)203 004 1234 email: mail@coylekennedy.com

PROJECT
BREAKSPEAR ROAD SOUTH, ICKENHAM

CLIENT
FLANNERY'S

TITLE
EXTERNAL WORKS DETAILS

PROJECT No.	25-014	STATUS - DRAWING No.
-------------	--------	----------------------

DATE	MARCH 2025	C-314
------	------------	--------------

SCALE	1:20:1:50,1:100,1:500,1:1000,1:200,1:10000	BY	CHKD	SP	DRAWING REV.
					-

SCALE 1:20 0 0.2 0.4 0.6 0.8 1m SCALE 1:50 0 0.5 1 1.5 2 2.5 3 3.5 4m 4.5 5m SCALE 1:100 0 1 2 3 4 5 6 7 8 9 10m SCALE 1:200 0 1 2 4 6 8 10 12 14 16 18 20 SCALE 1:250 0 1 2 3 4 5 10 15 20m SCALE 1:500 0 5 10 20 30m

© COPYRIGHT COYLEKENNEDY