

Scale Bar in Metres at 1:100
All proposed materials to match existing.

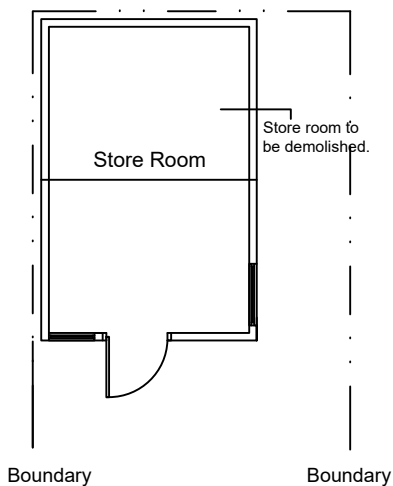

Existing Store Room
Floor Plan

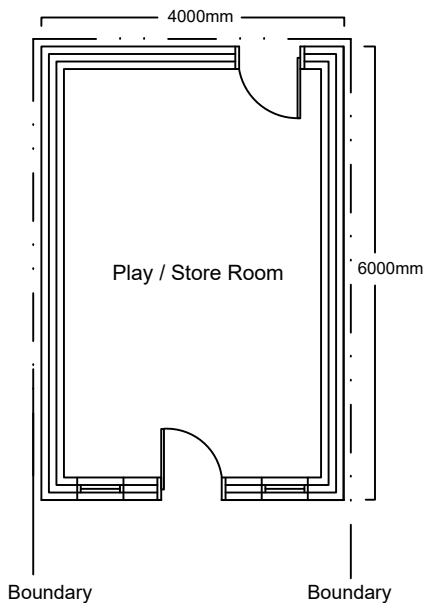

Proposed Play / Store
Floor Plan

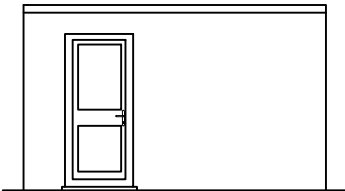

Proposed Rear Elevation

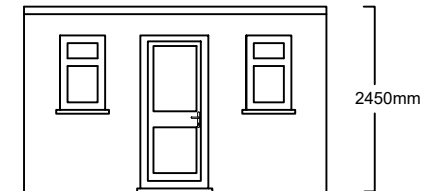

Proposed Front Elevation



Proposed Side Elevation
View From No.233



Proposed Side Elevation
View From No.237

- Notes:
1. All dimensions are approximate and in mm unless otherwise stated.
 2. This drawing is to be read in conjunction with any other relevant drawings.
 3. All drawings are copyright©
 4. Foundation depth of 1200mm relates only to subsoil conditions which are either gravel or sand

Revisions:

Site Address: 235 Lansbury Drive, Hayes UB4 8RT		
Drawing Title: Existing Floor Plan and Proposed Floor Plans and Elevations		
Scale: 1:100	Date: 8th May 2024	Ref: 235LANSBURYDRIVE 001