

1 Existing Front Elevation
Sign A 1:20

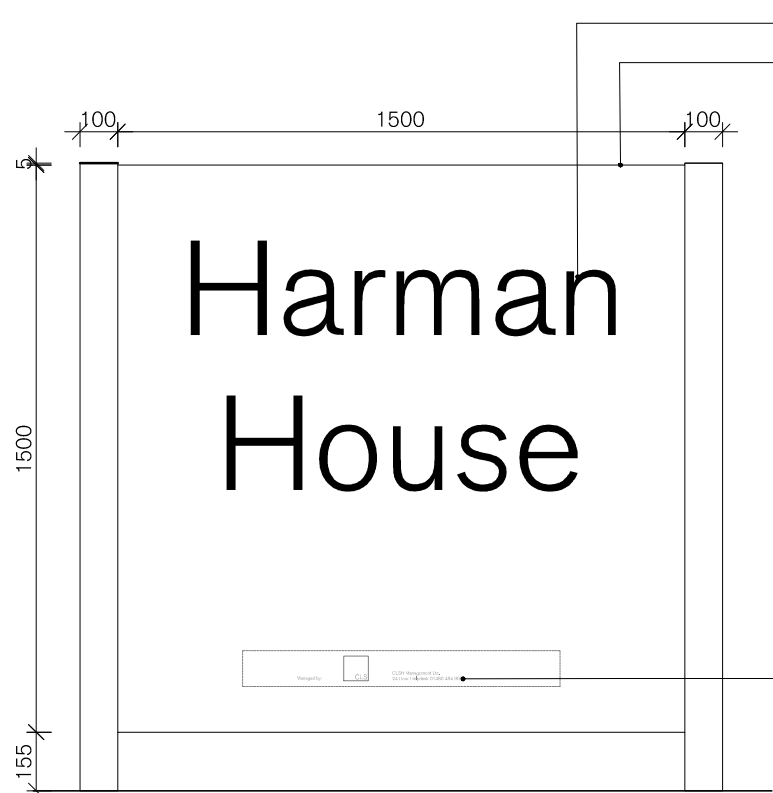

2 Existing Rear Elevation
Sign A 1:20

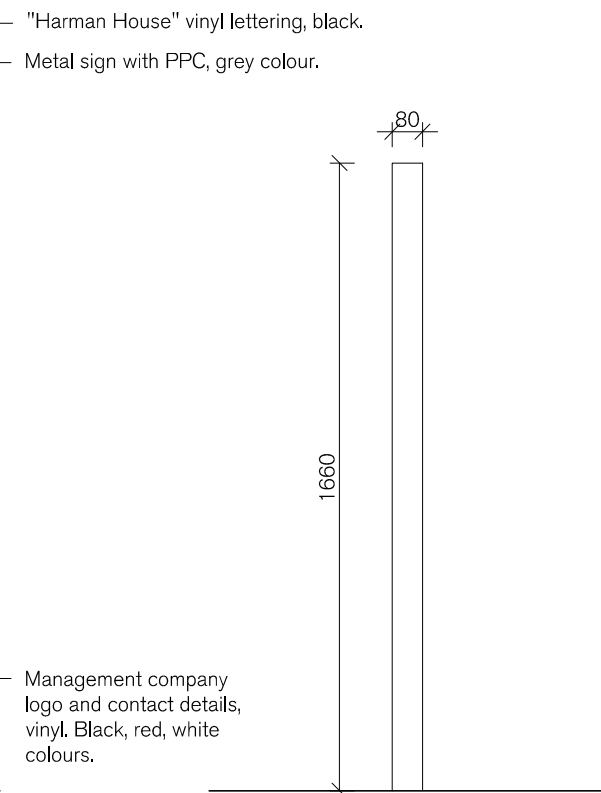

3 Existing Side Elevation
Sign A 1:20

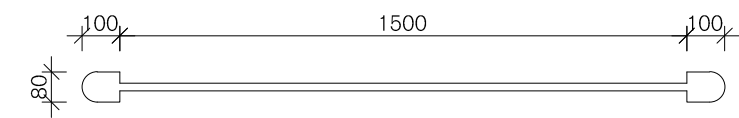

4 Existing Sign Plan
Sign A 1:20

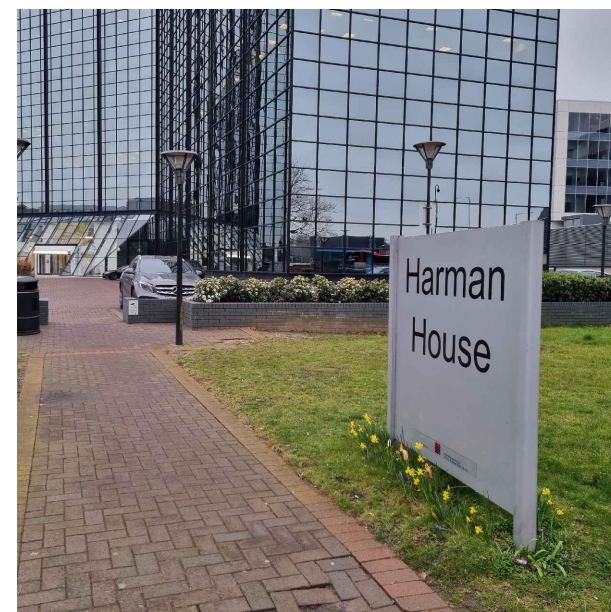

- Photo
NTS

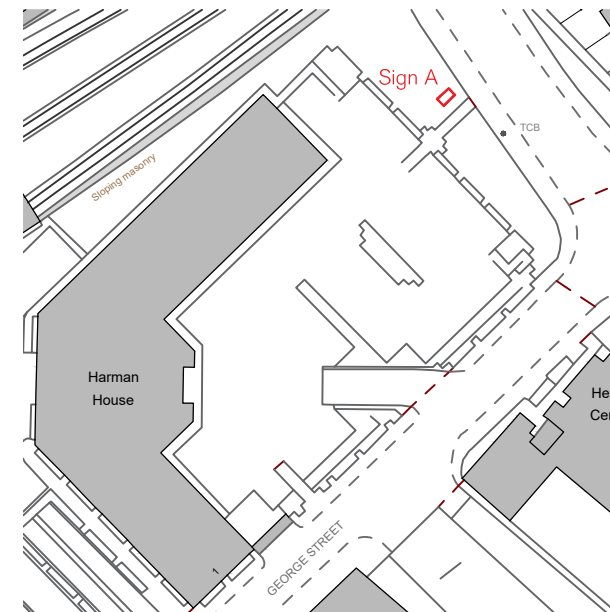

- Key Plan
1:1250

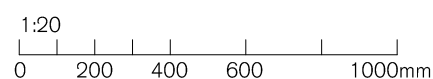

SPRATLEY & PARTNERS, 7 CENTENARY BUSINESS PARK, STATION ROAD,
HENLEY-ON-THAMES, OXFORDSHIRE RG9 1DS. 01491 411277

ISSUED ONLY FOR THE PURPOSE INDICATED. THIS DRAWING TO BE READ IN
CONJUNCTION WITH ALL CONSULTANTS INFORMATION. ALL DIMENSIONS
TO BE CHECKED ON SITE. DO NOT SCALE. THIS DRAWING IS COPYRIGHT.

REV.	ISSUED	DESCRIPTION	DRAWN	CHECKED
-	-	-	-	-
-	-	-	-	-
-	-	-	-	-

PROJECT /DESCRIPTION	DATE	SCALE AT A3	JOB NO
Harman House 1 George St Uxbridge UB8 1QQ	JULY 2022	1:20	22.962
Existing Sign A, York Rd Elevations and Plan	STATUS	PLANNING	DRAWING NO PL.101
CLIENT	DRAWN	CHECKED	REV
Harman House Ltd.	TR	RK	-

S
&
P