

ACCORDANCE WITH BS5262
FINISH ON INSIDE WITH 50mm GYPROC THERMAL INSULATION
WALLS TO INCORPORATE MOVEMENT JOINTS AS RECOMMENDED BY BLOCK
MANUFACTURER

THESE DRAWINGS ARE NOT TO BE USED AND NO WORK TO COMMENCE UNTIL
FULLY CHECKED TOGETHER WITH CALCULATIONS AND GIVEN L.A. APPROVAL
UNDER BUILDING REGS. CONTRACTOR TO CHECK ALL MEASUREMENTS ON SITE
AND NOT TO SCALE DRAWING. MATERIALS AND WORKMANSHIP TO BE TO
STANDARDS OF BUILDING REGULATIONS AND RELEVANT CODES OF PRACTICE
AND BRITISH STANDARDS

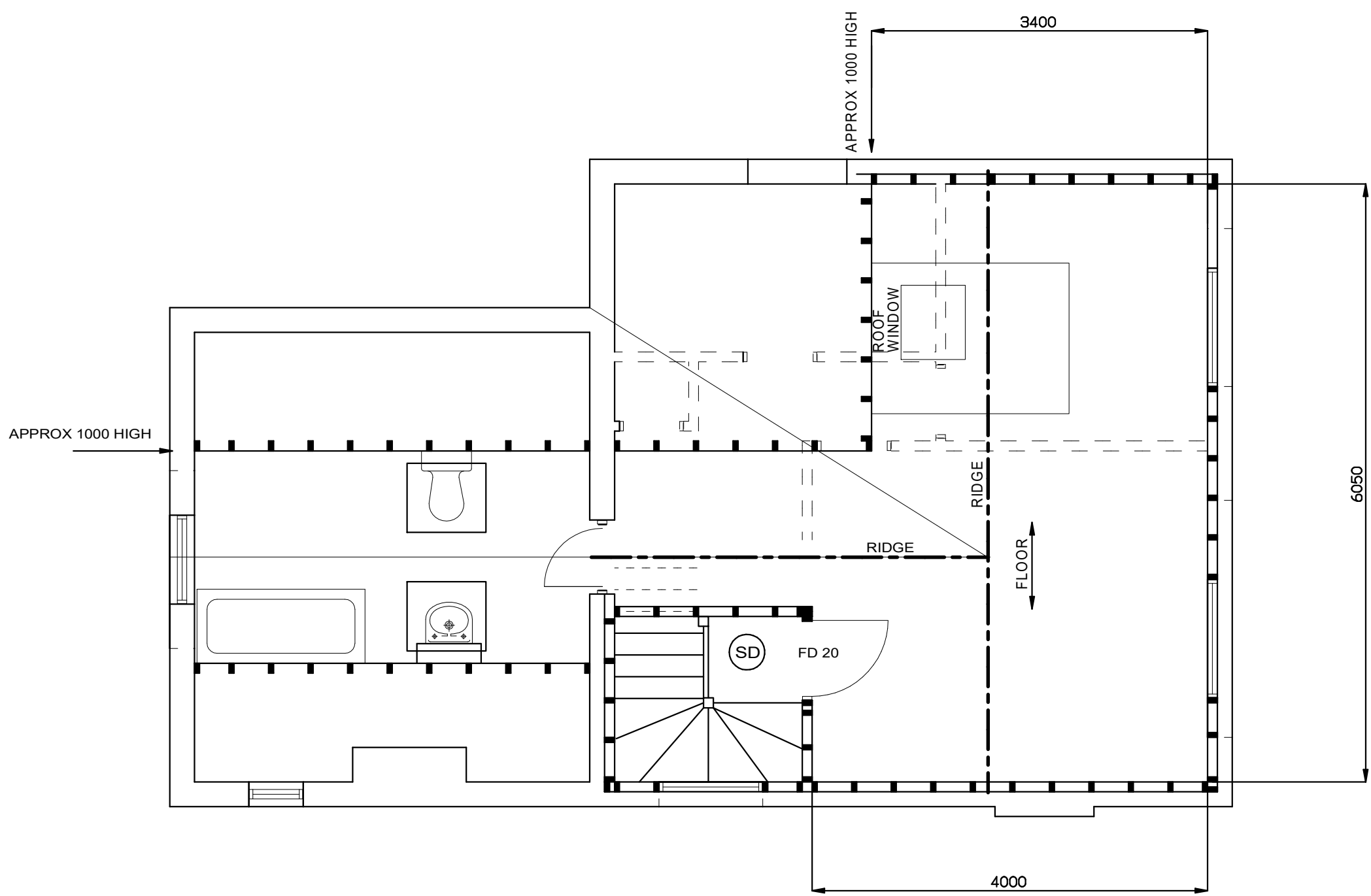

PROPOSED LOFT PLAN

A3

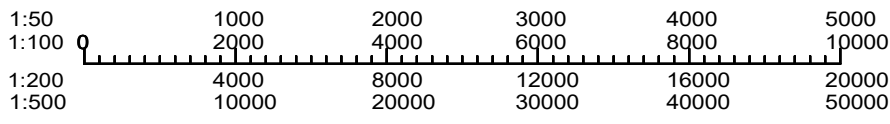

DRG NO. HP 5625 ISSUE A1
6/5/2022 SH 5

SCALE 1:50

P.S.DESIGNS
TEL 01784 450219
peterslator@gmail.com

PROPOSED EXTENSION AT
41 BROADWOOD AVENUE
RUISLIP
HA4 7XS