

Level access Ramp
Scale 1:20

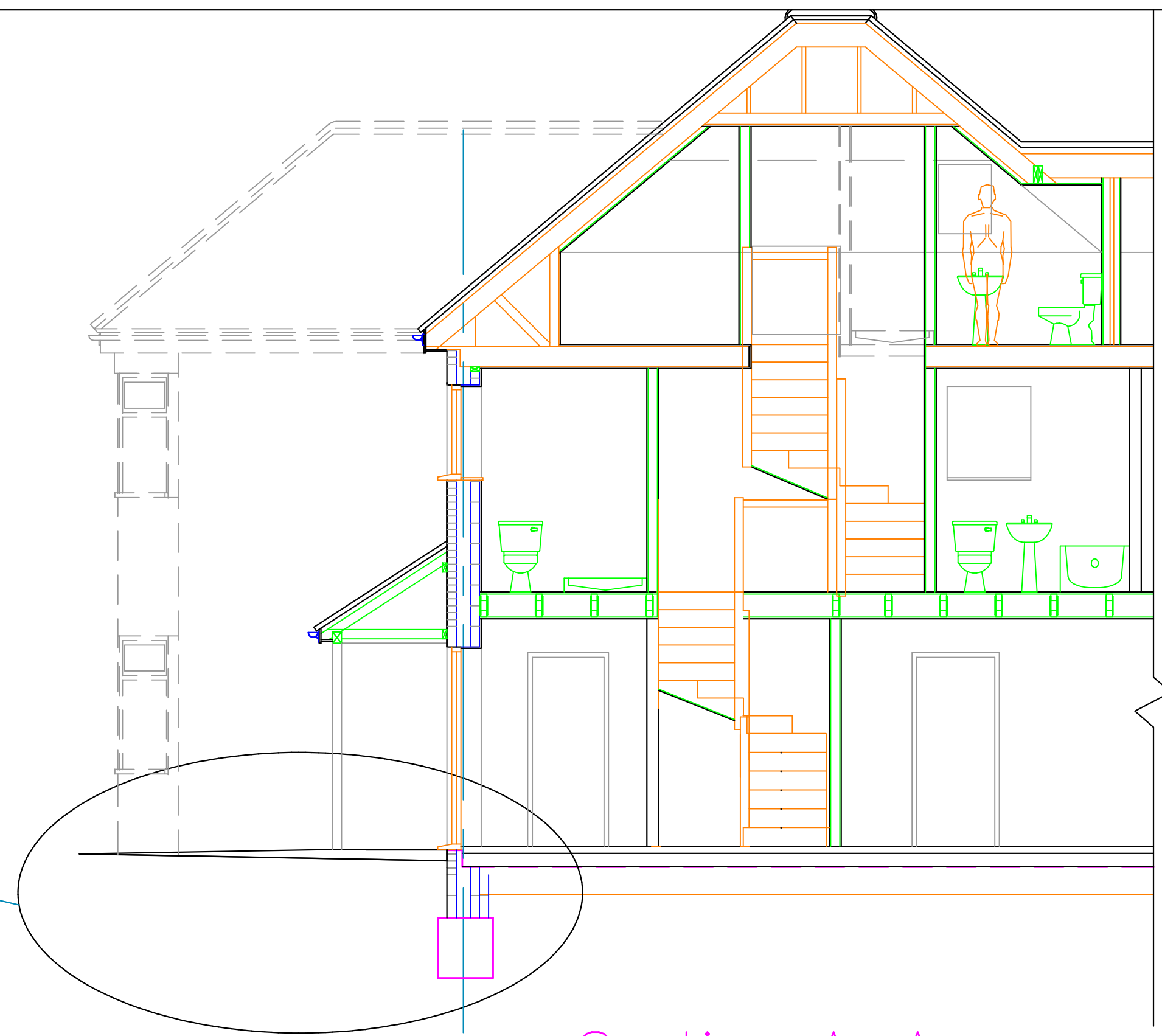

Section A-A

1. Do not scale from this drawing.
2. All dimensions to be checked on site before ordering materials or commencing work.
3. In case of discrepancies in drawings, calculations or details refer to TOWERS ASSOCIATES. for clarification: Unilateral decisions by contractors will not be accepted.
4. For any information not covered by these drawings refer to TOWERS ASSOCIATES. for clarification: Unilateral decisions by contractors will not be accepted.
5. The contractor must ensure that work is being carried out to the latest revisions of all the working drawings.
6. It is the contractors responsibility to inform the local authority before work commences on site, and at all prescribed stages of work. All to the District Surveyors satisfaction.
7. If work commences on site before full plans approval has been given, TOWERS ASSOCIATES accept no responsibility for any additional work or materials that the District Surveyor may require.
8. This drawing and all copies produced there from remain the copyright and property of TOWERS ASSOCIATES it may only be reproduced by TOWERS ASSOCIATES and all copies must be returned to TOWERS ASSOCIATES if demanded.

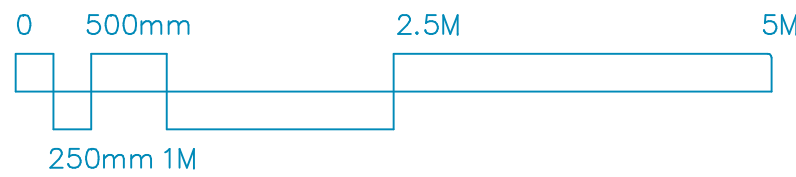

Belmont Close

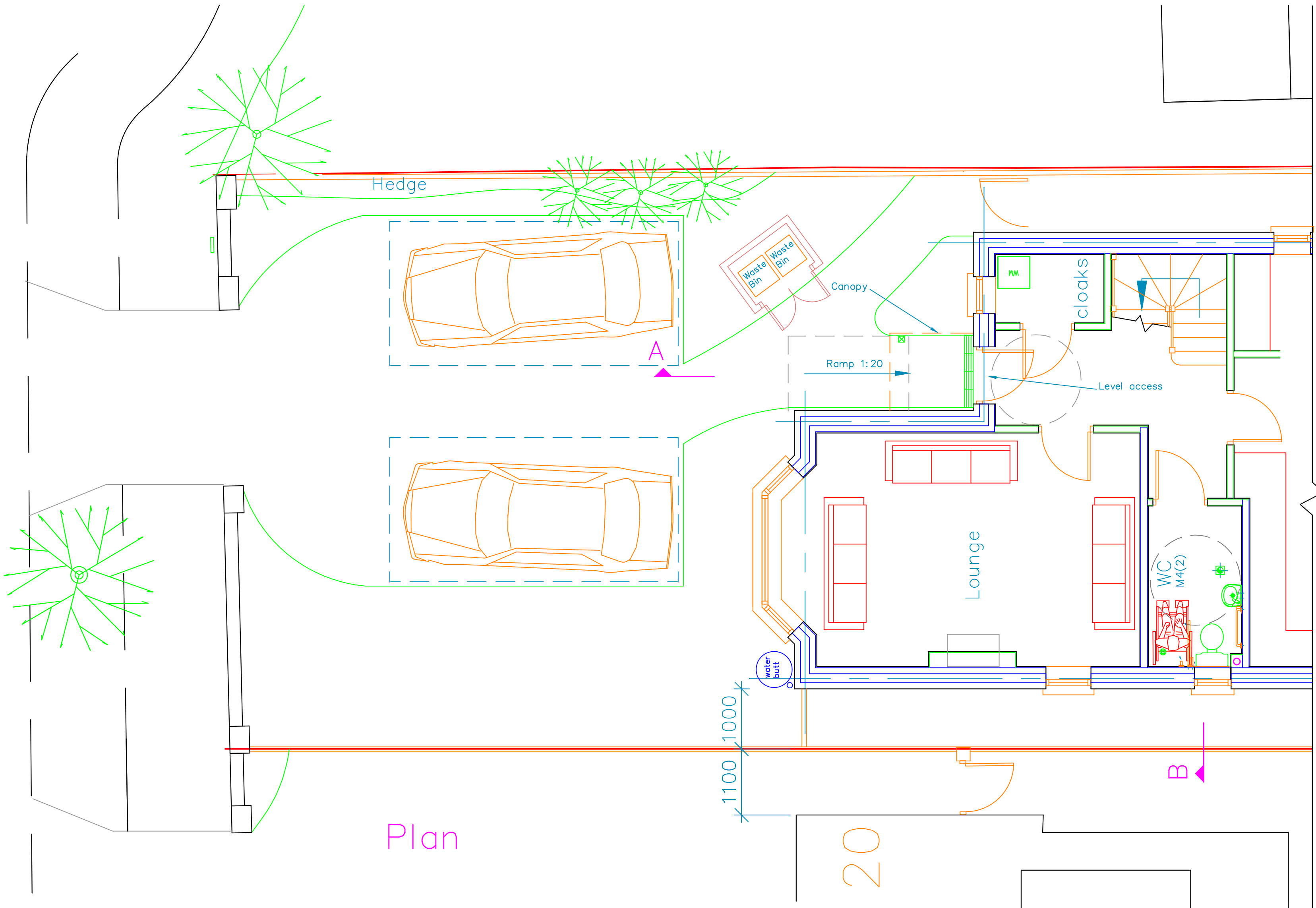

Plan

REV.	DATE	DESCRIPTION
JOB		20 Belmont Close, Uxbridge. UB8 1RF.
TITLE		Level access to Entrance
DRG. No.	3309-07	REV.
SCALE: 1:50	© Copyright 2023	DRN BY JDS
		DATE Jul 23
		CHECKED PDN
		DATE Jul 23
TOWERS ASSOCIATES		
Harefield Oil Terminal, Harvil Rd, Harefield, MIDD. UB9 6JL.		
FAX. 01895 814664		
TEL. 01895 812822		