

NOTE:  
1.Do not scale from these drawings, use dimensions only.  
2.Contractors are to check all dimensions prior to commencement on site and notify the architect of any errors, omissions, or discrepancies.  
3. Unless otherwise agreed in writing, all rights to use this document are subject to payment in full of all charges. This document may only be used for the express purpose, project and client for which it has been granted and delivered, as notified in writing by Hut and Castle Architects Ltd. This document may not be otherwise used or copied.

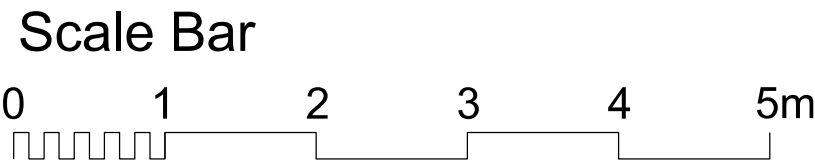

DRAWING KEY:

- EXISTING WALLS
- NEW WALLS
- EXISTING WALL TO BE REMOVED (SUBJECT TO S.E.)

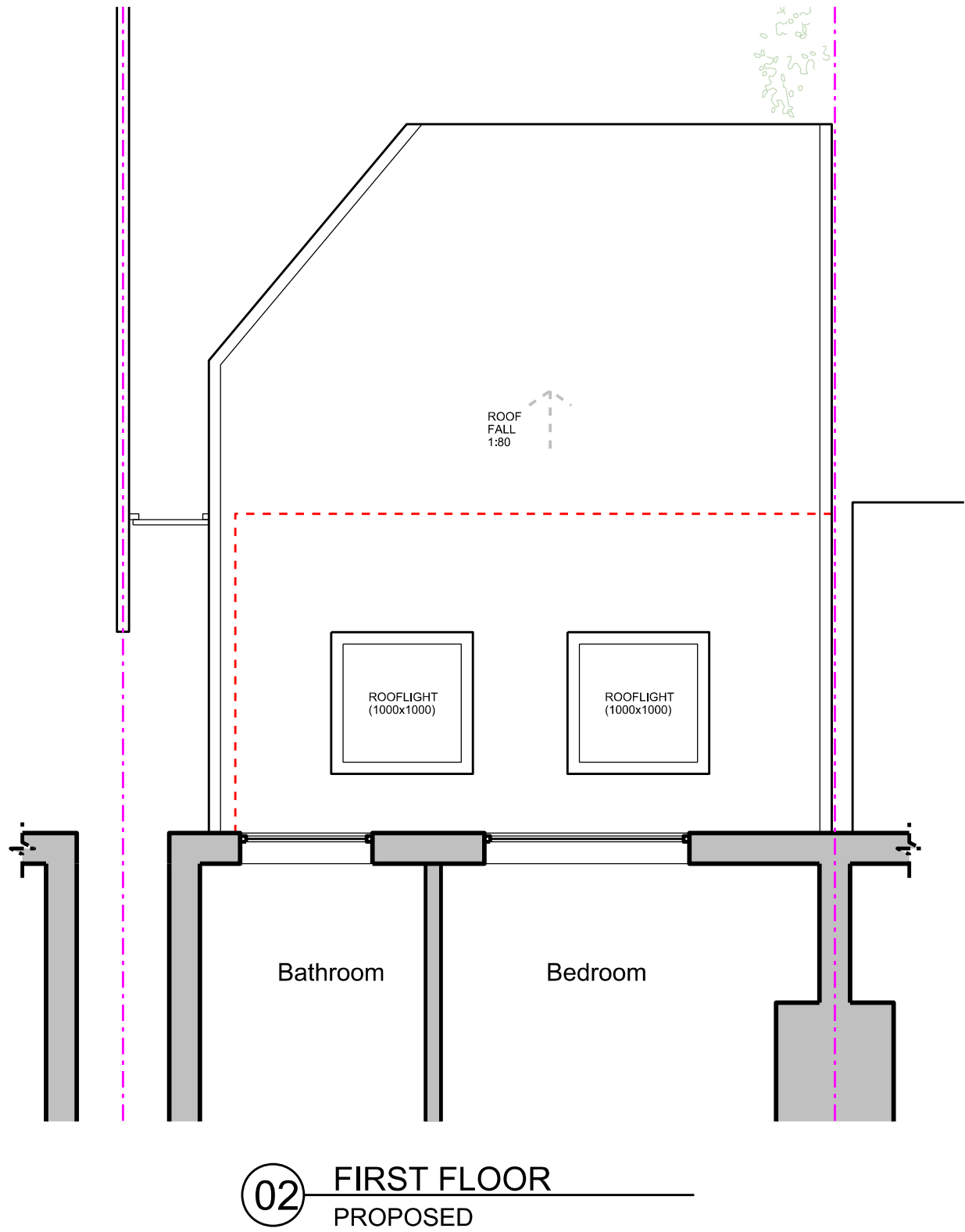
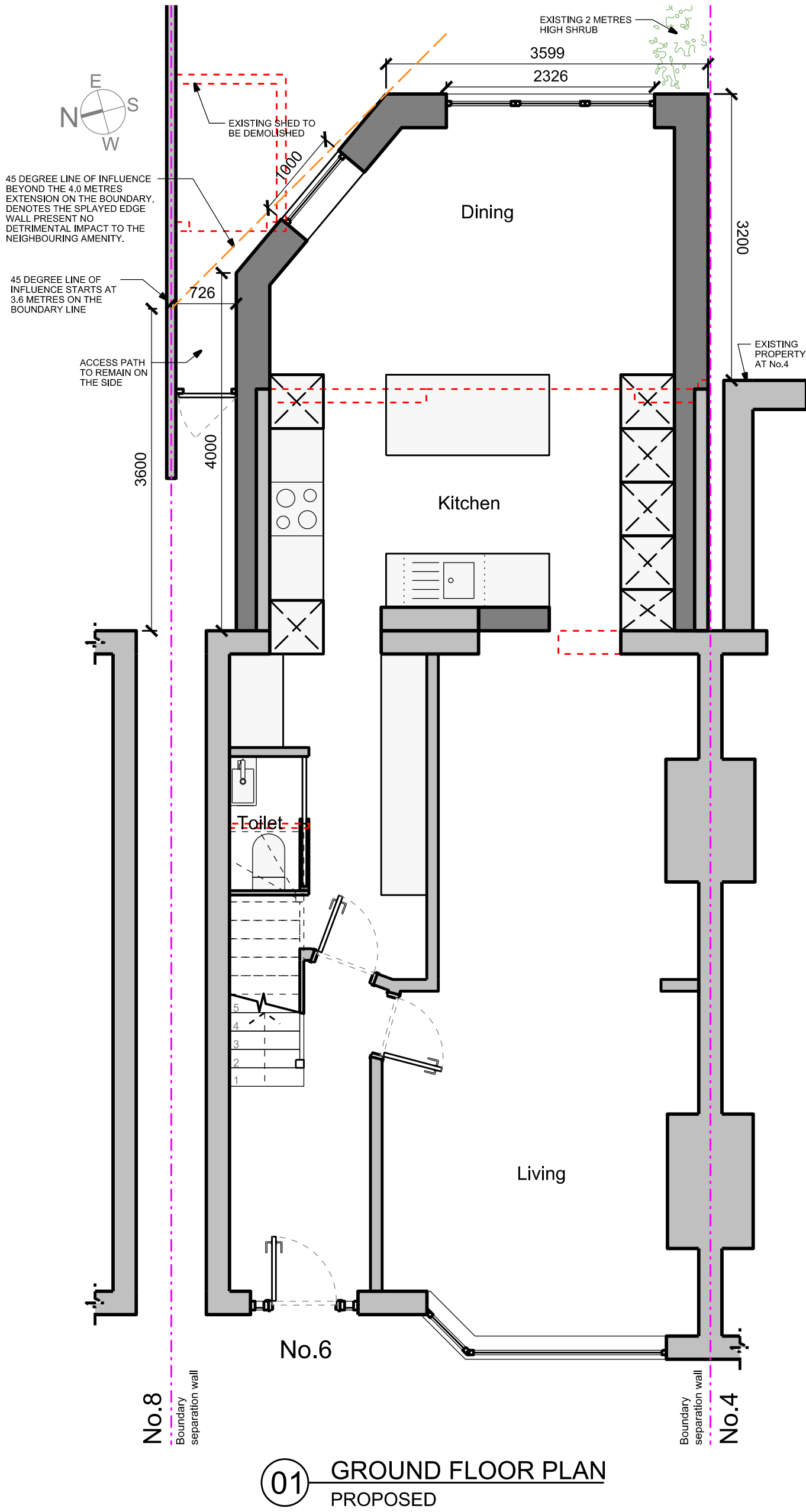

01 Extension length reduced on the 05/09/2024 DC side to 4.0 metres with played edge at the corner.

Rev	Description	Date	Checked
-----	-------------	------	---------

Status

FOR PLANNING

Client  
Eamonn Colleran

Address  
6 CHURCHILL AVENUE  
UB10 0EB UXBRIDGE

Project  
Ground Floor Rear Single Storey Extension

Drawing

PROPOSED PLANS

Scale	Drawn	Date	Checked
1:50 @ A1	DC	24.06.2024	DC
1:100 @ A3			

Project no.	Drg	Revision
2402	A-20	01

Architect  
Hut and Castle Architects Ltd  
T 07891574543  
hutandcastle@gmail.com



WWW.HUTANDCASTLE.COM