

4 March 2016

65 Gresham Street  
London EC2V 7NQ

T: +44 (0)844 902 0304  
F: +44 (0)20 7911 2560

[gva.co.uk](http://gva.co.uk)

Mandip Malhotra  
Planning Department  
London Borough of Hillingdon  
Civic Centre  
High Street  
Uxbridge  
Middlesex  
UB8 1UW

Tim.sturgess@gva.co.uk  
0207 911 2236

Dear Mandip

**TfL Landholdings, Green Lane, Northwood  
Illustrative Landscape Strategy**

In response to comments received by LBH Officers regarding the Landscape Strategy proposed within the outline element of the proposed development, please find enclosed an Illustrative Landscape Strategy prepared by Outerspace.

The purpose of this Illustrative Landscape Strategy is to provide an illustration of the type of landscaping elements that could be accommodated within the outline element of proposed development. The proposed development will involve the removal of the current tree buffer on the eastern perimeter of the site. The outline application submitted for approval alongside the full application indicates that a landscape buffer of 2m wide as set out on the parameter plans which seek approval.

The attached Illustrative Landscape Strategy states outlines the species of trees, plants and shrubs that could be provided as part of a future Reserved Matters application. A full Landscape Strategy will be required in order to discharge any future condition likely to come forward in relation to any planning approval.

If you have any issues accessing the documents or have any queries, please do not hesitate to contact me.

Yours sincerely,



**Tim Sturgess**  
**Principal Planner**  
For and on behalf of GVA Ltd

Enc: Illustrative Landscape Strategy, prepared by Outerspace

Project: **Northwood**

**Illustrative Landscape Strategy**  
Outline Landscape Zone

From: **Outerspace**  
Date: **March 2016**

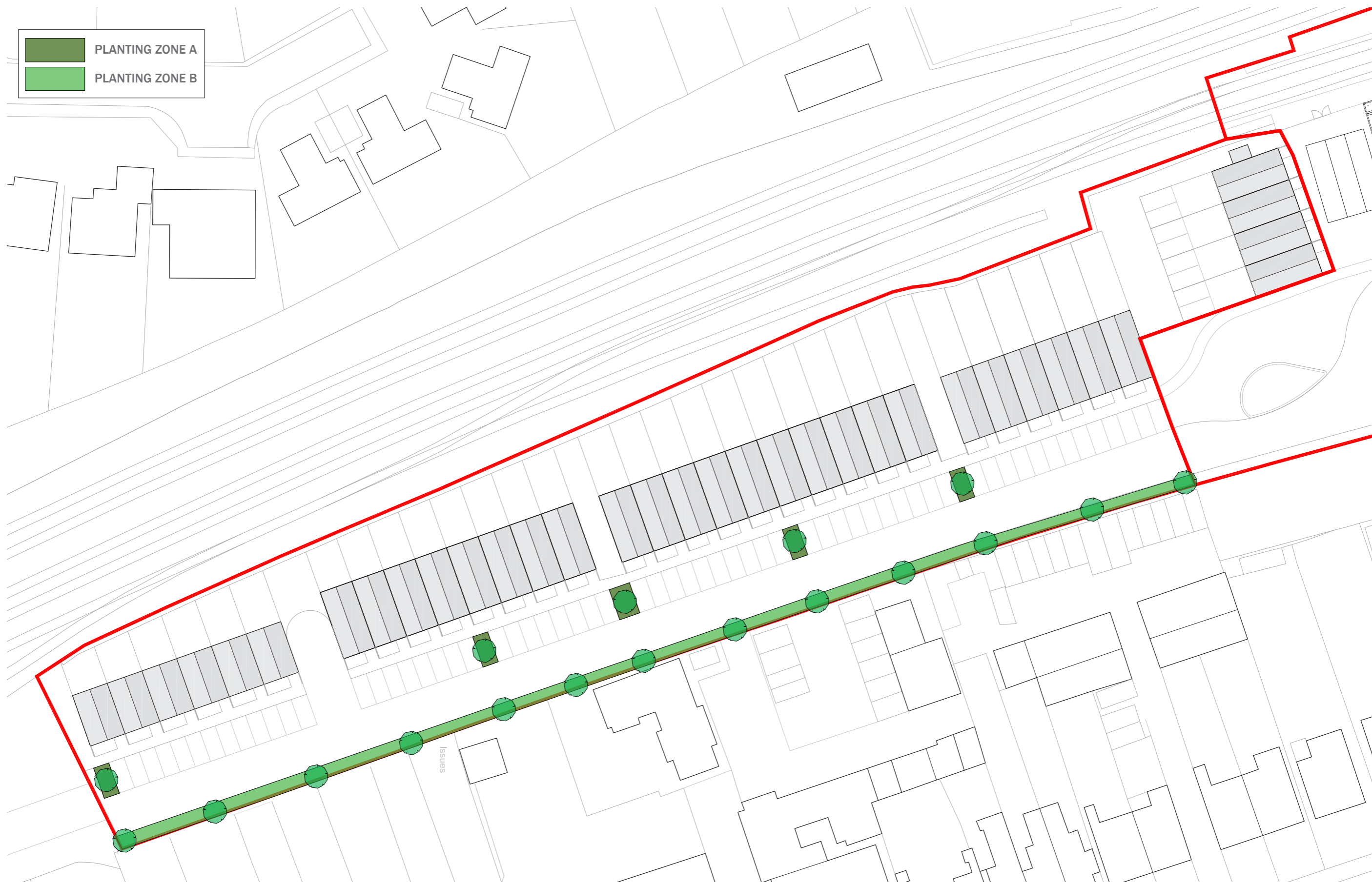



Street Tree Planting

- 1. *Tilia cordata*



Planting Strategy

Zone A

Street trees to be provided to mitigate the loss of existing planting, screen the development and break up the extent of parking. Trees to be selected for minimal maintenance and an upright columnar form to minimise overhanging into carriageway.

Trees will be under planted with a variety of robust evergreen shrub & ground-cover planting, interspersed with seasonal bulb planting.

Zone B

Tree Planting provided to mitigate the loss of existing planting and screen views of the development from the east. Planting to reflect the rhythm of the trees between the parking bays on the opposite side of the road, but at a greater density with ground cover planting to the base of each. Larger shrubs to be planted in-between trees, with climbing plants to fence-line to provide a green screen. Tree species should be agreed with local authority at detailed design stage, but the species suggested here grow to approximately 10m tall in 25 years (from saplings) - mature specimens could be purchased to enhance mitigation and increase screening.

All planting will be selected with ecological enhancement in mind and will aim to provide both foraging and nesting opportunities for both birds and invertebrates/bees alike.

Shrub Planting

- 1. *Cornus alba*
- 2. *Potentilla fruticosa*
- 3. *Elaeagnus umbellata*



Herbaceous and Ground Cover Planting

- 1. *Geranium ssp*
- 2. *Heuchera sp*
- 3. *Alchemilla mollis*
- 4. *Sarcococca ruscifolia*
- 5. *Cotoneaster dammeri*

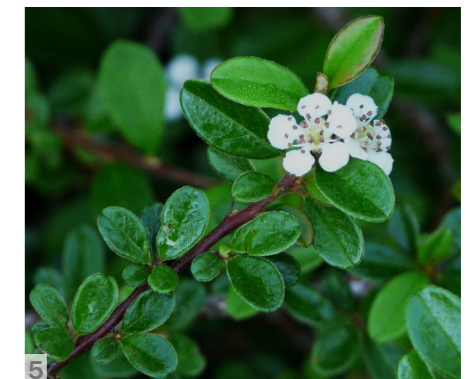

Climbing Plants

- 1. *Parthenocissus*
- 2. *Hedera helix*

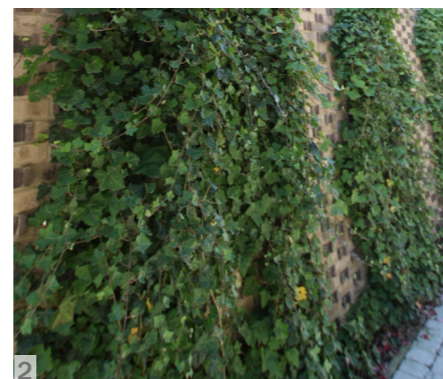
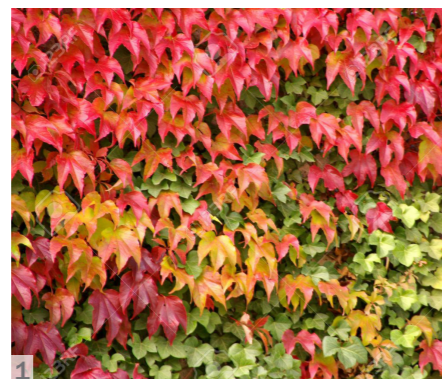

Bulb Planting

- 1. *Narcissus sp*
- 2. *Crocus sp*

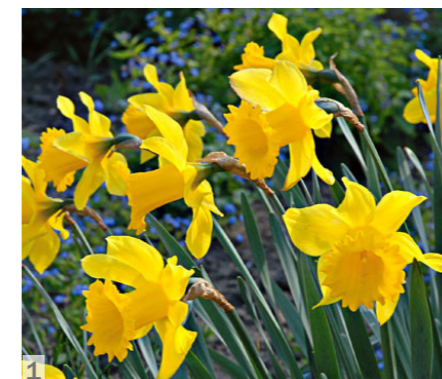



outer space