

PROPOSED GROUND FLOOR PLAN (REAR GARDEN)

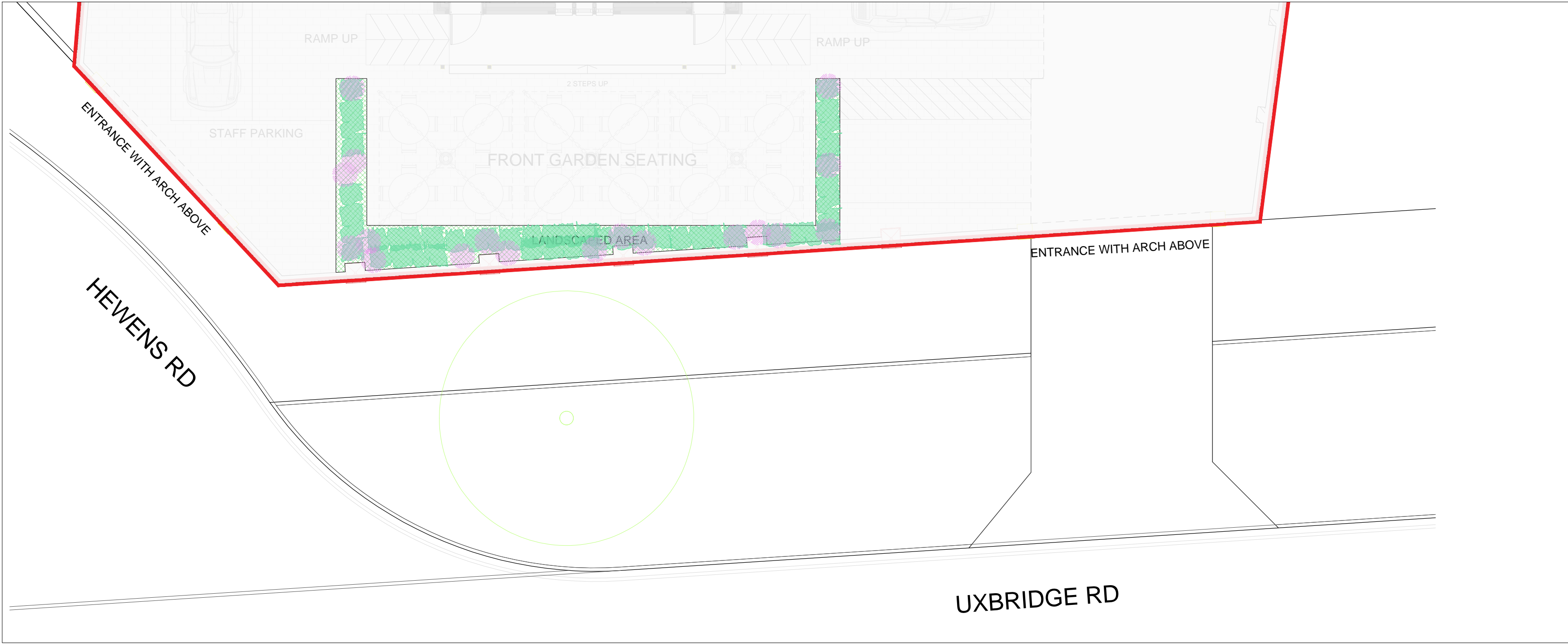

PROPOSED GROUND FLOOR PLAN (FRONT GARDEN)

PLANTING SCHEME

1.CULTIVATION OF PLANTING AREAS

Topsoil to have a minimum depth of 450mm. Top soil must be compliant with BS 3882-2007

Topsoil should be free draining and any compaction relived by digging over.

Prior to planting the beds will de single dug and enriched with well rotted manure.

Planting will be carried out using a mixture of multipurpose compost and soil in equal proportions with added bone meal to encourage rooting.

Once planted, the soil surrounding the plants will be covered with and weed control membrane and then dressed with bark chip to a depth of 5 cm to help retain moisture.

2. CULTIVATION OF LAWNS AREAS





Top soil to have a minimum depth of 250mm and must be compliant with BS 3882-2007

Prior to turf being laid, compaction should be relieved by a mechanical rotovator.

3.IMPLEMENTATION

Planting should commence once construction has been completed, preferably in spring or autumn.

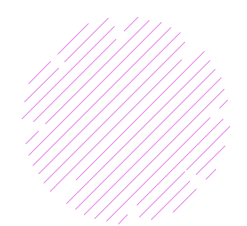
SOFT LANDSCAPING

	<b>YEW HEDGE</b> 'Taxus Baccata' PLANTING DENSITY: 0.5 per square metre SIZE: 300mm tall - 5l pot	
	<b>ENGLISH LAVENDER</b> <i>Lavandula angustifolia</i> PLANTING DENSITY: 3 per square metre SIZE: 300mm tall - 5l pot	

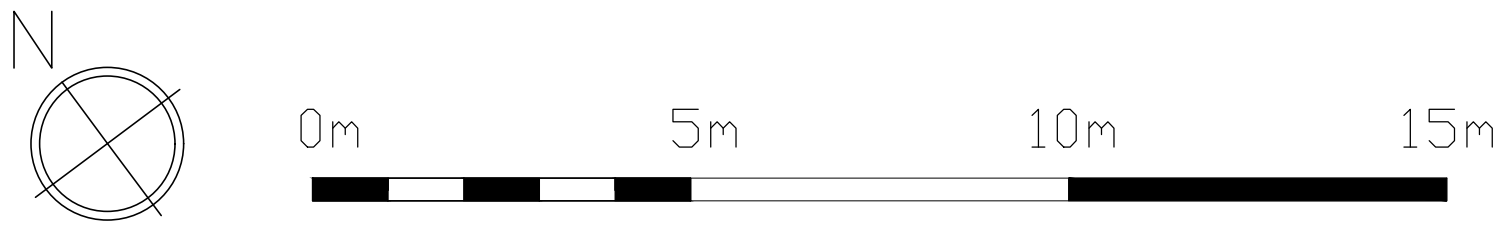

PROJECT	DWG NO.	SCALE	DETAIL	13.01.2023						PROJECT NO.	<div>PR Architecture Ltd.</div> <div>Chartered Architect</div> <div>120, Pinner Road, Harrow, HA1 4JD. Tel: 0208 357 2304</div>
CARPENTER'S ARMS, 1370 UXBRIDGE RD, HAYES UB4 8JJ	300	1:100 @ A1	CONDITION 6 - SOFT LANDSCAPING	SENT TO PLANNING						19.35	
BUILDING REGULATIONS											