

PROPOSED GROUND FLOOR PLAN

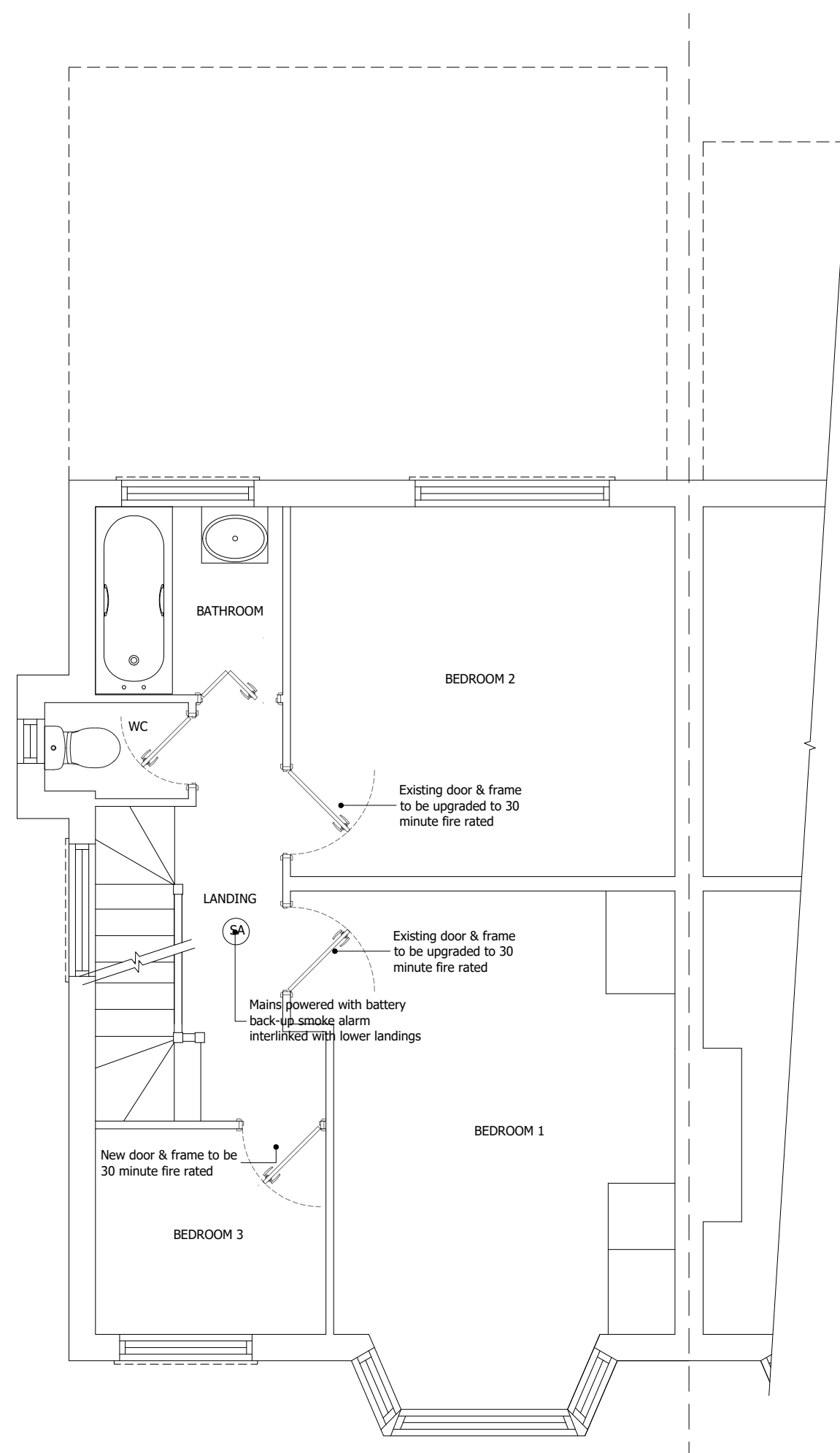

PROPOSED FIRST FLOOR PLAN

Property Address:  
232 WEST END ROAD  
RUISLIP, HA4 6DX

Project:  
CONVERSION OF EXISTING LOFT SPACE IN  
TO HABITABLE ROOM

Dwg REF: 002  
REV: 1  
CLIENT: LONDON BOROUGH OF HILLINGDON

Dwg TITLE: PROPOSED GROUND &  
FIRST FLOOR  
DATE: 20-07-2021

N P WALFORD (Architectural Drawing Services)  
T: 01865 423721 M: 07860700318  
E: nwalford@npwplanning.com  
44 Ash Grove, Headington, Oxford, OX3 9JL

