

EXISTING SITE PLAN
Scale 1:200

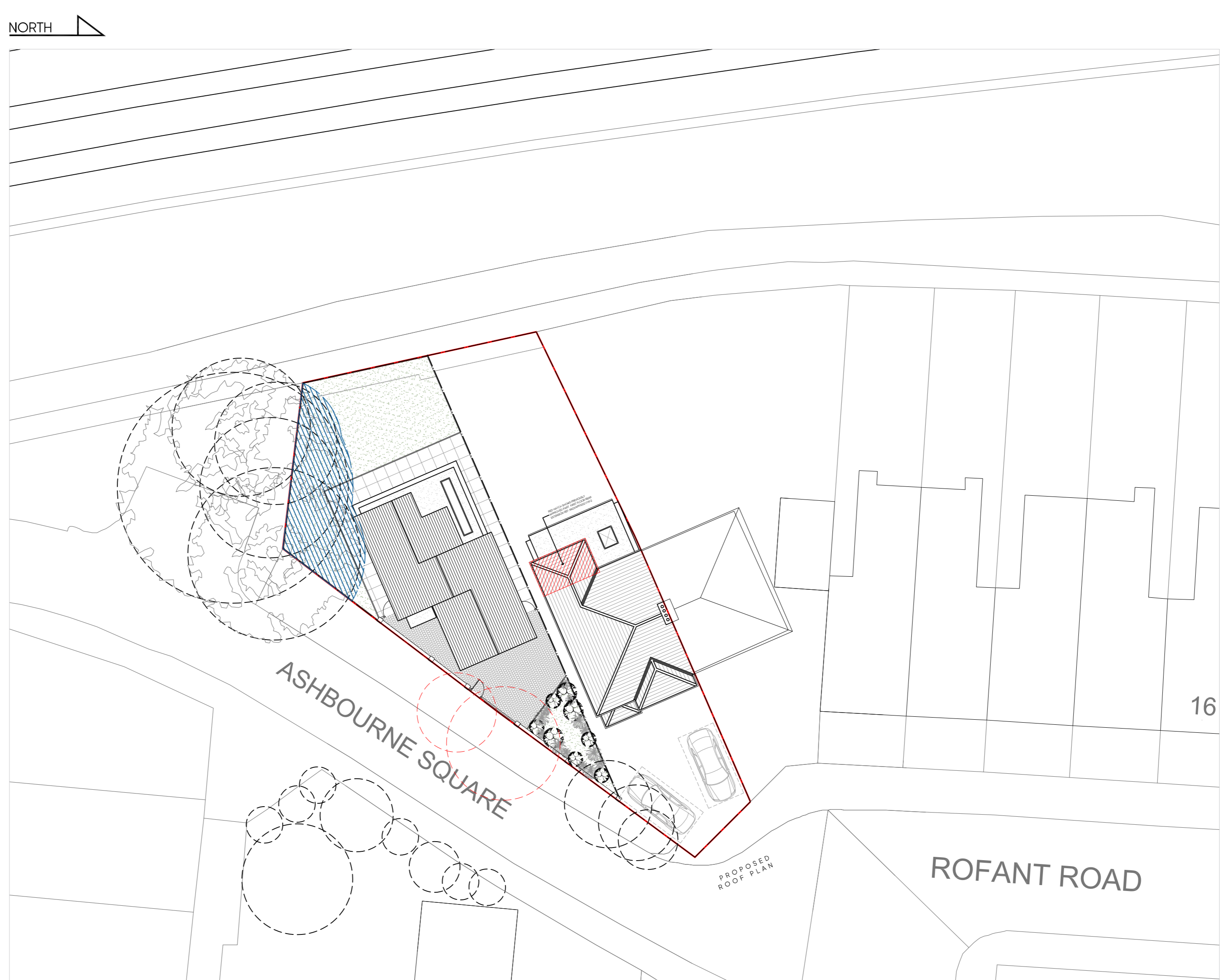

PROPOSED SITE PLAN
Scale 1:200



LOCATION PLAN
SCALE 1:1250

Rev	Date	Description	By	Int.
C	28/04/22	AMENDED TO SIFT COMMENTS	EP	
B	07/12/21	AMENDED TO SIFT COMMENTS	EP	
A	12/01/21	AMENDED TO SIFT COMMENTS	EP	

Client
MR VHORRA

Project Title
PROPOSED TWO HOUSE SCHEME
4 ROFANT ROAD, NORTHWOOD, HA6 3BE

Drawing Title
EXISTING & PROPOSED SITE PLAN

Code	File	Sheet Size	Scale
S001	AI1	A1	1:200

Drawn by	Drawing Date	Approved by
AG	NOV 2021	NJ

Project No.	Drawing No.	Revision
1840	S201	C



2-4 High Street, Ruislip,
Middlesex, HA4 7AR
01923 840077 | 01923 840078
info@juttia-architects.com
juttia-architects.com

This drawing is property of Juttia Architects Ltd © and must not be copied or otherwise reproduced. All dimensions must be checked on site before commencing work. No dimensions to be scaled from this drawing. This drawing and process being issued AS IS.

SKETCH ISSUE