

Notes:

1. Do not scale this drawing

2. All dimensions to be verified on site and any discrepancy reported to the client

3. This drawing to be read in conjunction with all relevant drawings

Prior To Commencement Of Any Works, Agree With Adjoining Neighbours

Client/Builder To Obtain All Planning Permission Approvals From The Relevant Authority. Commencement Of Building Works Prior To The Planning & Building Control Approvals Is To Client/Builders Own Risk

Client/Builder To Liaise With Local Water Board For Any New Works On Or Within The Public Sewer Or Drain Runs And Obtain Approval From The Local Authority Prior To Commencement Of Any Works

New timber stairs to proposed loft to stairs specialist requirements (final setting out and head room to be determined on site by stairs specialists requirements and to B.C.O.s approval)

New loft floor steel beams to be set out by main builder in conjunction with loft stair specialist. The CAD technician has no responsibility on the setting out of new stairs/steels

Loft Space Head Room To Be Confirmed By Principal Contractor Before Commencement Of Any Works

Bedroom 3 Entrance Wall May Have To Be Moved Back To Accommodate The Proposed Loft Stairs

form 2 no access hatch to retaining loft storage (all to clients requirements)

Loft Space Has Not Been Surveyed

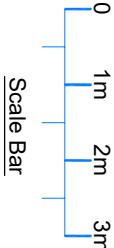
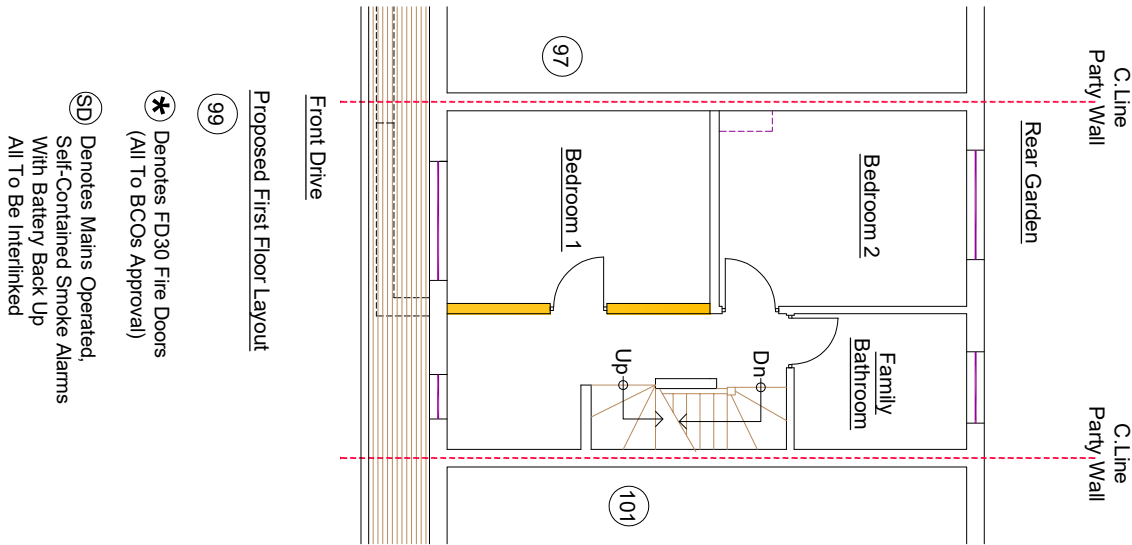
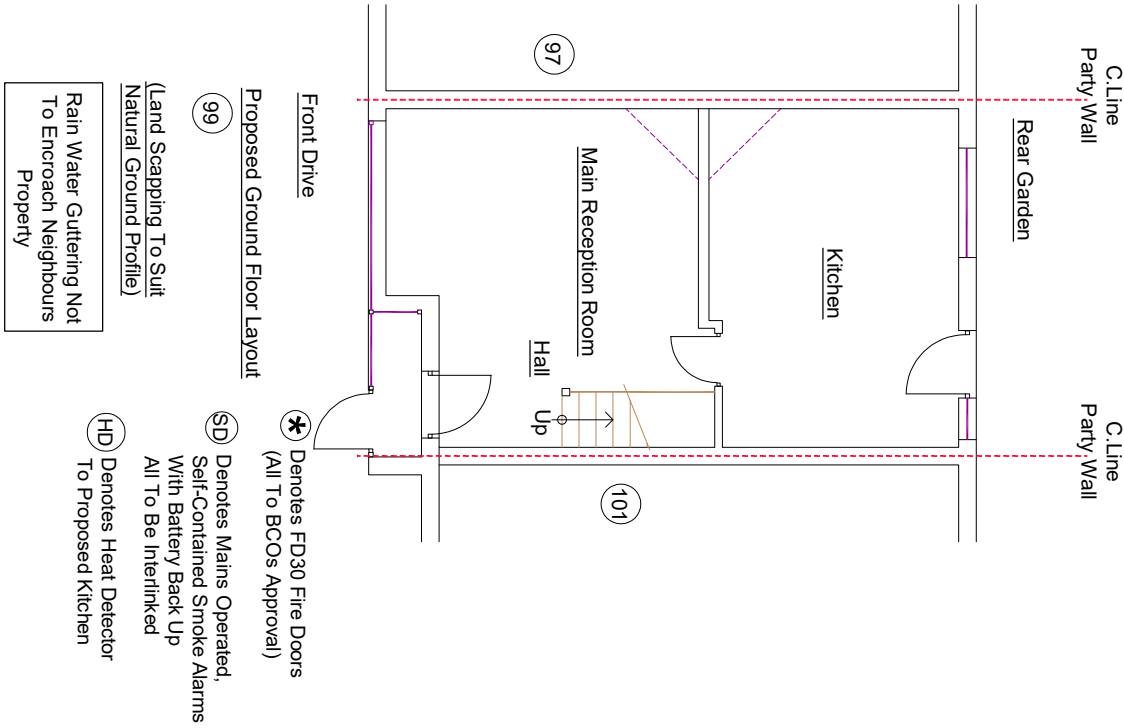

Loft Conversion:

REV	AMENDMENT	DATE	CHD
A	Planning Issue	26.05.25	RS

CLIENT

Prabhjot Multani

PROJECT

99 Royal Lane
Uxbridge - Middlesex
UB8 3QT

DRAWING TITLE

Proposed Loft Conversion
Proposed Floor Layouts
Sheet 3

SCALE	DRAWN BY	CHECKED	DATE
1:50 @ A1 1:100 @ A3	RS	RS	26.05.25

DRAWING STATUS

Planning Issue

DRAWING NUMBER	REVISION
2025 - 55 - 03	A