

EXISTING LOFT FLOOR PLAN

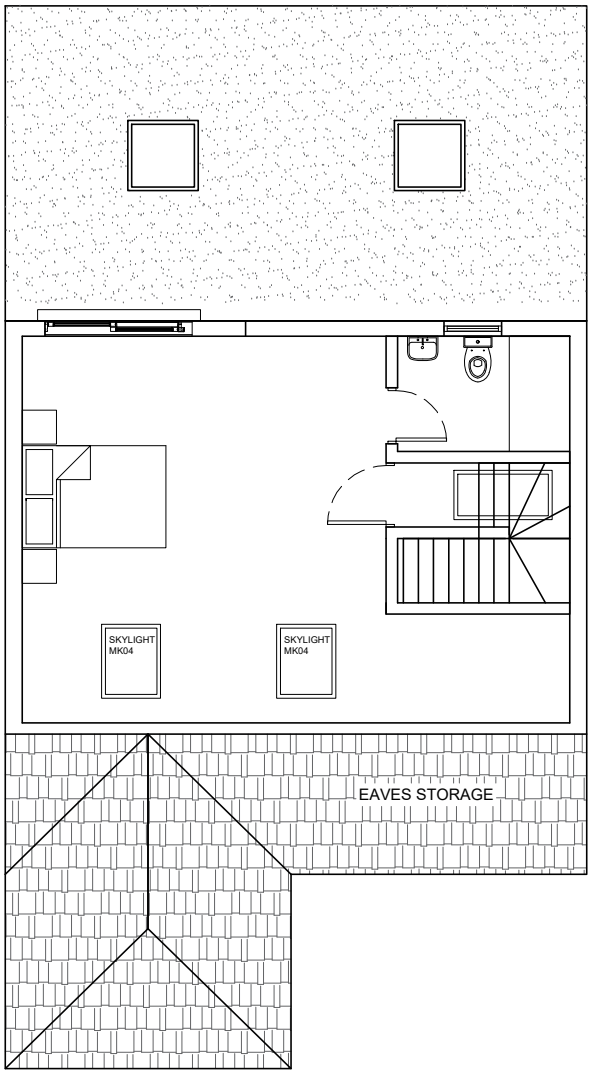

PROPOSED LOFT FLOOR PLAN



Archibees

12 Berghem Mews,
Blythe Road, London
United Kingdom
W14 0HN

Fay@archibees.com
0044 (0)7533344820

A.

GENERAL NOTES

- All dimensions must be checked on site before any works commencement.
- All discrepancies must be reported to the Main Architect before works proceed.
- Only figured dimensions are to be used.
- Any conflict of given data on the drawing(s) with site condition to be discussed with the Architect
- The General Contractor and/or all Sub-contractors working according these drawings and specifications to contact the architect or representative if any measurements do not appear correct or unclear, add up properly or scale correctly to the indicated size upon approvals.

STRUCTURAL NOTES

All Structural Elements Spans must be measured on site before ordering.
This drawing must be read in conjunction with the Structural Engineer's Drawings, Calculations and other details.

All drawings to be read in conjunction with structural engineer's drawings and specifications

Note: Accurate site dimensions are to be taken by the contractor on site prior to any construction commencing.

RELATIVE DOCUMENTS

Refer to the following APPROVED if applicable attached to the TENDER PACKAGE

DRAWINGS:

CONTRACT PARTICULARS
PRE CONSTRUCTION INFORMATION
SCHEDULE OF WORKS
MEP TENDER DRAWINGS
ELECTRICAL SERVICES SPECIFICATION

PROPERTY ADDRESS

37, Woodford Crescent
Pinner
HA5 3TZ
PROJECT

hip-to-gable Loft Conversion

TITLE

First Floor Plans

DWG REF

FL107

DRAWING NO.

A102

REVISION	01	DATE	18/07/2023
REV	-	DRAWN	FF
REV	-	CHECKED	AP
REV	-	SCALE	1:100