

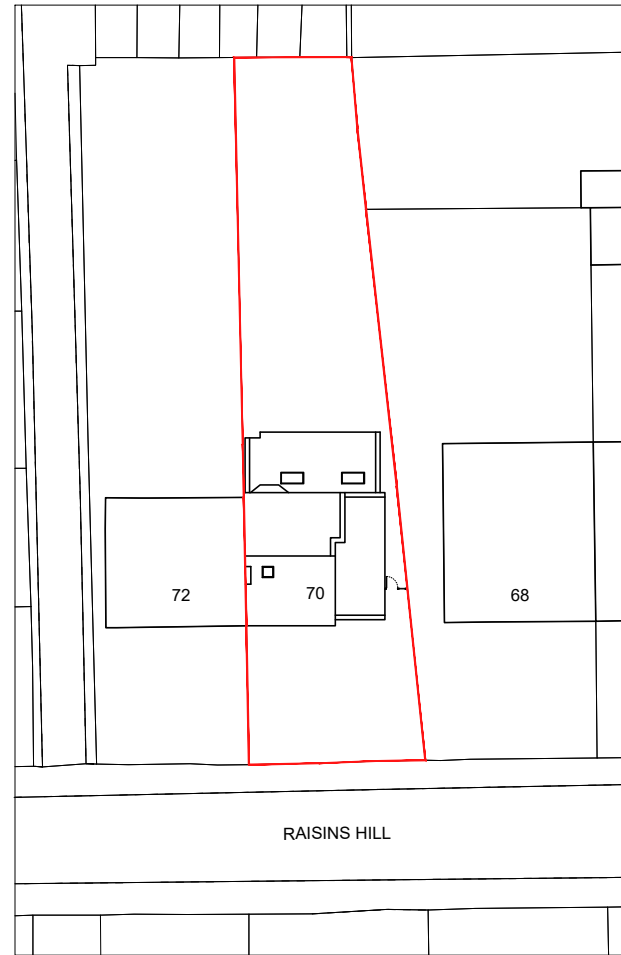
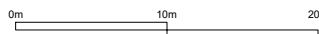

1 EXISTING SITE PLAN



2 PROPOSED SITE PLAN

B. 09.10.22- roof plan updated with changes to rooflight	
A. 29.07.22- depth of extension reduced to 72 following planning officer comments	
REVISION:	
 BANYAN TREE ARCHITECTS E: INFO@BANYANTREEARCHITECTS.COM T: 07980 765732	
PROJECT:	70 RAISINS HILL, PINNER, HA5 2BT
DRAWING:	PN_002_EXISTING AND PROPOSED SITE PLAN
SCALE:	1:500@A3
DATE:	19/06/22
REVISION:	B
STATUS:	PLANNING
	
	
All dimensions to be checked on site prior to construction. All drawings to be read in conjunction with structural engineer's drawings.	