

Note: This Drawing is for planning purpose and should not be used for construction.
All dimensions should be confirmed on site and any deviation should be reported back to designer.

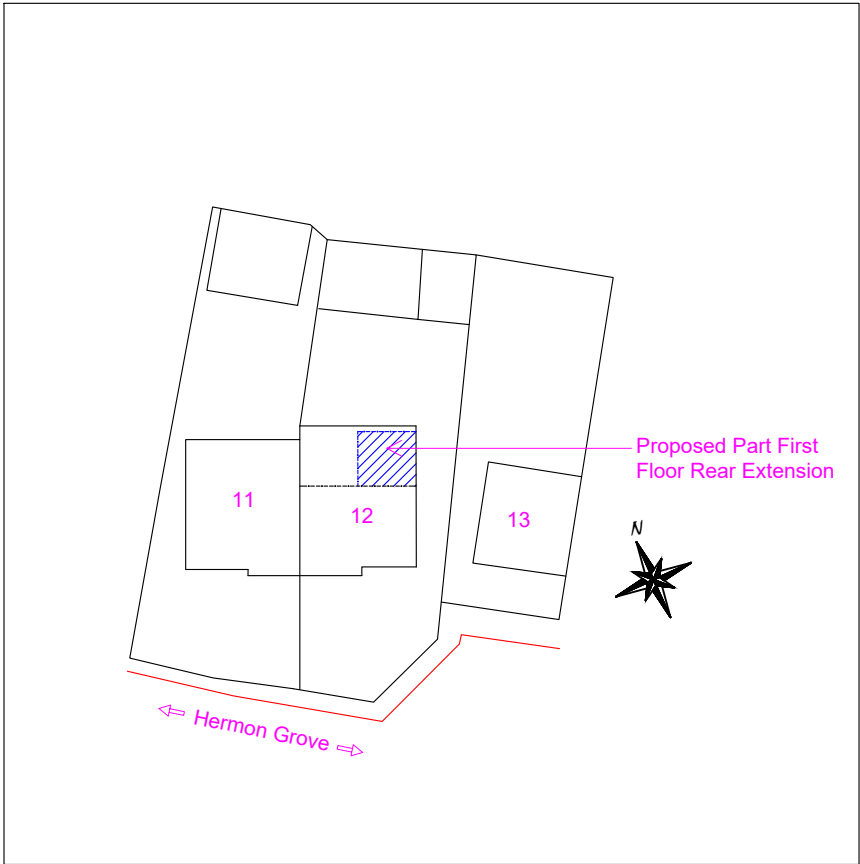

Site Plan @ Scale 1:500

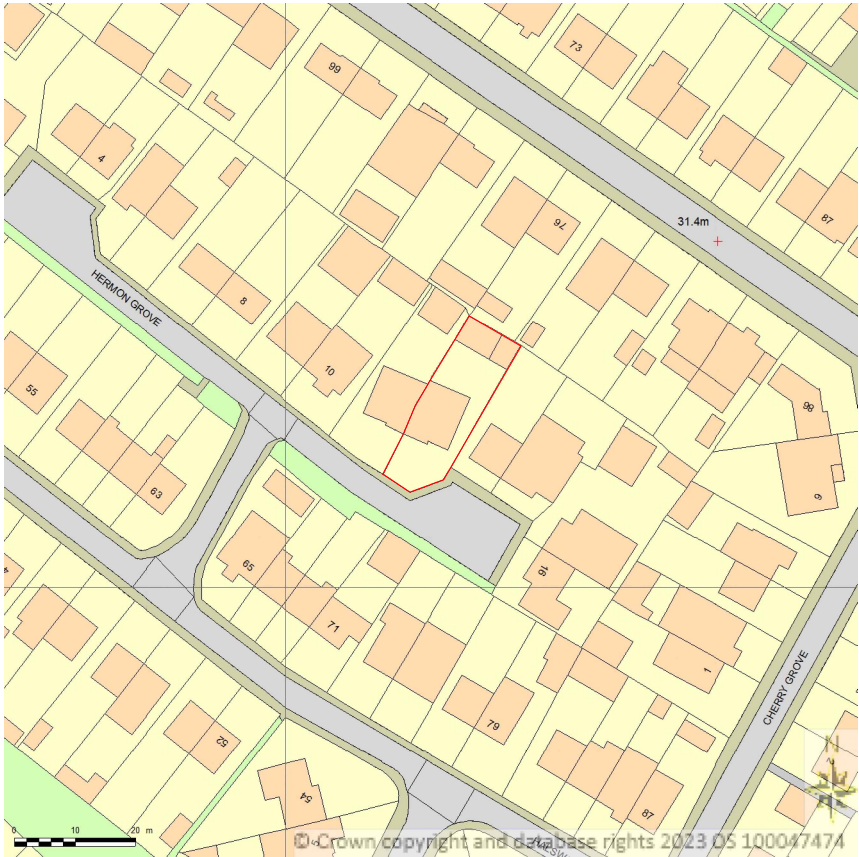

Location Plan @ 1:1250

<p><u>Proposed Development:</u> Part First Floor Rear Extension</p>	<p><u>Site Address:</u> 12 Hermon Grove Hayes UB3 3JZ</p>	<p>Revisions:</p> <table><tr><th>Rev</th><th>Date</th><th>Description</th></tr><tr><td>A</td><td>20/03/2023</td><td></td></tr><tr><td></td><td></td><td></td></tr><tr><td></td><td></td><td></td></tr><tr><td></td><td></td><td></td></tr></table>	Rev	Date	Description	A	20/03/2023											<p><u>Drawing Description:</u> Site plan & Location Plan</p> <p><u>Drawing No:</u> ART/2023/FE12HG/SPLP</p>	<p>Scale: 1:500, 1:1250 Paper Size: A3 Sheet No: 5 of 5</p> <div><div><div></div><div>0</div><div>5</div><div>10</div><div>15</div><div>20M</div></div><div>1:500</div></div> <div><div><div></div><div>0</div><div>25</div><div>50M</div></div><div>1:1250</div></div>	<p>ART CONSULTANTS (UK) LTD 113 LONG LANE STANWELL TW19 7AL M:07960071377 E: ARTCONSULTANTSUK@GMAIL.COM</p>
Rev	Date	Description																		
A	20/03/2023																			