

general notes:
do not scale from the drawing, all dimensions shall be checked on site prior to commencing works.
all works shall conform to the current edition of the building regulations and other relevant statutory requirements.
all materials and workmanship shall conform with the relevant british standard specifications and codes of practice.
this drawing is the copyright of gdm architects and shall not be copied or reproduced without permission.
this drawing shall be read in conjunction with gdm architect's health and safety risk assessments and all works shall be carried out in a safe manner, by competent persons.
drawing produced by gdm architects ltd trading as gdm architects.

revision: details: by: date:
P1 First Issue gl 24.04.2025

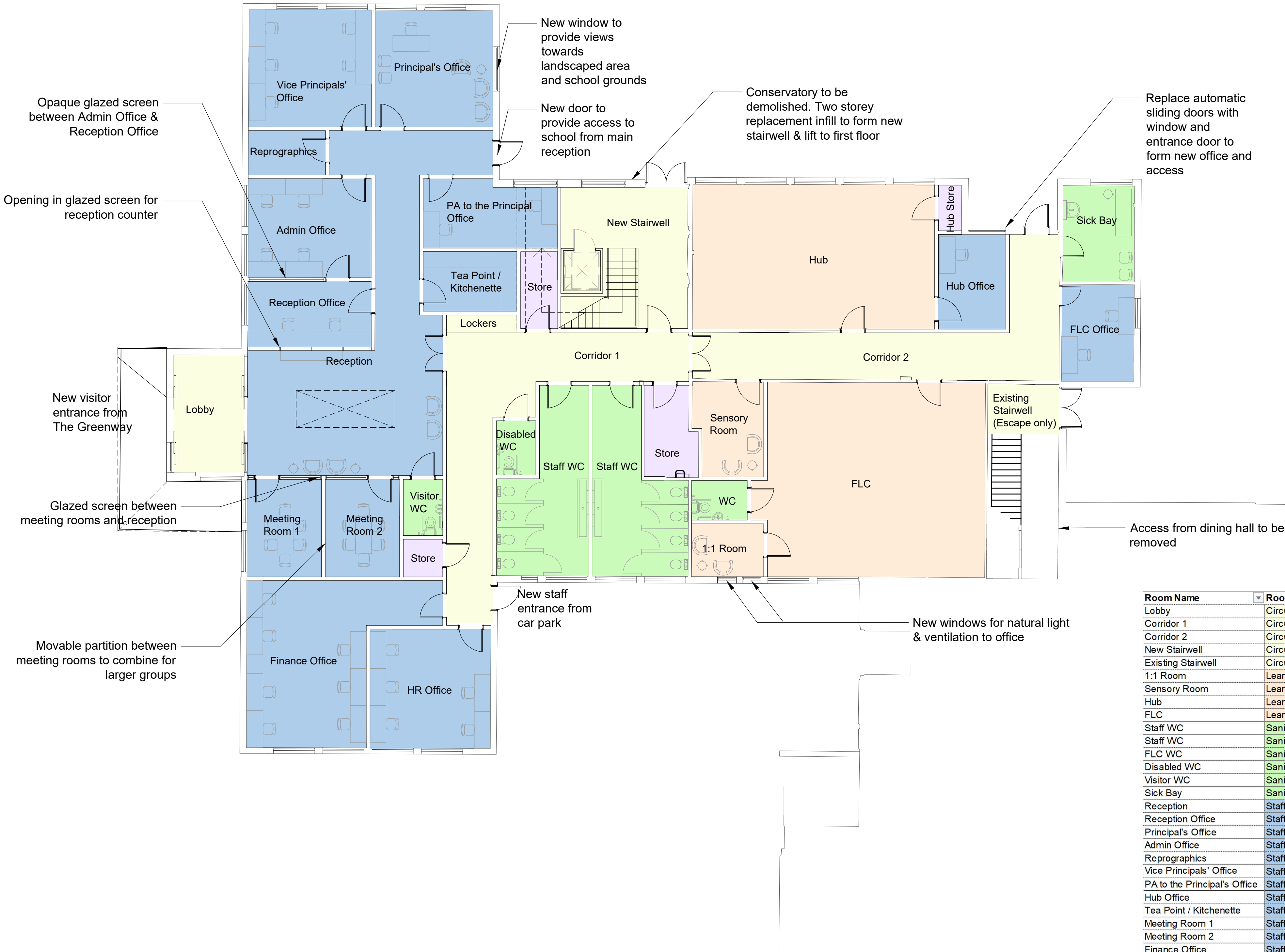

Room Name	Room Type	Floor	Area (m2)
Lobby	Circulation	Ground	14
Corridor 1	Circulation	Ground	43
Corridor 2	Circulation	Ground	37
New Stairwell	Circulation	Ground	30
Existing Stairwell	Circulation	Ground	6
1:1 Room	Learning Resource	Ground	6
Sensory Room	Learning Resource	Ground	10
Hub	Learning Resource	Ground	57
FLC	Learning Resource	Ground	70
Staff WC	Sanitary	Ground	23
Staff WC	Sanitary	Ground	23
FLC WC	Sanitary	Ground	4
Disabled WC	Sanitary	Ground	4
Visitor WC	Sanitary	Ground	4
Sick Bay	Sanitary	Ground	11
Reception	Staff & Administration	Ground	66
Reception Office	Staff & Administration	Ground	13
Principal's Office	Staff & Administration	Ground	22
Admin Office	Staff & Administration	Ground	20
Reprographics	Staff & Administration	Ground	5
Vice Principals' Office	Staff & Administration	Ground	24
PA to the Principal's Office	Staff & Administration	Ground	14
Hub Office	Staff & Administration	Ground	10
Tea Point / Kitchenette	Staff & Administration	Ground	9
Meeting Room 1	Staff & Administration	Ground	12
Meeting Room 2	Staff & Administration	Ground	12
Finance Office	Staff & Administration	Ground	38
HR Office	Staff & Administration	Ground	23
FLC Office	Staff & Administration	Ground	11
Store	Storage	Ground	2
Store	Storage	Ground	5
Store	Storage	Ground	7
Hub Store	Storage	Ground	2

637

Proposed Ground Floor Plan

Scale 1:100 @ A1

gdmarchitects

the master's house, college road, maidstone, kent ME15 6YF
t: 01622 760670 e: info@gdmarchitects.co.uk w: gdmarchitects.co.uk

client: Uxbridge High School

project: Main Building
The Greenway, UB8 2PR
title: Proposed Ground Floor Plan

date: April 2025 drawn by: ral
scale: 1-100 @ A1 checked: ge

PLANNING

project number	drawing number	revision
4445	P110	P1