

ALL NEW WORKS OR MAKING GOOD TO THE RETAINED FABRIC SHALL BE FINISHED TO MATCH IN SIZE, COLOR, TEXTURE AND PROFILE THOSE OF THE EXISTING BUILDING.

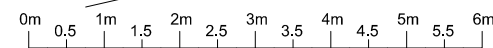
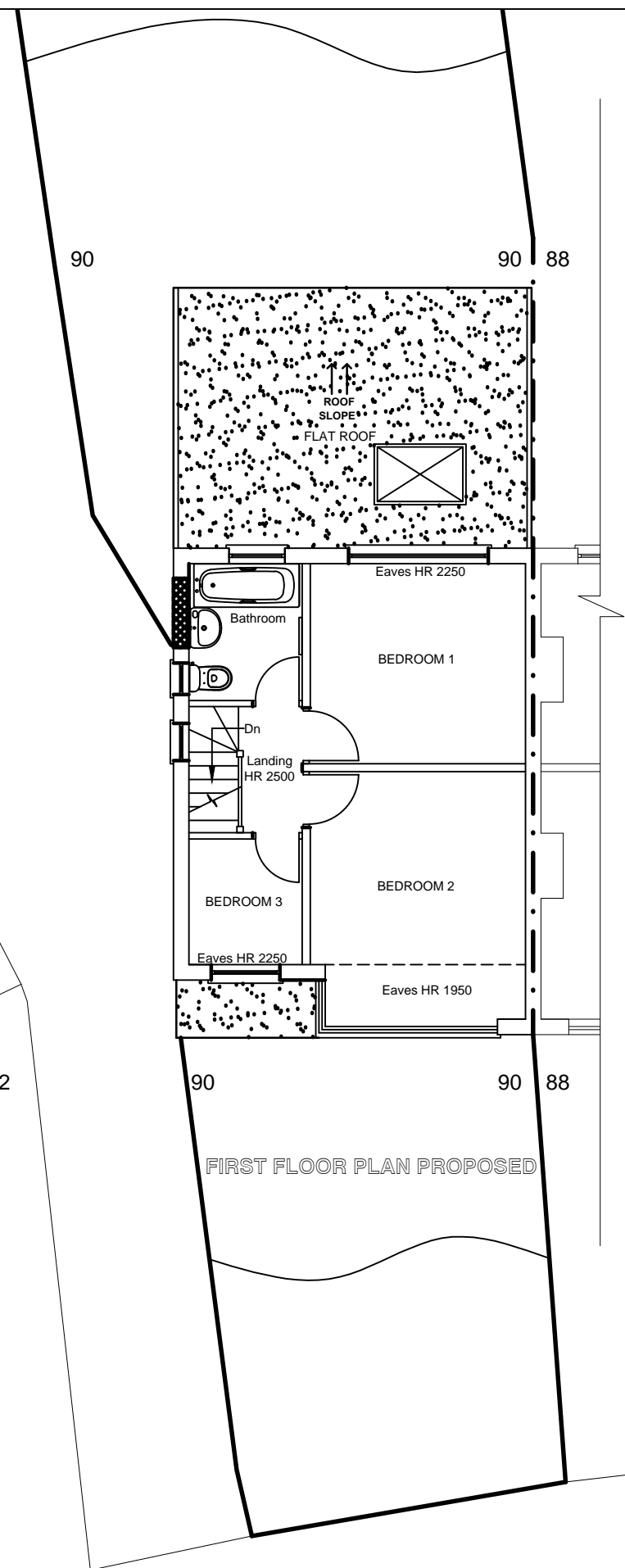

	05/04/2023	FOR LARGER HOME NOTIFICATION
	04/04/2023	FOR CLIENTS REVIEW
<b>Rev</b>	<b>Date</b>	<b>Comment</b>

<b>PROJECT:</b> SINGLE STOREY REAR EXTENSION AND ASSOCIATED ALTERATIONS AT 90 WALTHAM AVENUE, HAYES UB3 1TD
--

Title: Ground/First Floor Plan Proposed		
Drawn By: PSL	Rev:	Date: 05/04/2023
SCALE: 1:100@A3	DRG. NO: 2303-WALTHAM AVE 90-202	