

10m 5m 0m 5m 10m

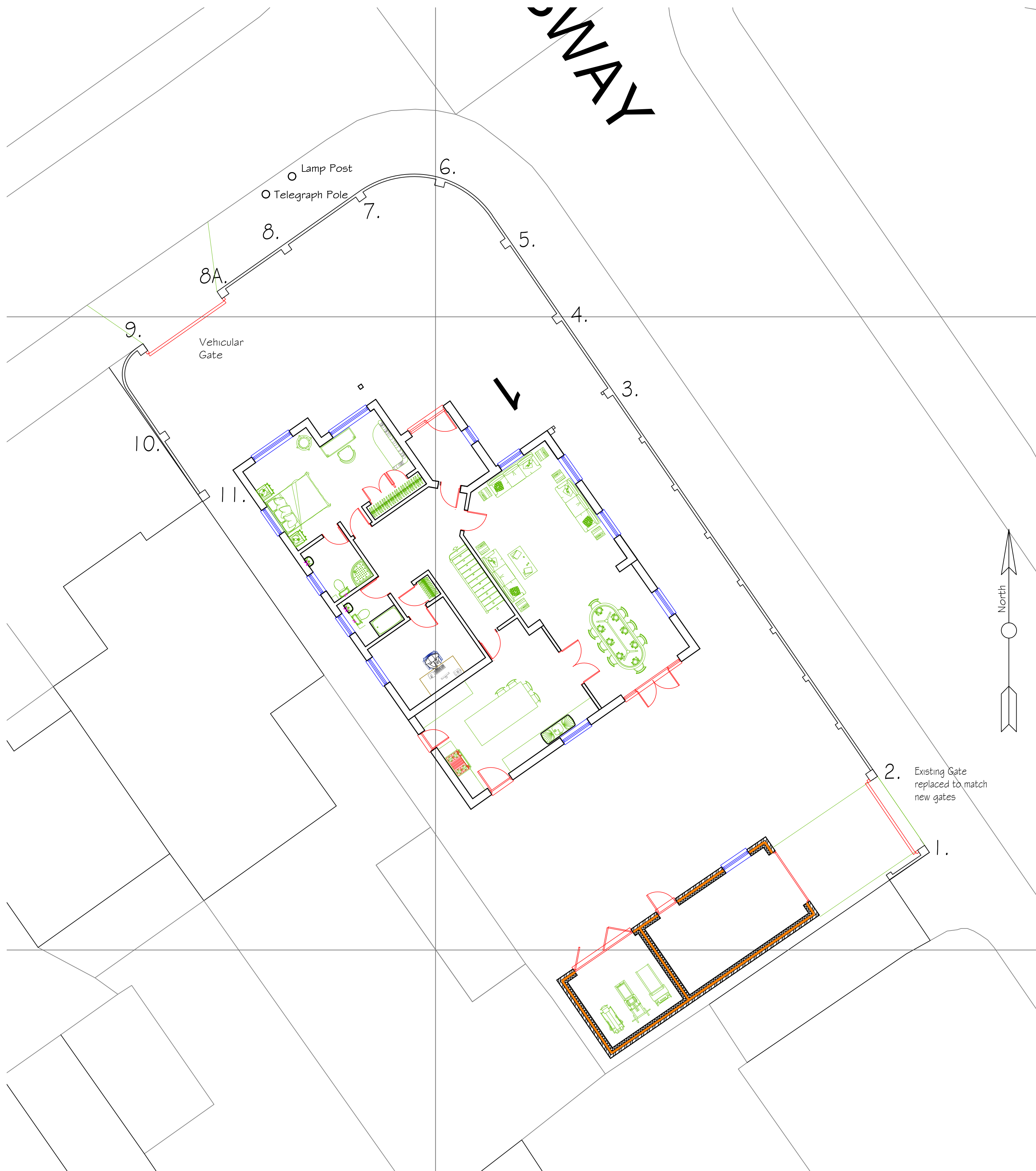

Proposed Boundary Wall Plan reinstated after the Collapse - Scale 1:100@A3

NOTE: ALL PIERS HAVE BEEN NUMBERED FOR EASE OF CROSS REFERENCING

Proposed Replacement of Existing Boundary Wall which  
collapsed at 1 The Croft, Ruislip, Hillingdon, HA4 0SF

Date Dec 2023

Rev A - 29/02/24 - Vehicular opening reduced in  
width as requested by Planning Officer

Drawing No. 2023/42/06A@A2

CORPORATE ARCHITECTURE  
& DESIGN GROUP



SEVENCROFT LTD.

277 Canterbury Road, Kennington  
Ashford, Kent TN24 9QW  
Tel: 01233 625553  
e-mail : sevencroft@hotmail.co.uk