

DO NOT SCALE
These drawings and designs are the
copyright of
SEVENCROFT LTD.

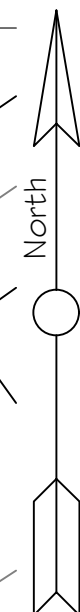
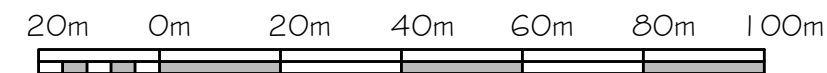
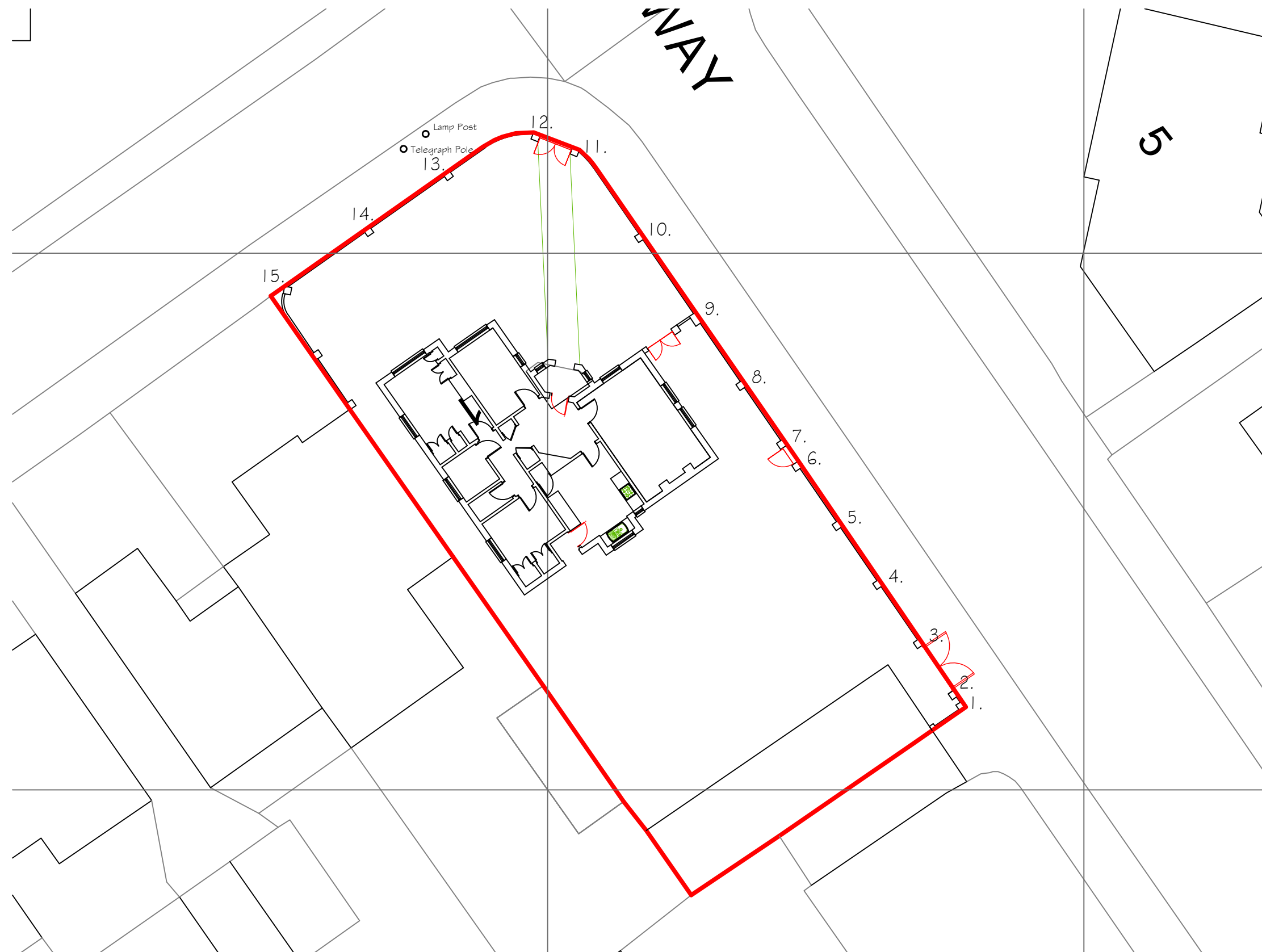

Proposed Site Location Plan -
Scale 1:1250

Existing Boundary Wall Plan prior to Collapse - Scale 1:200@A3

NOTE: ALL PIERS HAVE BEEN NUMBERED FOR EASE OF CROSS REFERENCING

Proposed Replacement of Existing Boundary wall which
collapsed at 1 The Croft, Ruislip, Hillingdon, HA4 OSF

Date Dec 2023

Drawing No. 2023/42/01 @A3

CORPORATE ARCHITECTURE
& DESIGN GROUP



SEVENCROFT LTD.

277 Canterbury Road, Kennington
Ashford, Kent TN24 9QW
Tel: 01233 625553
e-mail : sevincroft@hotmail.co.uk