

NO DIMENSIONS TO BE SCALED FROM THIS DRAWING

Rev	Date	Reference	Drawn / Chk'd
P04	2024/12/18	PARKING SCHEDULE ADDED.	AA AA

SCHEDULE OF ACCOMMODATION - KEY

Site Area	0.646Ha (1.596 Acres)	
<b>PARKING</b>		
Standard		85
Disabled	♿	8
<b>Total Parking</b>		<b>93</b>

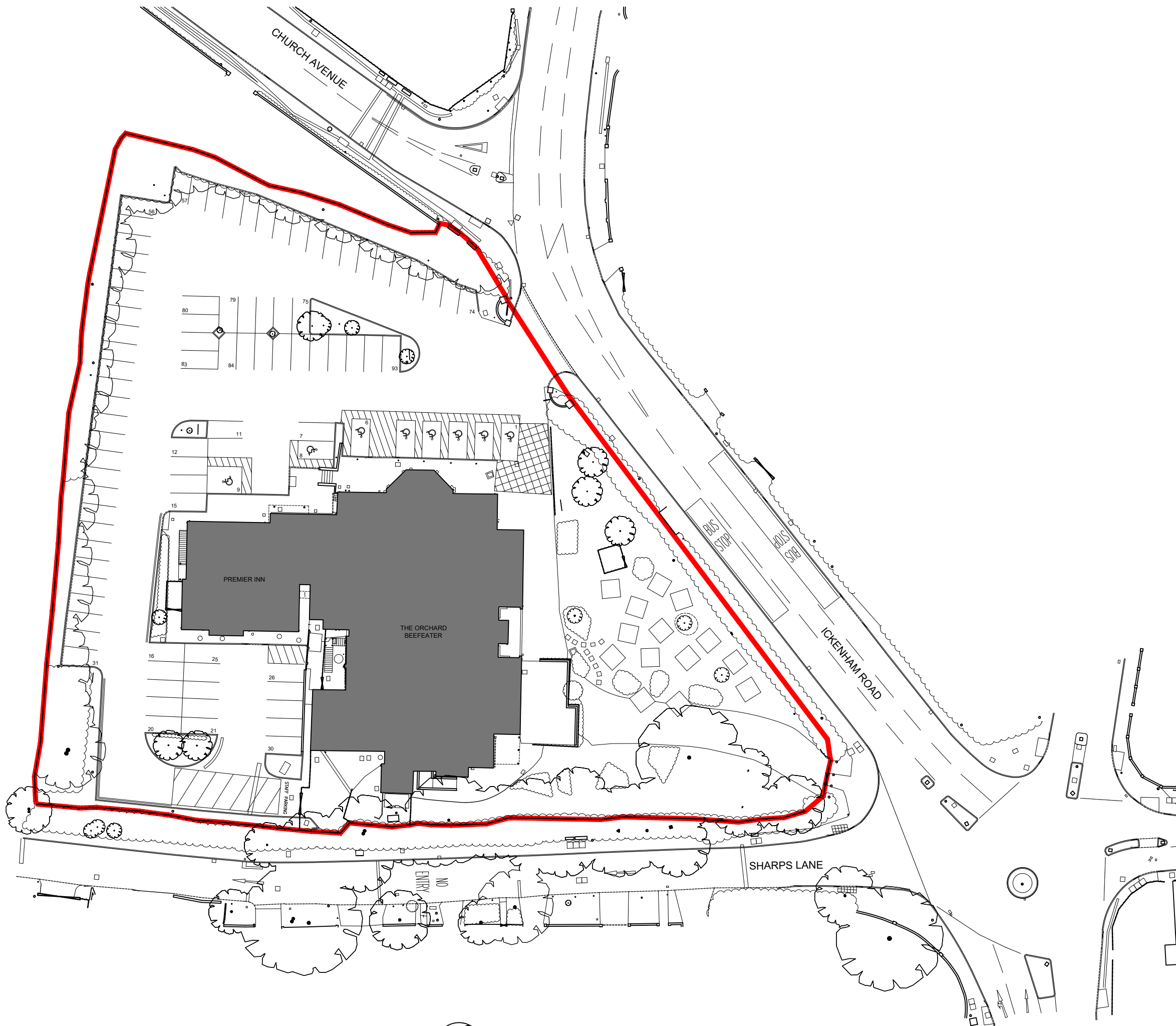

Client  
**Lidl Great Britain Ltd**

Project  
**Lidl  
 Ickenham Road, Ruislip**

Title  
**Site Plan as Existing**

Drawing Ref.	Revision
<b>4478-0100</b>	<b>P04</b>

Scale - unless otherwise stated	Status	Issued For
1:500 @ A3	S0	Preliminary

**KLH architects**  
 The Old Steelyard, Poplar Lane  
 Sproughton, Ipswich, IP8 3HL  
 t.01473 689532  
 klh@klharchitects.com  
 www.klharchitects.com

0 10 20 30 40 50m

