

22 Railway infrastructure and projects

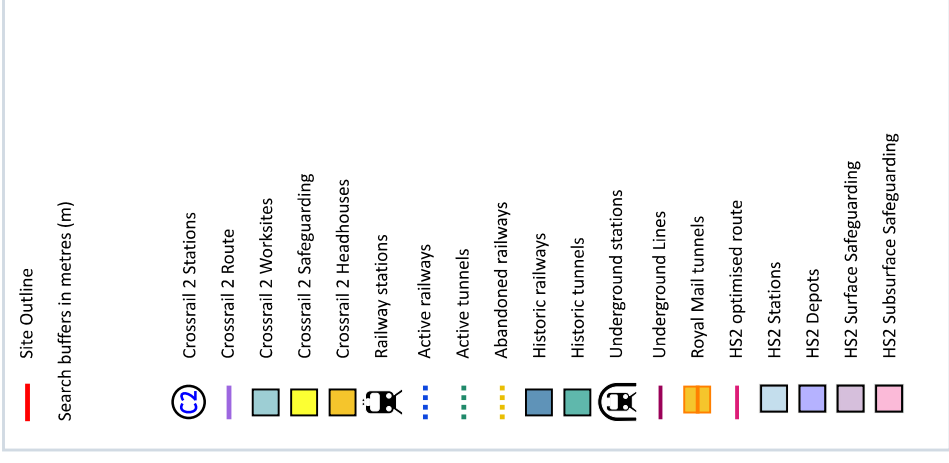

22.1 Underground railways (London)

Records within 250m

2

Details of all active London Underground lines, including approximate tunnel roof depth and operational hours.

Features are displayed on the Railway infrastructure and projects map on [page 100](#) >

Location	Line Name	Line Section	Track Type	Depth (m bgl)	Operational hours
186m S	Metropolitan Line	Metropolitan Line	Surface Track	0	Mon-Sat: Early 0500 Late 0119, Sun: Early 0636 Late 0016
187m S	Piccadilly Line	Piccadilly Line - Acton Town to/from Uxbridge	Surface Track	0	No 24hr service. Mon-Sat: Early 0449 Late 0121, Sun: Early 0532 Late 0056



This data is sourced from publicly available information by Groundsure.

22.2 Underground railways (Non-London)

Records within 250m

0

Details of the Merseyrail system, the Tyne and Wear Metro and the Glasgow Subway. Not all parts of all systems are located underground. The data contains location information only and does not include a depth assessment.

This data is sourced from publicly available information by Groundsure.

22.3 Railway tunnels

Records within 250m

0

Railway tunnels taken from contemporary Ordnance Survey® mapping.

This data is sourced from the Ordnance Survey®.

22.4 Historical railway and tunnel features

Records within 250m

15

Railways and tunnels digitised from historical Ordnance Survey® mapping as scales of 1:1,250, 1:2,500, 1:10,000 and 1:10,560.

Features are displayed on the Railway infrastructure and projects map on [page 100](#) >

Location	Land Use	Year of mapping	Mapping scale
168m S	Railway Sidings	1938	10560
169m SE	Railway Sidings	1914	2500
169m SE	Railway Sidings	1935	2500
169m SE	Railway Sidings	1960	2500
170m SE	Railway Sidings	1935	10560
170m SE	Railway Sidings	1912	10560
170m SE	Railway Sidings	1938	2500
171m SE	Railway Sidings	1966	10560
171m SE	Railway Sidings	1960	10560
174m S	Railway Sidings	1920	10560
178m S	Railway Sidings	1935	10560

Location	Land Use	Year of mapping	Mapping scale
178m S	Railway Sidings	1912	10560
201m S	Railway	1938	-
218m S	Railway Sidings	1960	10560
223m S	Railway Sidings	1967	10560

This data is sourced from Ordnance Survey®/Groundsure.

22.5 Royal Mail tunnels

Records within 250m

0

The Post Office Railway, otherwise known as the Mail Rail, is an underground railway running through Central London from Paddington Head District Sorting Office to Whitechapel Eastern Head Sorting Office. The line is 10.5km long. The data includes details of the full extent of the tunnels, the depth of the tunnel, and the depth to track level.

This data is sourced from Groundsure/the Postal Museum.

22.6 Historical railways

Records within 250m

0

Former railway lines, including dismantled lines, abandoned lines, disused lines, historic railways and razed lines.

This data is sourced from OpenStreetMap.

22.7 Railways

Records within 250m

3

Currently existing railway lines, including standard railways, narrow gauge, funicular, trams and light railways. Features are displayed on the Railway infrastructure and projects map on [page 100](#) >

Location	Name	Type
188m S	Not given	Multi Track
197m SE	Not given	Multi Track
203m SE	Not given	Multi Track

This data is sourced from Ordnance Survey® and OpenStreetMap.



22.8 Crossrail 2

Records within 500m

0

Crossrail 2 is a proposed railway linking the national rail networks in Surrey and Hertfordshire via an underground tunnel through London.

This data is sourced from publicly available information by Groundsure.

22.9 HS2

Records within 500m

0

HS2 is a proposed high speed rail network running from London to Manchester and Leeds via Birmingham. Main civils construction on Phase 1 (London to Birmingham) of the project began in 2019, and it is currently anticipated that this phase will be fully operational by 2026. Construction on Phase 2a (Birmingham to Crewe) is anticipated to commence in 2021, with the service fully operational by 2027. Construction on Phase 2b (Crewe to Manchester and Birmingham to Leeds) is scheduled to begin in 2023 and be operational by 2033.

This data is sourced from HS2 Ltd.

Data providers

Groundsure works with respected data providers to bring you the most relevant and accurate information. To find out who they are and their areas of expertise see <https://www.groundsure.com/sources-reference>.

Terms and conditions

Groundsure's Terms and Conditions can be accessed at this link: www.groundsure.com/terms-and-conditions-april-2023.



APPENDIX E: HISTORICAL MAPS



Site details:	83-89 Manor Way, Ruislip
Client ref:	GO3967 M45391 83-89 Manor Way, Ruislip
Report ref:	GS-3HL-T9Y-453-CLG
Grid ref:	509929.58, 187405.39
Production date:	16 February 2026

Map name:	County Series
Map date:	1865
Scale:	1:2,500
Printed at:	1:2,500



Date: 1865 Surveyed: 1865 Revised: 1865

Contact us with any questions at:
info@groundsure.com
 01273 257 755

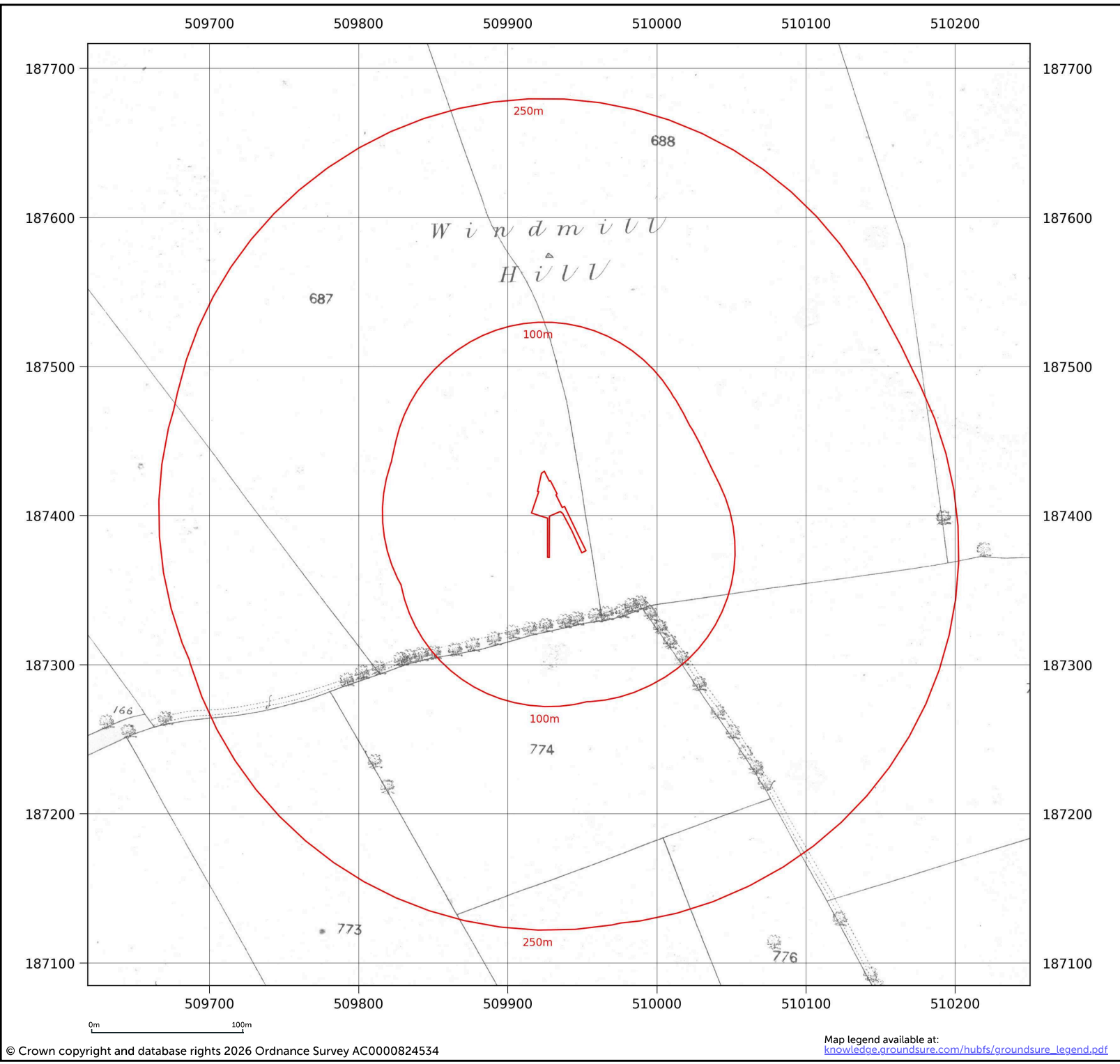

Site details:	83-89 Manor Way, Ruislip
Client ref:	GO3967 M45391 83-89 Manor Way, Ruislip
Report ref:	GS-3HL-T9Y-453-CLG
Grid ref:	509929.58, 187405.39
Production date:	16 February 2026

Map name:	County Series
Map date:	1896
Scale:	1:2,500
Printed at:	1:2,500



Date: 1896
 Surveyed: 1896
 Revised: 1896

Contact us with any questions at:
info@groundsure.com
 01273 257 755

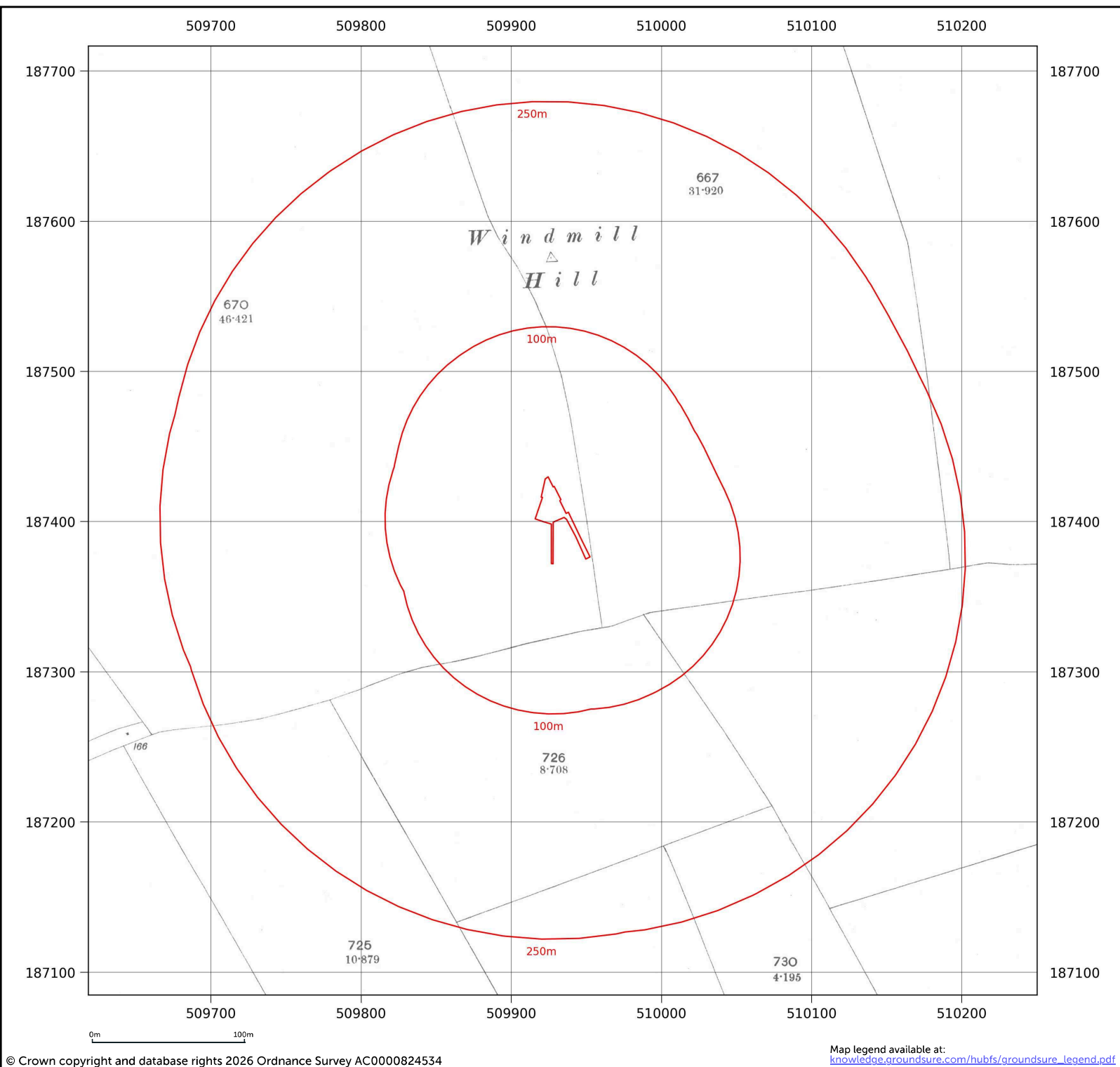

Site details: 83-89 Manor Way, Ruislip
Client ref: GO3967 M45391 83-89 Manor Way, Ruislip
Report ref: GS-3HL-T9Y-453-CLG
Grid ref: 509929.58, 187405.39
Production date: 16 February 2026

Map name: County Series
Map date: 1914
Scale: 1:2,500
Printed at: 1:2,500



Date: 1914
 Surveyed: 1914
 Revised: 1914

Contact us with any questions at:
info@groundsure.com
 01273 257 755

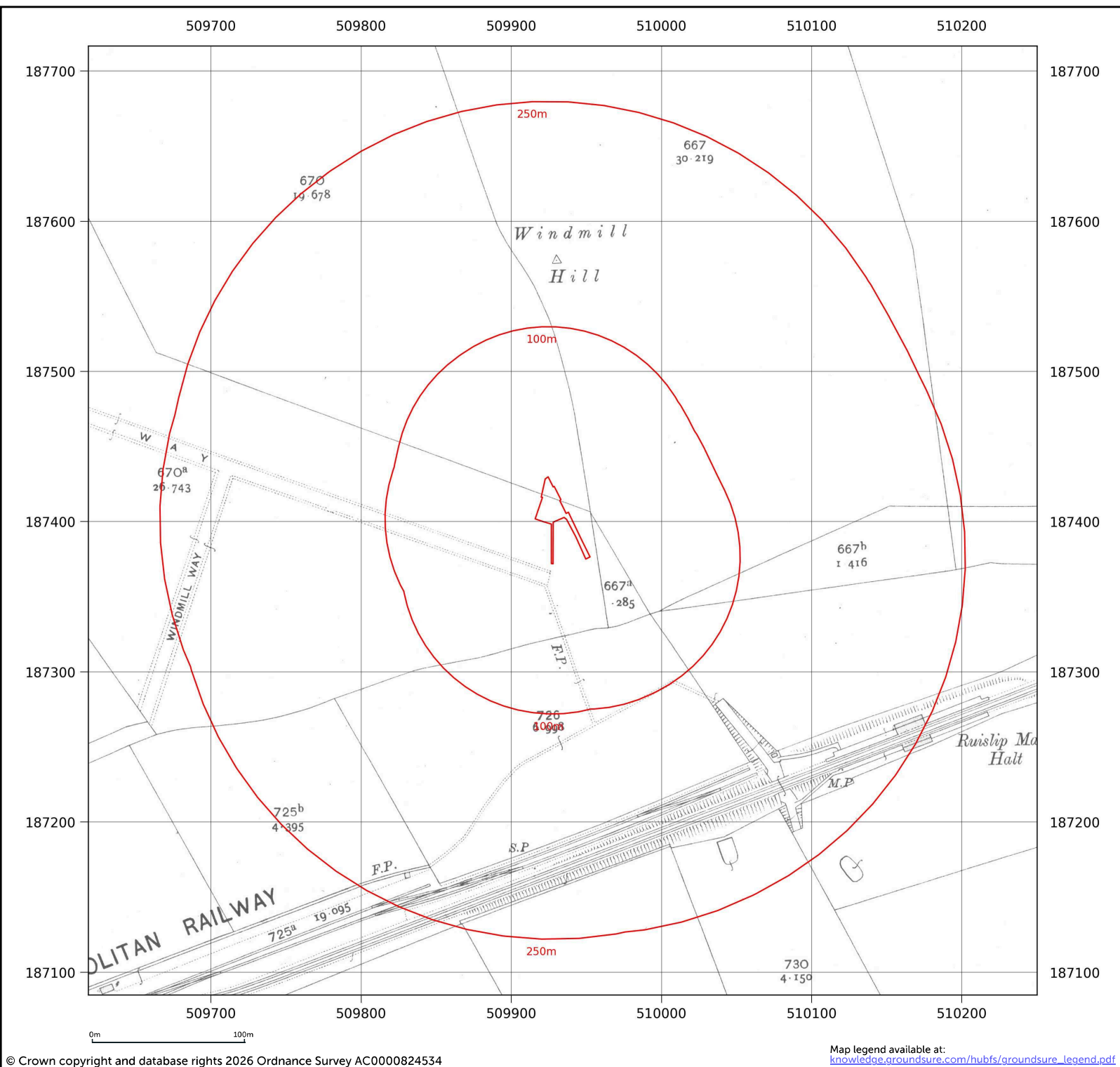

0m 100m

Site details: 83-89 Manor Way, Ruislip
Client ref: GO3967 M45391 83-89 Manor Way, Ruislip
Report ref: GS-3HL-T9Y-453-CLG
Grid ref: 509929.58, 187405.39
Production date: 16 February 2026

Map name: County Series
Map date: 1935
Scale: 1:2,500
Printed at: 1:2,500



Date: 1935
 Surveyed: 1935
 Revised: 1935

Contact us with any questions at:
info@groundsure.com
 01273 257 755

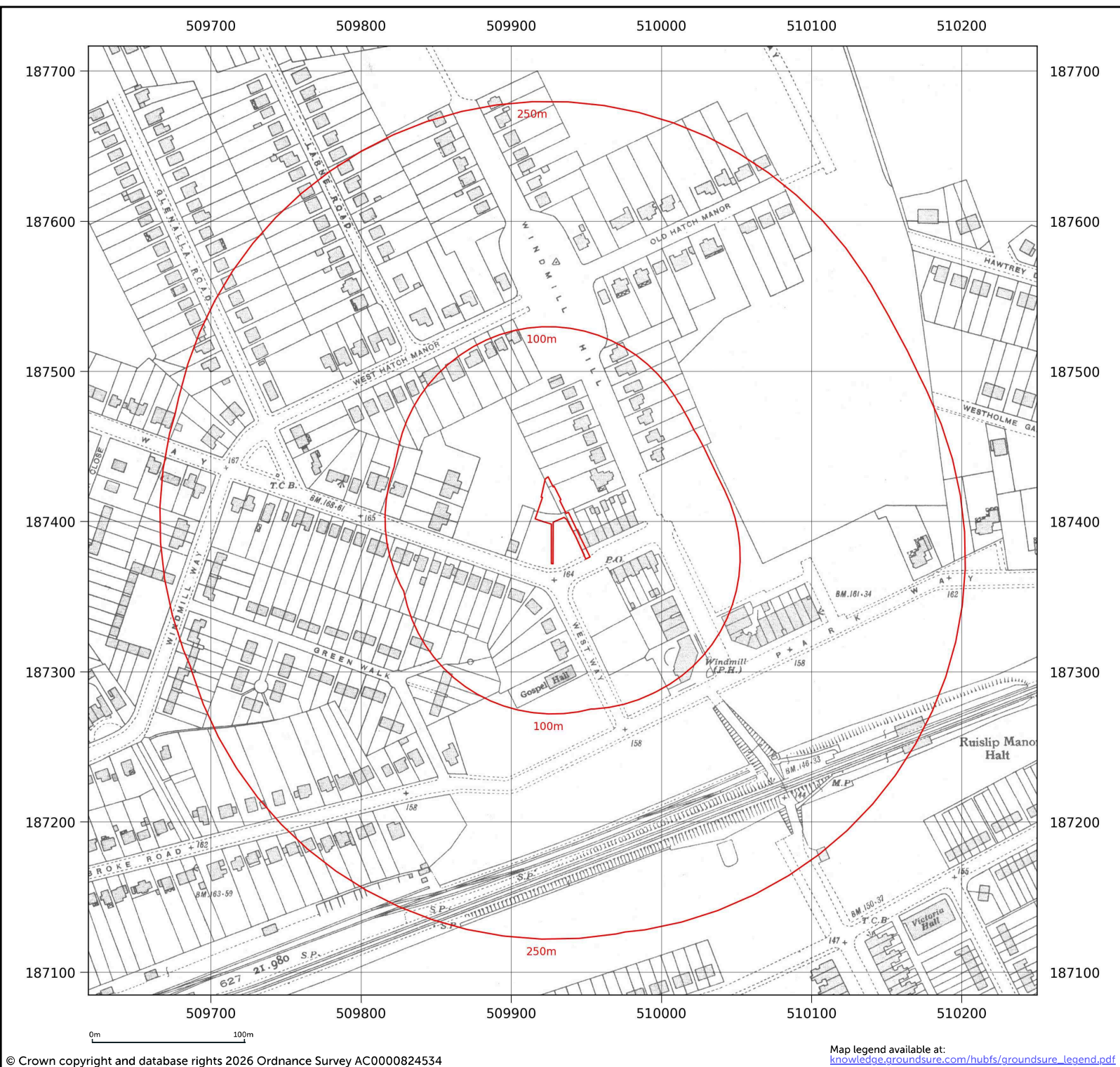

Site details: 83-89 Manor Way, Ruislip
Client ref: GO3967 M45391 83-89 Manor Way, Ruislip
Report ref: GS-3HL-T9Y-453-CLG
Grid ref: 509929.58, 187405.39
Production date: 16 February 2026

Map name: County Series
Map date: 1938
Scale: 1:2,500
Printed at: 1:2,500



Date: 1938
 Surveyed: 1938
 Revised: 1938

Contact us with any questions at:
info@groundsure.com
 01273 257 755

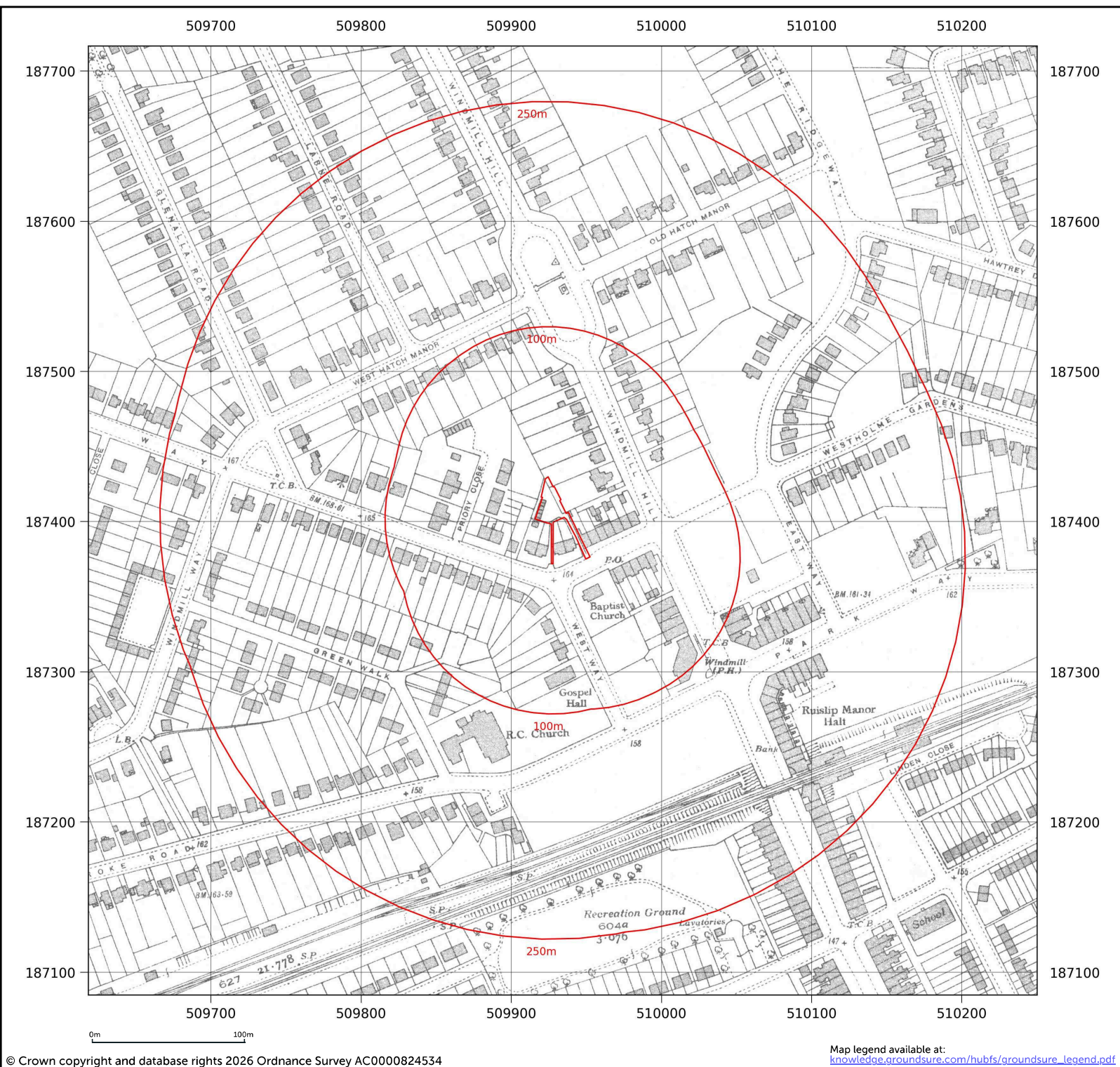

Site details: 83-89 Manor Way, Ruislip
Client ref: GO3967 M45391 83-89 Manor Way, Ruislip
Report ref: GS-3HL-T9Y-453-CLG
Grid ref: 509929.58, 187405.39
Production date: 16 February 2026

Map name: National Grid
Map date: 1960-1961
Scale: 1:1,250
Printed at: 1:2,000



Date: 1961 Surveyed: 1960 Revised: 1960 Copyright: 1961 Levelled: 1957	Date: 1960 Surveyed: 1959 Revised: 1959 Copyright: 1960 Levelled: 1957
Date: 1961 Surveyed: 1960 Revised: 1960 Copyright: 1961 Levelled: 1957	Date: 1960 Surveyed: 1959 Revised: 1959 Copyright: 1960 Levelled: 1957

Contact us with any questions at:
info@groundsure.com
 01273 257 755



Site details: 83-89 Manor Way, Ruislip
Client ref: GO3967 M45391 83-89 Manor Way, Ruislip
Report ref: GS-3HL-T9Y-453-CLG
Grid ref: 509929.58, 187405.39
Production date: 16 February 2026

Map name: National Grid
Map date: 1960-1962
Scale: 1:2,500
Printed at: 1:2,500



Date: 1962	Date: 1960
Surveyed: 1960	Surveyed: 1959
Revised: 1960	Revised: 1959
Edition: 1962	Edition: 1960
Copyright: 1962	Copyright: 1960
Levelled: 1957	Levelled: 1957

Contact us with any questions at:
info@groundsure.com
 01273 257 755

