

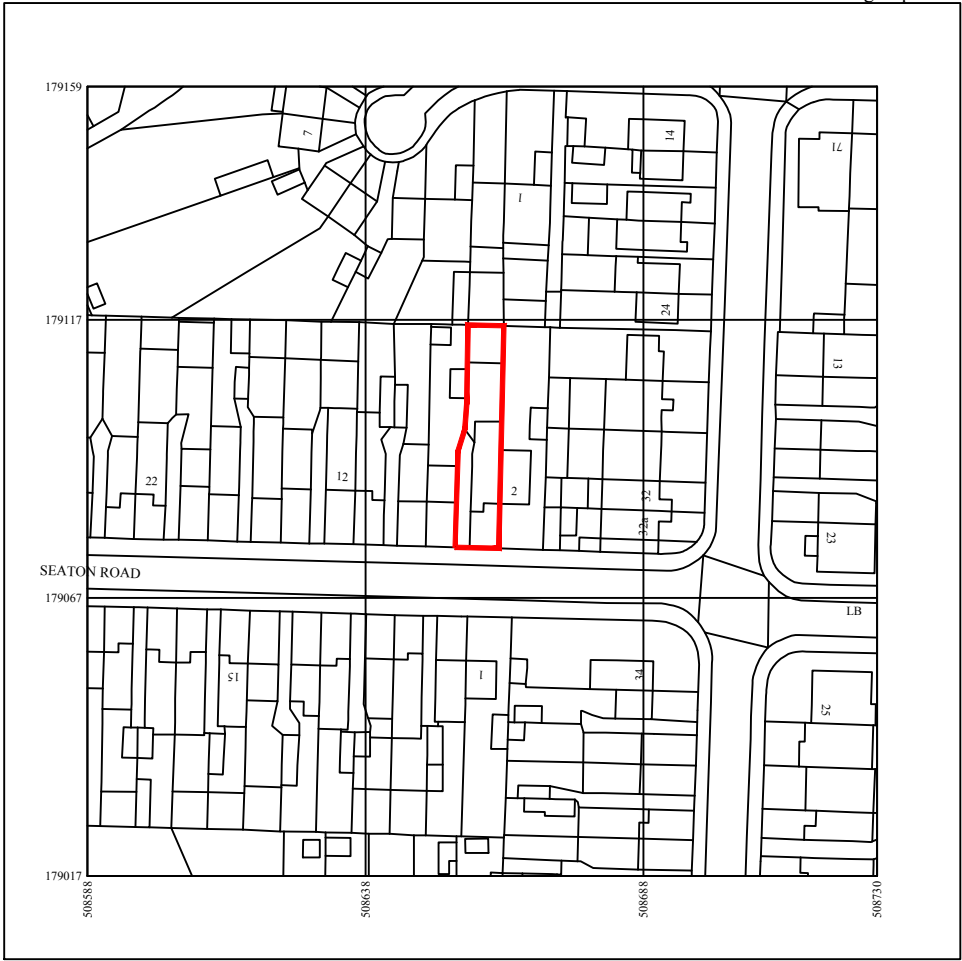

01856 898 022
www.UKPlanningMaps.com



Produced on 10 July 2023 from the Ordnance Survey National Geographic Database and incorporating surveyed revision available at this date.
This map shows the area bounded by 508588 179017,508730 179017,508730 179159,508588 179159,508588 179017
Crown copyright and database rights 2023 OS 100054135. Supplied by copla ltd trading as UKPlanningMaps.com a licensed Ordnance Survey partner (OS 100054135).
Data licence expires 10 July 2024. Unique plan reference: v2c/973980/1313091



Property Address			Scale	ARM Design & Build Ltd Suit 210, Kingfisher House, Restmor Way, Wallington, England, SM6 7AH Telephone: 07816587548
4 Seaton Road, Hayes UB3 1NS			1:1250@ A3	
	Description	Drawing Number		
	OS Map	0001-4SR		