

PROPOSED SECOND FLOOR

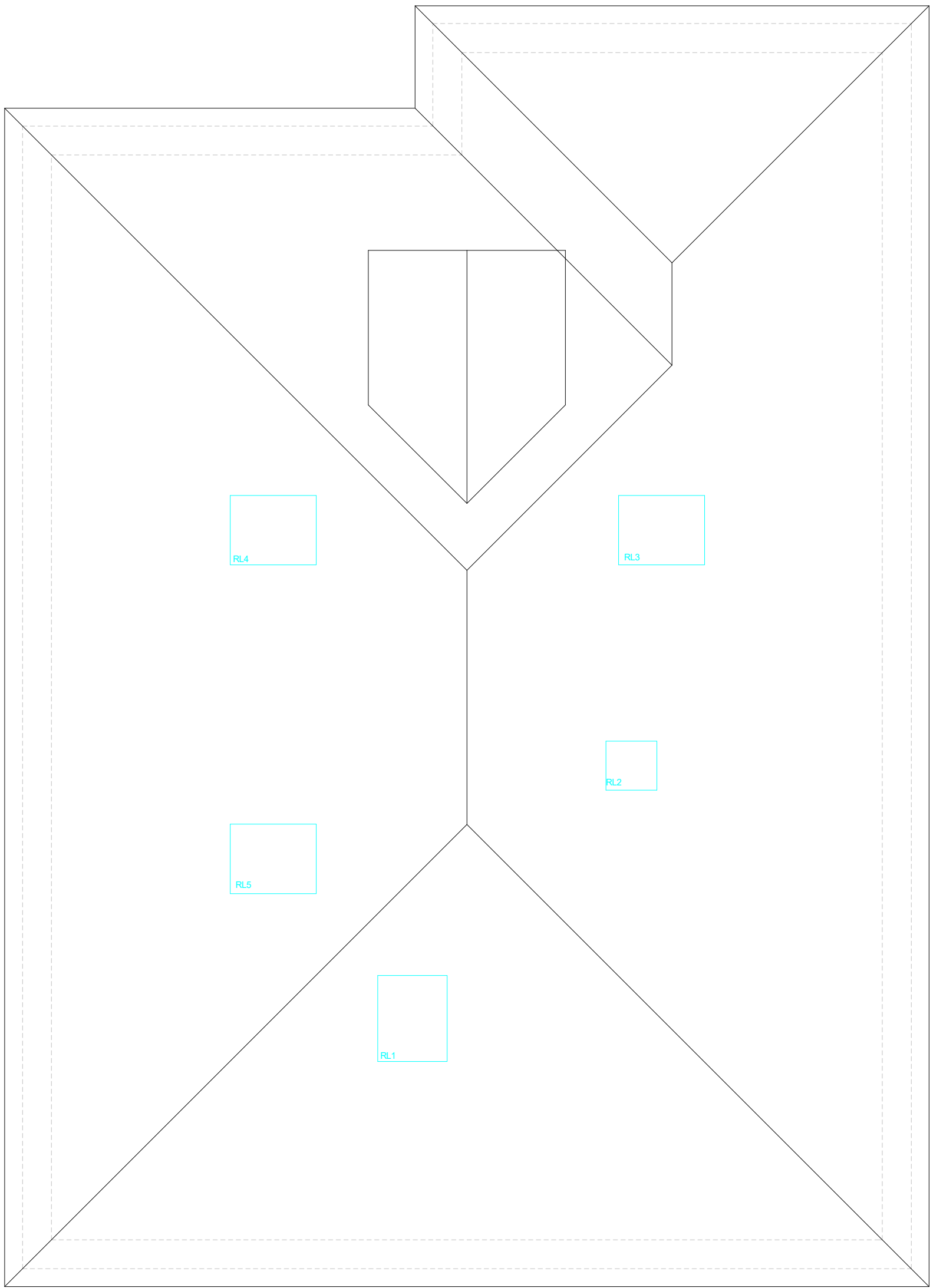

PROPOSED ROOF PLAN

PROJECT	72 Sweetcroft Lane Hillingdon
PROPOSAL	NEW 4 BEDROOM HOUSE

SCALE: 1-50 @ A2	
DRAWN: Andy Wilcock	
DATE: 26th November 2025	
DRAWING NUMBER	REV
534 - 2	C

PROPOSED LOFT AND ROOF PLANS		
REV	DESCRIPTION	DATE

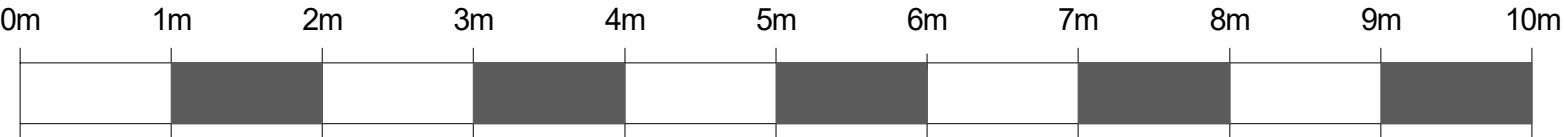
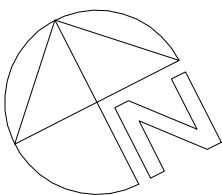

Highford
Design and Build Limited

53a Glebe Road, Chalfont St Peter, Buckinghamshire
email: info@highforddesign.co.uk - web: www.highforddesign.co.uk
mobile: 01957 340205