

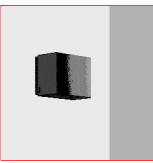

A	Allure Wall mounted IP66 LED downlight 7.1W 530lm 3000K CR180 - Asymmetrical side optic On/Off integral driver Wall mounted with X805 conduit box Quantity - 04no	S651 + X799 + X805	
B	Allure Wall mounted IP66 LED downlight 7.1W 577lm 3000K CR180 - Asymmetrical forward optic On/Off integral driver Wall mounted with X805 conduit box Quantity - 03no	S659 + X799 + X805	
C	iWay Ground mounted LED bollard 12.4W 540lm 3000K CR180 - 180° asymmetric optic DALI-2 integral driver Ground mounted with B513 anchor plate Quantity - 01no	BW79 + X023 + B513 + X188	

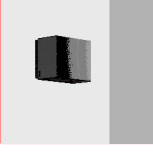

NOTE

NOT FOR CONSTRUCTION

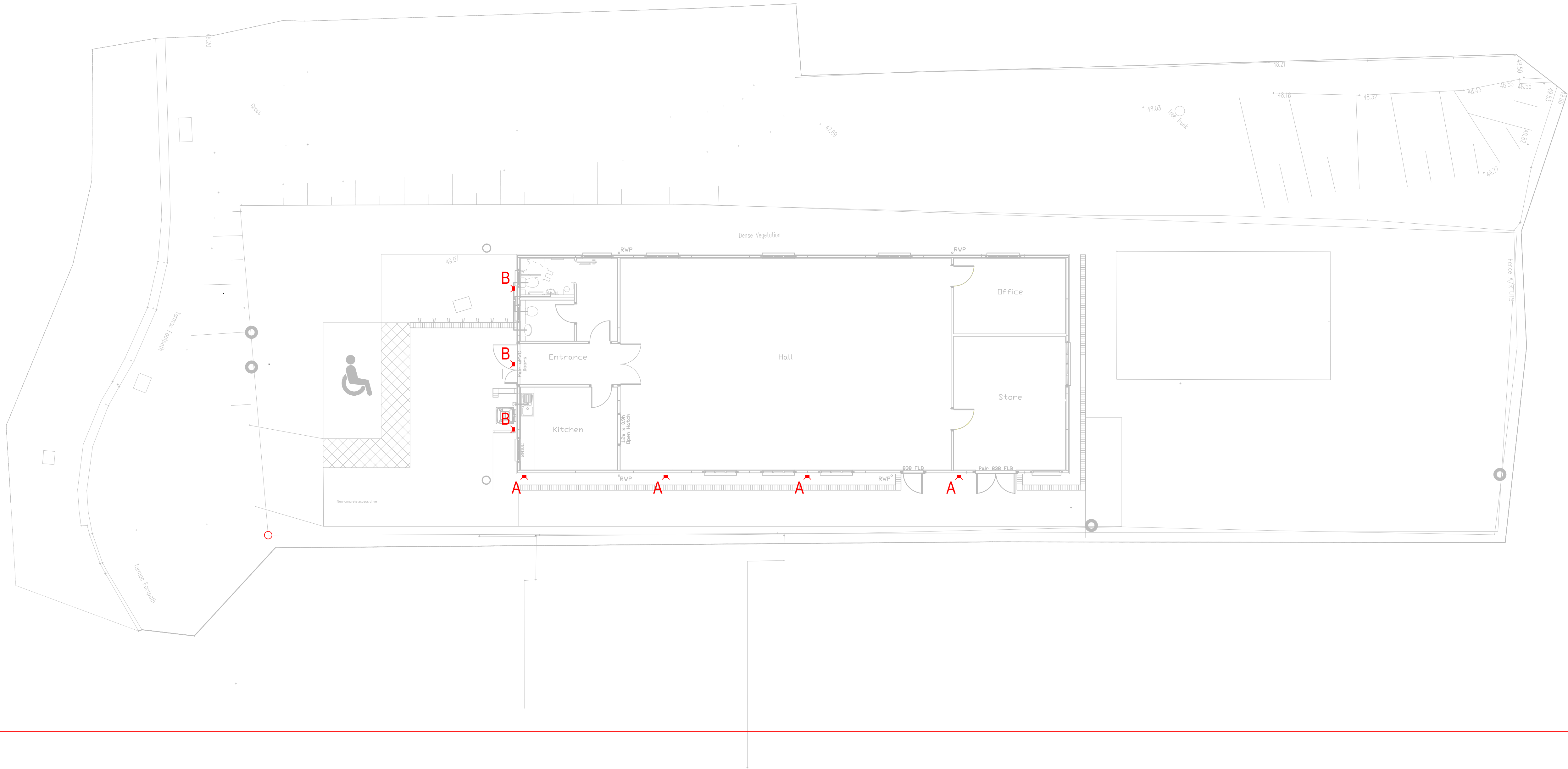
CLIENT
Light on Line LTD

PROJECT
Scout Hut - 18 St Catherines Road

OPPORTUNITY NUMBER
043125-00019

DRAWING TITLE
Lighting Layout Proposal
External Lighting - No Ramp

DESIGNER PC	PM NC	DATE 19.02.25	REVISION 01
SCALE 1:100 @ A1	CHECKED -	DWG No. N/A	

iGuzzini Illuminazione UK Ltd
Assist Way, Assist Business Park
Guildford, Surrey GU3 1NE, UK
T: 01483 468 000
F: 01483 468 001
E: info.uk@iguzzini.com
www.iguzzini.com



iGuzzini

GENERAL NOTES:
The lighting proposal is developed by the Lighting Solutions Department of iGuzzini in operational, technical and organizational autonomy, upon information provided by the Applicant, who is responsible for the information supplied for the development of the Lighting Concept.
The position of the lighting fixtures is for indicative purposes only. On-site tests are recommended for a better development of the lighting project.
The lighting results have an indicative value only and may differ from the real situation.
iGuzzini does not take any responsibility for the implementation of the project.

FIRE SAFETY and BUILDING REGULATION:
iGuzzini doesn't guarantee compliance of the proposed lighting fittings and lighting layout with The Building Regulation, specifically (but not only) in relation to Part B, Part C, Part L and Part P. It is up to the client or third party to verify that iGuzzini proposed lighting fittings and lighting layout comply with The Building Regulations and they are fit for purpose, with particular attention to Fire Safety Approved Document B and Conservation of fuel and power Approved Document L. iGuzzini doesn't take any responsibility for the installation of lighting fittings and lighting proposal not compliant with the above mentioned regulations.

EXIT SIGNS:
The lighting proposal doesn't include illuminated exit and emergency signs. It is assumed that the client or the contractor will install these as needed. See also emergency lighting note.
In case iGuzzini is required to provide illuminated exit and emergency sign, the client is to provide the exact quantities of illuminated signs required, specifying mounting types (recessed, ceiling mounted, pendant, wall mounted) and the arrow direction for each sign. In case iGuzzini is required to indicate illuminated exit sign on the drawing, client should also mark up position of required exist signs in addition to the information above.