

Propose G.F. Plan

WALLS: Pebble dash finish to new blocks wall to match with existing or to the satisfaction of Local Authority.

ROOF: New flat roof to 1st. floor rear extension with mineral felt.

WINDOWS: White U.P.V.C. double glazed doors and windows to match with existing.

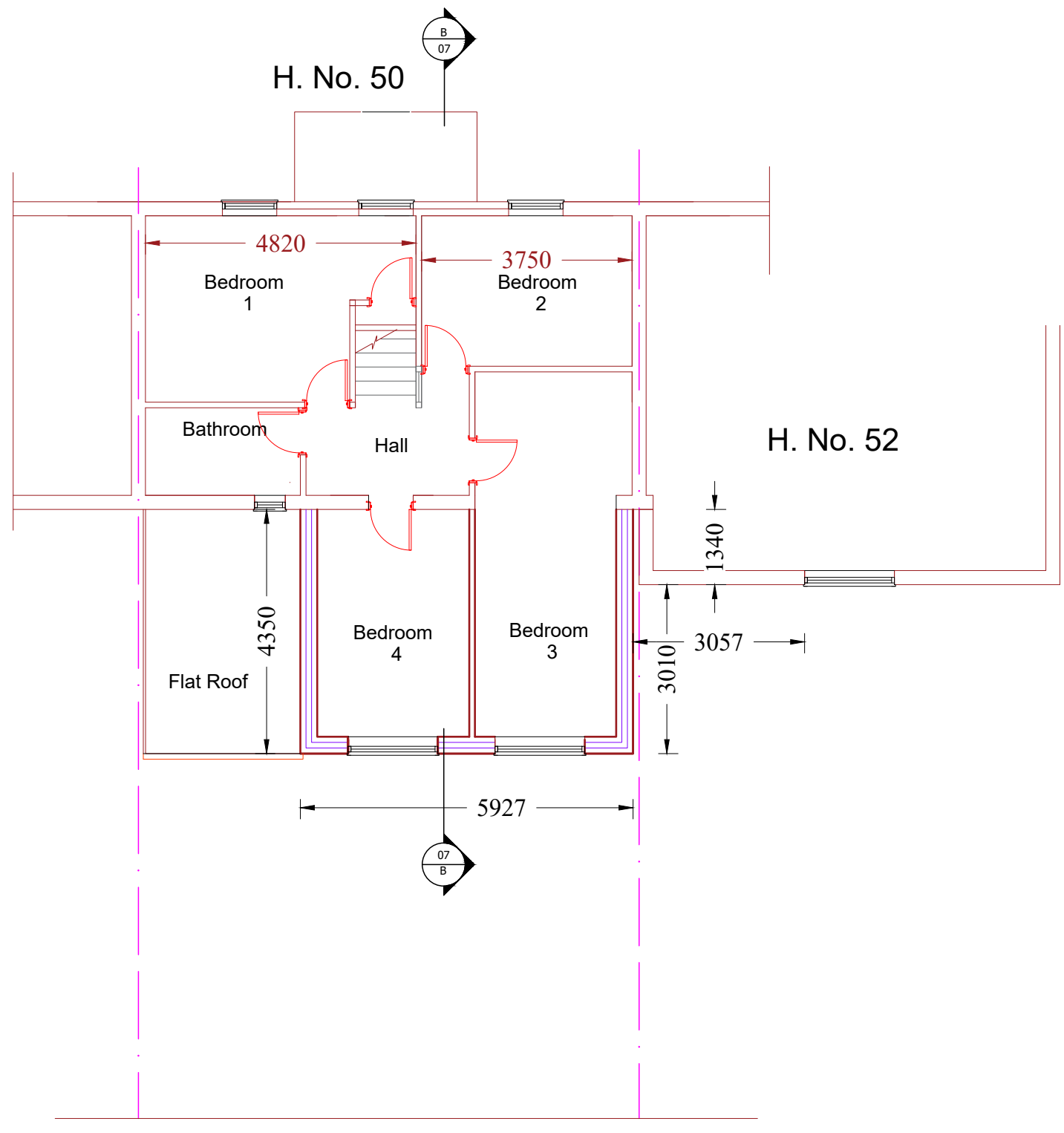

Proposed 1st. Floor Plan

☐ FOR COMMENT ☐ FOR PLANNING PERMISSION ☐ FOR BUILDING REGULATIONS



Malik Enterprises
Architectural Service

30 Carlton Drive, Wigston,
Leicestershire UK LE18 1DF
M: 07808 266330
E : tanvir@malikenterprises.co.uk

PROJECT: Proposed 1st. floor rear extension.

LOCATION: 50 Langmead Road, Hayes. UB3 2HD

CLIENT: Mr. Aslam Ansari

TITLE: Proposed Plans

DATE: Oct. 2025

SHEET: A3

DRAWING No: ME 6425-05

SCALE: 1:100