

Town Centre West

Transport Assessment Addendum (December 2025)

This Addendum identifies and replaces specific paragraphs within the original *Transport Assessment (December 2016)* for Town Centre West. The revisions reflect the loss of one car parking space within the Block 1 basement to accommodate a transformer and the allocation of two existing car parking spaces for maintenance purposes. This transformer is an operational requirement for the Energy Centre and is critical to the effective operation of the St. Andrew's Park District Heat Network.

Car Parking Sub-Section (Page 10)

The Paragraph and first bullet point at the top of Page 10 of the Transport Assessment (December 2016) state:

"In accordance with the guidance, it is considered that the TCW can provide a total of 175 spaces as per the following numbers:

- *Block 1, 96 apartments – 48 spaces at 0.5 spaces per apartment"*

This text is replaced with the following via this Transport Statement Addendum:

"In accordance with the guidance, it is considered that the TCW can provide a total of 174 spaces as per the following numbers:

- *Block 1, 96 apartments – 45 spaces at 0.5 spaces per apartment and 2 spaces allocated for the Energy Centre maintenance purposes. Total – 47 spaces".*

Section 3.3 of the Transport Assessment 'Swept Path Analysis' (Page 11)

The plan reference referred to in the first bullet point of Section 3.3 on Page 11 of the Transport Assessment (December 2016) states:

- *"5105977-ATK-UXB-TCW-DR-5001 - Block 1 Proposed Car Park Path"*

This text is replaced with the following via this Transport Statement Addendum:

- *6365 TR001 - Vehicle Swept Path Analysis – Proposed Access Arrangements (3 Sheets)*

Appendix C – Block 1 Proposed Car Park Path (Only)

Plan ref. 5105977-ATK-UXB-TCW-DR-5001 in Appendix C is replaced with Plan ref. 6365 TR001 to be added once available from Caneparos. A copy of this swept path analysis lan ref. 6365 TR001 is enclosed at Appendix 1 of this Transport Statement Addendum

Appendix 1 – Vehicle Swept Path Analysis

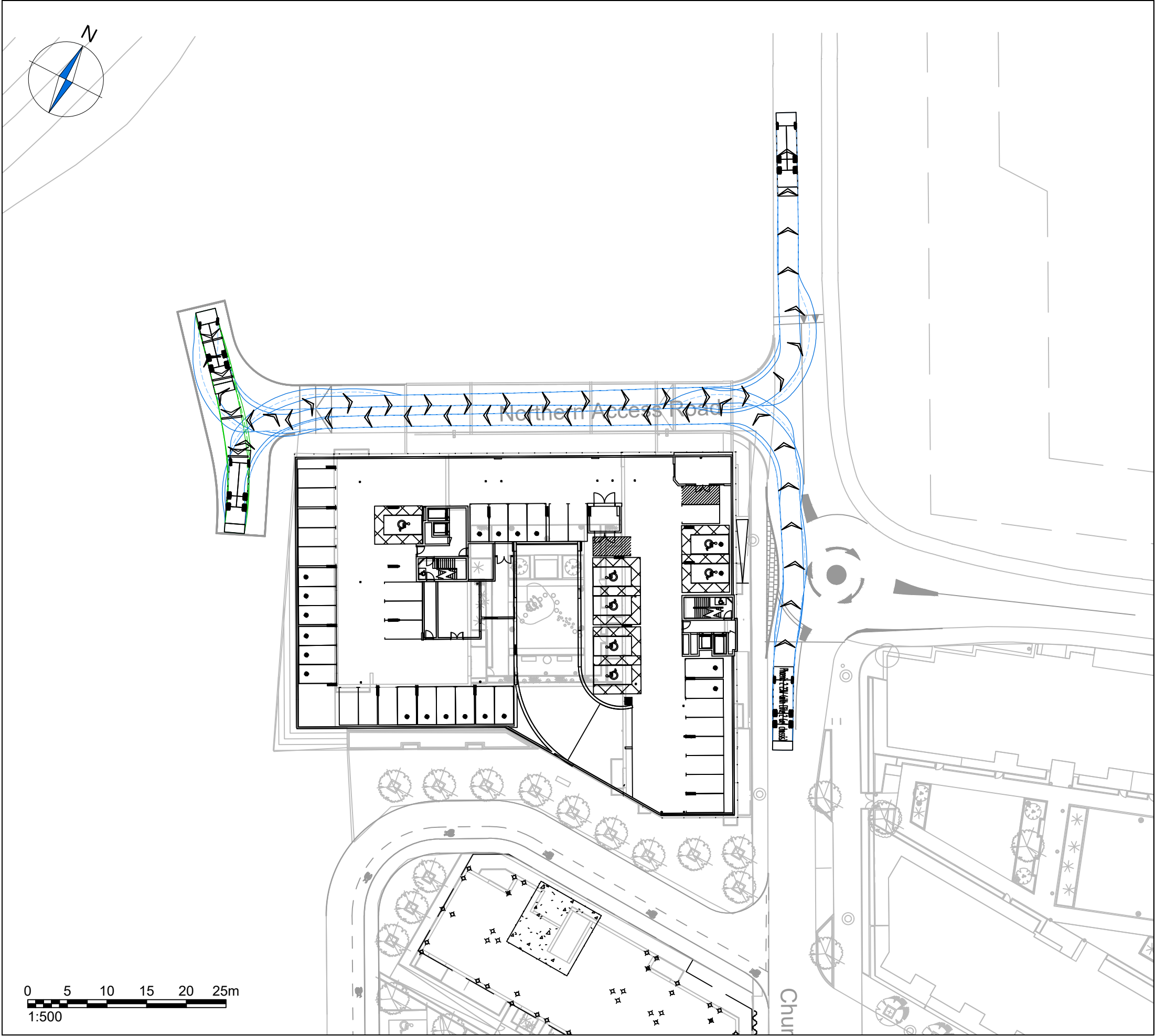

NOTES

- 1. This drawing to be read & printed in colour.
- 2. This drawing is for illustrative purposes only.
- 3. Design speed for all vehicle swept paths is 5kph.
- 4. Stationary steering has not been used on this drawing.

PHOENIX 2-23W WITH ELITE 6X4 CHASSIS

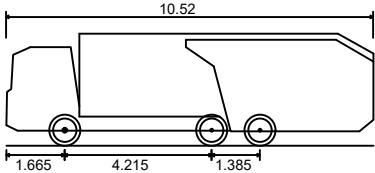

Overall Length	10.520m
Overall Width	2.530m
Overall Body Height	3.211m
Min Body Ground Clearance	0.416m
Track Width	2.530m
Lock to Lock Time	4.00s
Kerb to Kerb Turning Radius	9.950m



Rev	Details	REVISION HISTORY	Drawn	Checked	Date
...
Status: <input checked="" type="checkbox"/> Preliminary <input type="checkbox"/> Detailed <input type="checkbox"/> As Built					

Client:
Brighton STM Developments Limited

Project:
Town Centre West

Drawing Title:
Vehicle Swept Path Analysis
- Proposed Access Arrangement -
Refuse Vehicle

Scale:	1:500	Size:	A3
Drawn by:	JS	Checked by:	CC
Approved by:	CC	Date:	12.12.2025



CANEPARO
ASSOCIATES
Transport Planning & Highway Design
21 Little Portland Street • London • W1W 8BT • Tel. 020 3617 8200

Scheme Ref:	Drawing No:	Sheet :	Rev:
6365	TR001	1 of 3	...

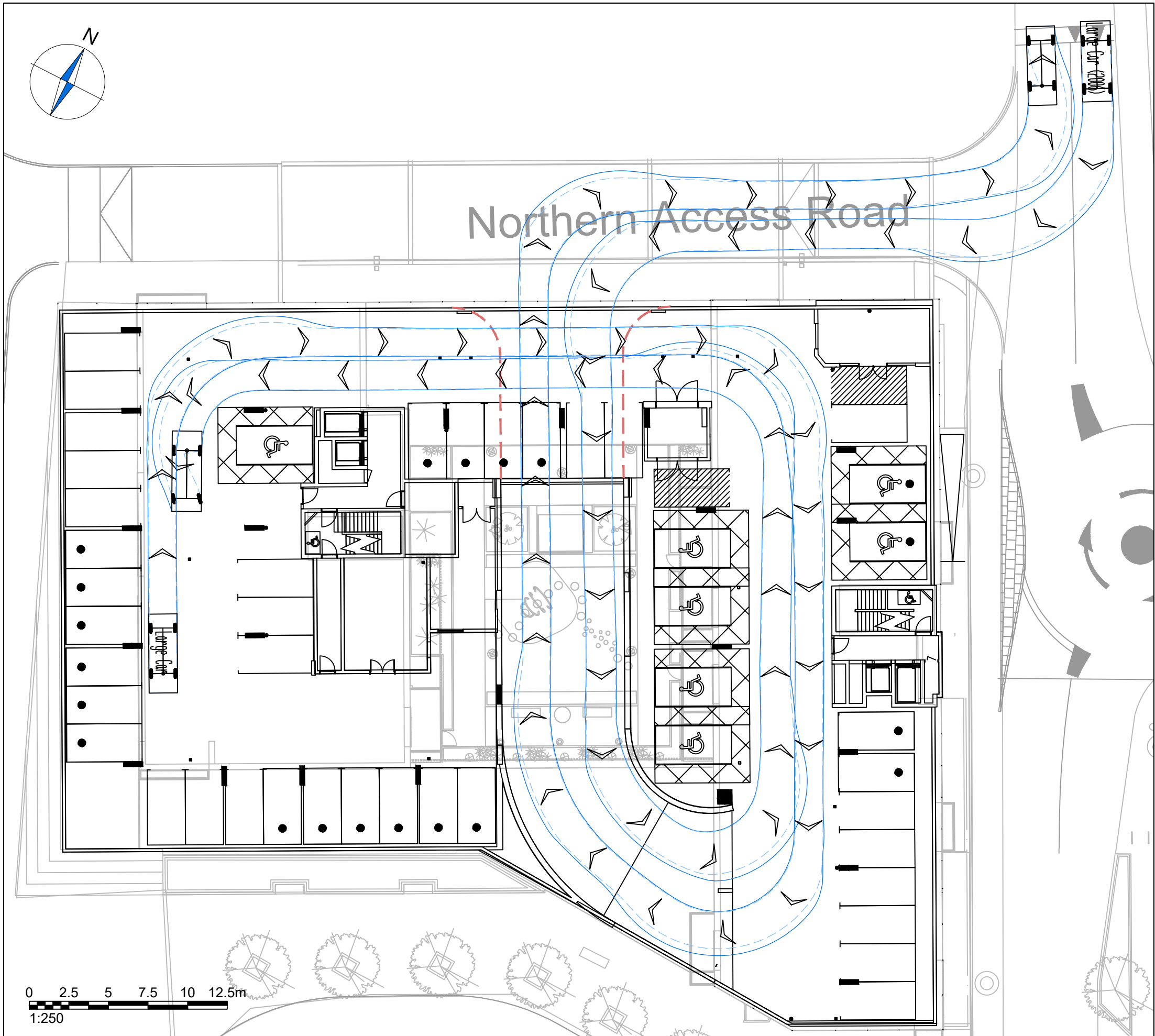

NOTES

- 1. This drawing to be read & printed in colour.
- 2. This drawing is for illustrative purposes only.
- 3. Design speed for all vehicle swept paths is 5kph.
- 4. Stationary steering has not been used on this drawing.

LARGE CAR

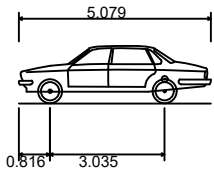

Overall Length	5.079m
Overall Width	1.872m
Overall Body Height	1.525m
Min Body Ground Clearance	0.310m
Max Track Width	1.831m
Lock to Lock Time	4.00s
Kerb to Kerb Turning Radius	5.900m

Forward Gear Reverse Gear

Rev	Details	REVISION HISTORY	Drawn	Checked	Date
...
Status: <input checked="" type="checkbox"/> Preliminary <input type="checkbox"/> Detailed <input type="checkbox"/> As Built					

Client:
Brighton STM Developments Limited

Project:
Town Centre West

Drawing Title:
Vehicle Swept Path Analysis
- Proposed Access Arrangement -
Large Car

Scale:	1:250	Size:	A3
Drawn by:	JS	Checked by:	CC
Approved by:	CC	Date:	12.12.2025

CANEPARO ASSOCIATES
Transport Planning & Highway Design
21 Little Portland Street • London • W1W 8BT • Tel. 020 3617 8200

Scheme Ref:	Drawing No:	Sheet :	Rev:
6365	TR001	2 of 3	...



NOTES

- 1. This drawing to be read & printed in colour.
- 2. This drawing is for illustrative purposes only.
- 3. Design speed for all vehicle swept paths is 5kph.
- 4. Stationary steering has not been used on this drawing.

LARGE CAR

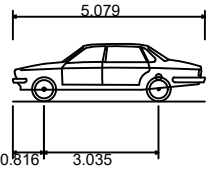

Overall Length	5.079m
Overall Width	1.872m
Overall Body Height	1.525m
Min Body Ground Clearance	0.310m
Max Track Width	1.831m
Lock to Lock Time	4.00s
Kerb to Kerb Turning Radius	5.900m

Forward Gear Reverse Gear

Rev	Details	REVISION HISTORY	Drawn	Checked	Date
...
Status: <input checked="" type="checkbox"/> Preliminary <input type="checkbox"/> Detailed <input type="checkbox"/> As Built					

Client:
Brighton STM Developments Limited

Project:
Town Centre West

Drawing Title:
Vehicle Swept Path Analysis
- Proposed Access Arrangement -
Large Car

Scale:	1:250	Size:	A3
Drawn by:	JS	Checked by:	CC
Approved by:	CC	Date:	12.12.2025

CANEPARO ASSOCIATES
Transport Planning & Highway Design
21 Little Portland Street • London • W1W 8BT • Tel. 020 3617 8200

Scheme Ref:	Drawing No:	Sheet :	Rev:
6365	TR001	3 of 3	...