

C:\USERS\MYLESRABBIT\GE\ONEDRIVE - RABBIT\GE MESTROM LTD\RM\2024\2426\_LEOMB\_EXA01 CAD\02 SHEET LAYOUT\EXA\_2421\_110.DWG

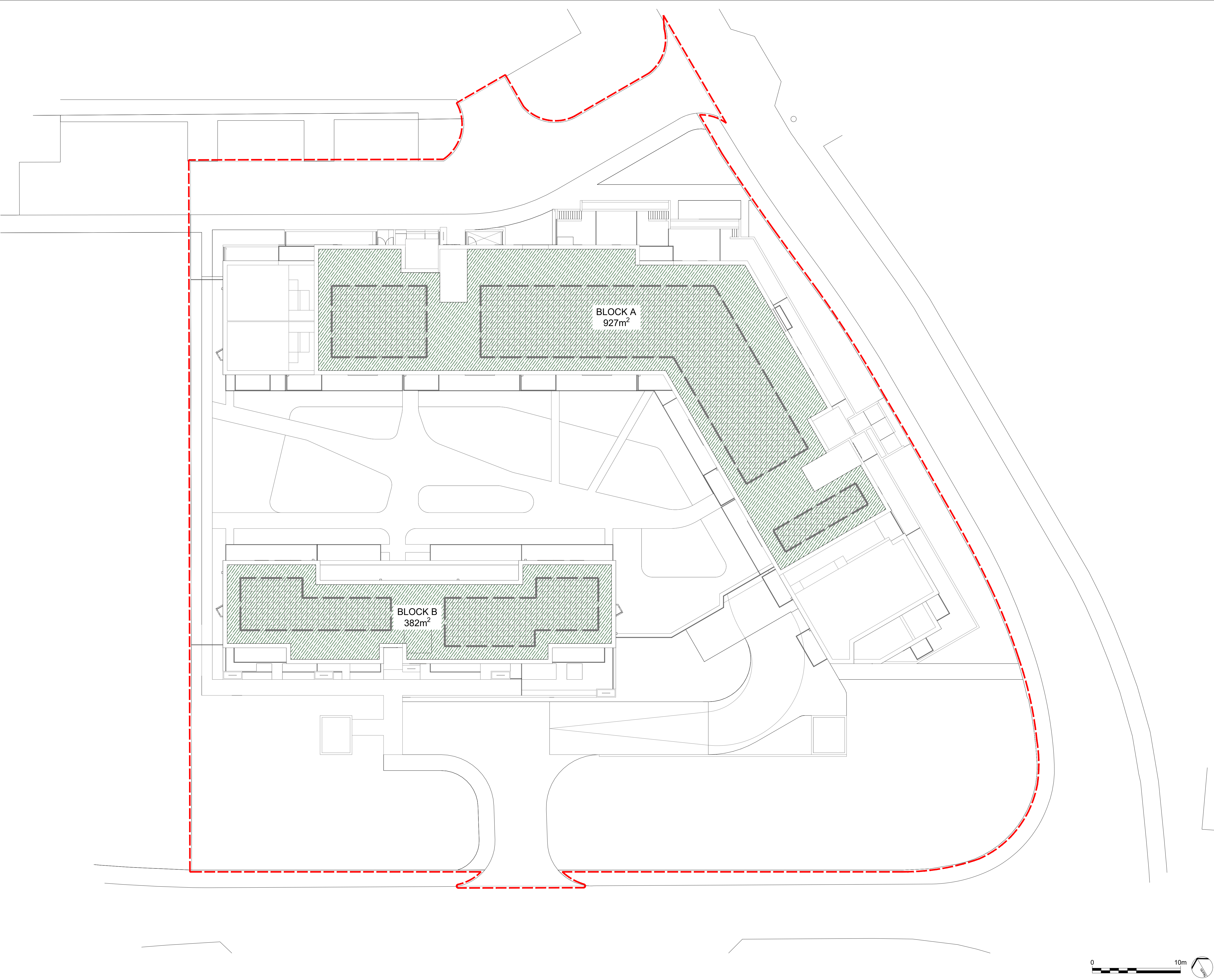

No dimensions are to be scaled from this drawing.  
All dimensions are to be checked on site.  
Area measurements for indicative purposes only.

This drawing is the property of Exterior Architecture Ltd.  
No part of the drawing may be reproduced in any manner  
without permission from Exterior Architecture Ltd.

Client

VSM Estates (Uxbridge) Ltd

LEGEND

Site Boundary

Extensive Green Roofs

Extent of Extensive Green Roofs  
BauderGREEN Flora 3 Seed Mix  
*Refer to ExA\_2421\_701*

Extent of PV panels

BauderGREEN Flora 3 Seed Mix Details

- UK Native British Provenance Seed Mix
- 49 Species
- 35 of the Wildflowers are classed as 'RHS perfect for pollinators'
- Low growing to medium height
- 65%perennial wildflowers, 20% annuals & 15% grasses
- Shade tolerant species to give coverage in less sunny positions i.e under PV panels

-	PLANNING	26.07.2024
Rev	Description	Date

EXTERIOR  
ARCHITECTURE

LONDON  
Unit 17.1, The Leather Market, 11-13 Weston Street, London, SE1 3ER  
MANCHESTER  
Studio 537, The Royal Exchange, St Anns Square, Manchester, M2 7DH  
E-MAIL office@exteriorarchitecture.com  
WEB www.exteriorarchitecture.com

Project title

LAND EAST OF MONS BLOCK,  
UXBRIDGE

Drawing title

EXTENSIVE GREEN ROOFS

Issued By	London	T: 020 7978 2101
Scale	1:200 @ A1	Drawn ExA
Status	PLANNING	Checked RM
Date	26.07.2024	Approved LP
Drawing number	ExA_2421_110	Revision
		-