

KEY

- 240 mins REI
- 120 mins REI
- 90 mins REI
- 60 mins REI
- 30 mins REI
- Vented Area
- AOV AOV to Upper Floors
- B AOV AOV to Basement

- FD 30s fire door
- FD 60s fire door

A high level AOV in the top storey of the stairway having a minimum free area of 1m² is required. This applies to entire height of the building.

External side of this shaft wouldn't need protection, as the staircase stops at ground floor.

A smoke shaft at least 1.5m² is required, need to indicate where the smoke shaft will locate. This applies to the entire height of the building.

Separation of staircase at ground floor

All residential apartments are to be provided with a Grade D LD1 fire alarm and detection system designed, installed and commissioned in accordance with BS5839-6:2013. The common residential areas to be provided with an L5 system.

The elements of structure are required to be 90 mins fire resistance in terms of load bearing capacity. This applies to entire height of the building.

External fire spread calculations to be performed in regards to relevant and/or notional boundaries.

Separation of staircase at ground floor

KEY

- 240 mins REI
- 120 mins REI
- 90 mins REI
- 60 mins REI
- 30 mins REI
- Vented Area
- AOV AOV to Upper Floors
- B AOV AOV to Basement

- FD 30s fire door
- FD 60s fire door

FD60S
Rated
Door w/
smoke
seal

PROJECT REF:
22338 St Modwen - St Andrews Park Uxbridge

TITLE:
FIRE STRATEGY DRAWING

DRAWN:
ZH/QA-KH

DATE:
10/12/2021

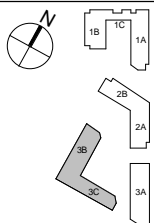

P1 RET SAS 24.11.21 Preliminary Fire Strategy Drawings
REV BY CHKD DATE AMENDMENT DETAILS

project
Uxbridge Town Centre West
St. Andrew's Park, Uxbridge

client
St. Modwen Homes

FraserBrownMacKenna Architects
15-16 Featherstone St. London EC1Y 8SL www.fbmarchitects.com
T:020 7251 0543

drawing title
Block 3B&3C Level 00

PRELIMINARY

scale
1:100 @ A1
1:200 @ A3
drawn by
KK
checked by
SAS
date of first issue
24.11.21
revision
R9110-FBM-21-00-DR-A- 1640
DRAWING NUMBER
P1

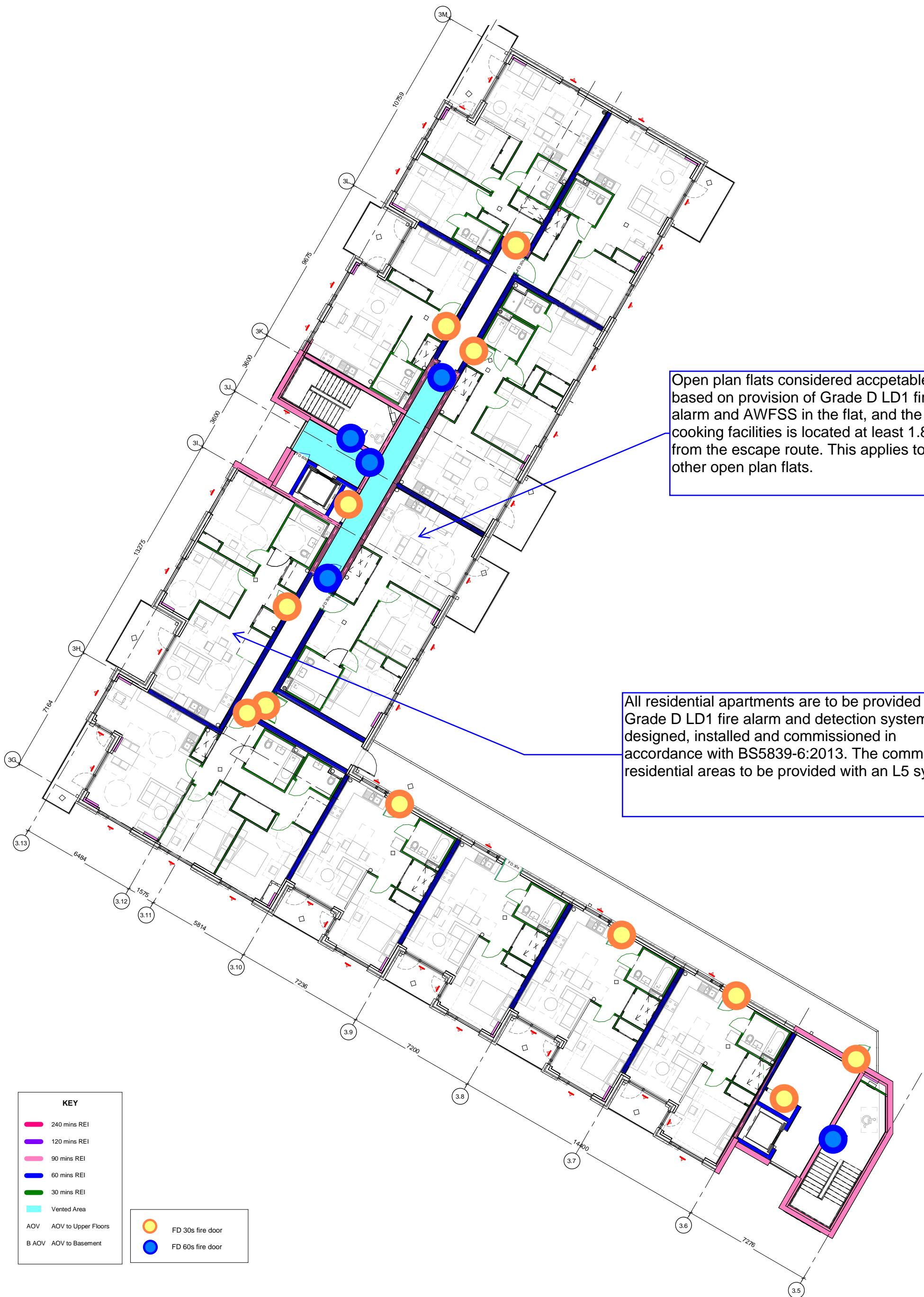

KEY	
—	240 mins REI
—	120 mins REI
—	90 mins REI
—	60 mins REI
—	30 mins REI
—	Vented Area
AOV	AOV to Upper Floors
B AOV	AOV to Basement

●	FD 30s fire door
●	FD 60s fire door

FD60S
Rated
Door w/
smoke
seal

PROJECT REF:
22338 St Modwen - St Andrews Park Uxbridge

TITLE:
FIRE STRATEGY DRAWING

DRAWN:
ZH/QA-KH

DATE:
10/12/2021

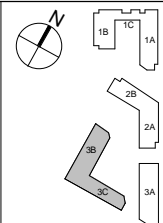

P1	RET	SAS	24.11.21	Preliminary Fire Strategy Drawings
REV	BY	CHKD	DATE	AMENDMENT DETAILS

project
Uxbridge Town Centre West
St. Andrew's Park, Uxbridge

client
St. Modwen Homes

FraserBrownMacKenna Architects
15-16 Featherstone St. London EC1Y 8SL www.fbmarchitects.com
T:020 7251 0543

drawing title
Block 3B&3C Level 02

PRELIMINARY

scale
1:100 @ A1
1:200 @ A3

drawn by
KK

checked by
SAS

date of first issue
24.11.21

project
R9110-FBM-21-02-DR-A- 1642

company
year
level
type
role
number

revision
P1