

8 Thompson Road
Existing Floor plan

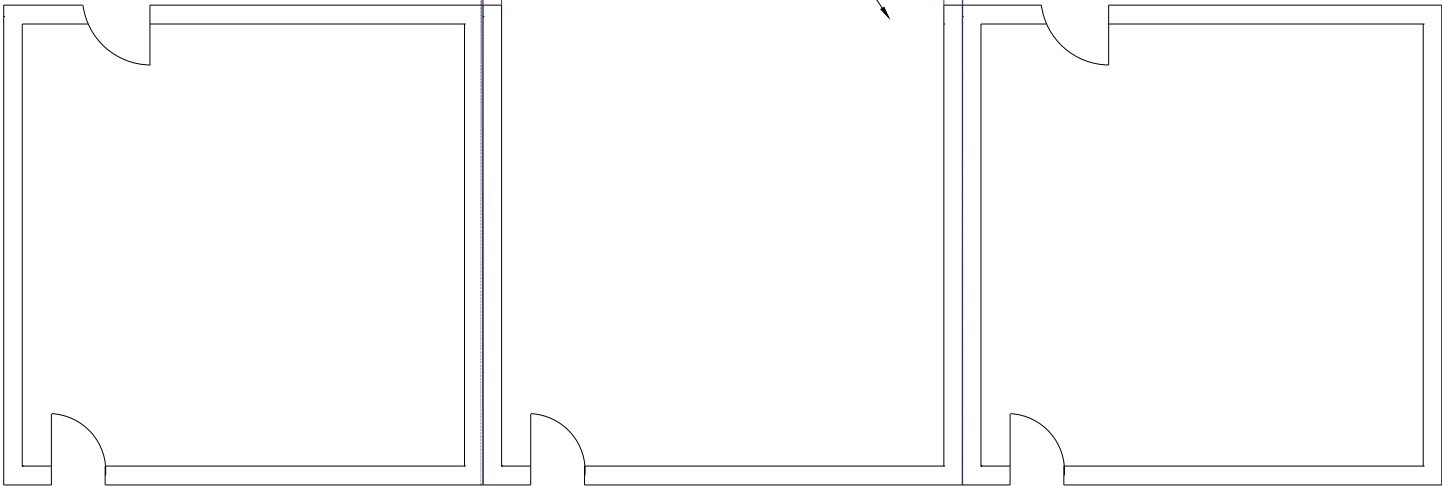

9 Thompson Road

8 Thompson Road
Poposed Floor Plan

7 Thompson Road

Legend:
Site plan outline

8 Thompson Road - Floor Plan Scale: 1:100 @ A3

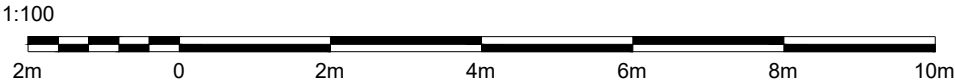

The extension will not be within 7 m of any boundary of the curtilage of the dwellinghouse oppose the rear wall of the dwellinghouse.

As a result of the works, the total area of the ground covered by buildings within the curtilage of the dwellinghouse WILL NOT exceed 50% of the total area of the curtilage.

Proposed new rear extension. 1 m depth, 2.4 m height with built up mineral felt flat roof system. All building materials and decorations are to match the existing style.

All measurements are to be checked on-site for validation and authenticity with layouts indicative only

No amendments or copies are to be produced without prior consent from Rapleys LLP. Do not scale from drawing

Ref	Date	Revision

Client
Annington Homes

Job Title
Annington Homes Site,
Grays Rd, Uxbridge,
London, UB10 0QZ

Drawing Title
Existing & Proposed Floor
Layout

Scale	Size	Date	Drawn
1:100	A3	April 2023	DH



RAPLEYS LLP
33 Jermy Street,
LONDON SW1Y 6DN
Tel: 0370 777 6292
www.rapleys.com