

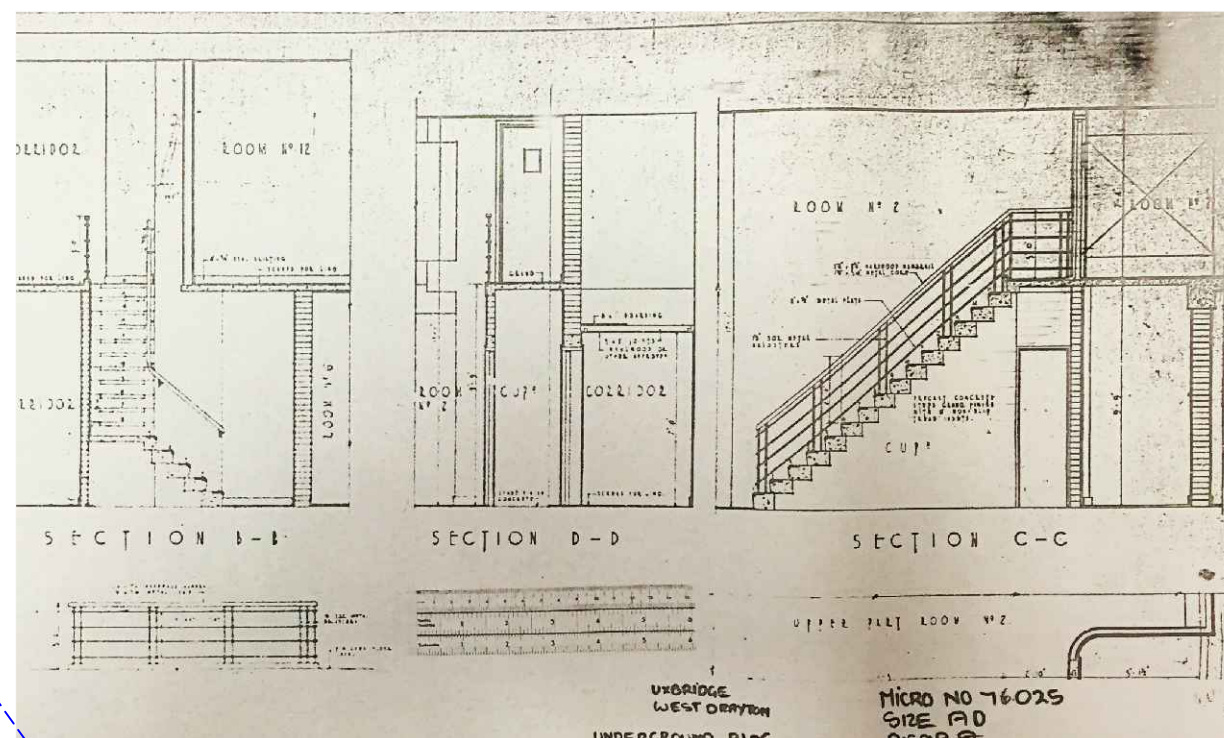

BUNKER PLAN SHOWING LOCATION OF HANDRAILS
As Proposed, 1:500

As Proposed, 1:500



EXTRACT FROM ARCHIVAL DRAWING SHOWING HISTORIC RAILING

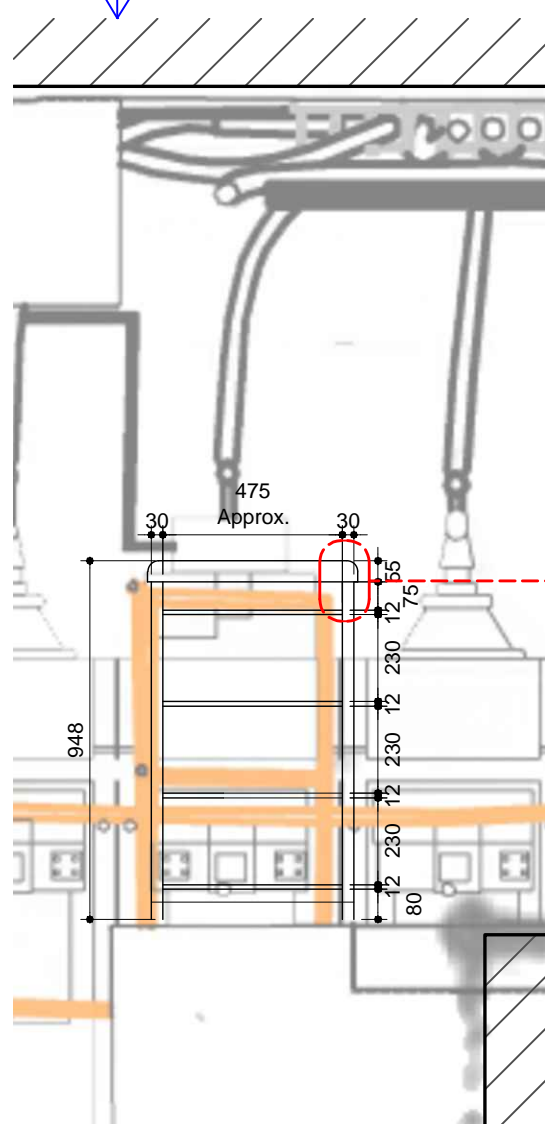

Y PLANT ROOM - HANDRAIL DETAIL
As Proposed, 1:50

As Proposed, 1:50

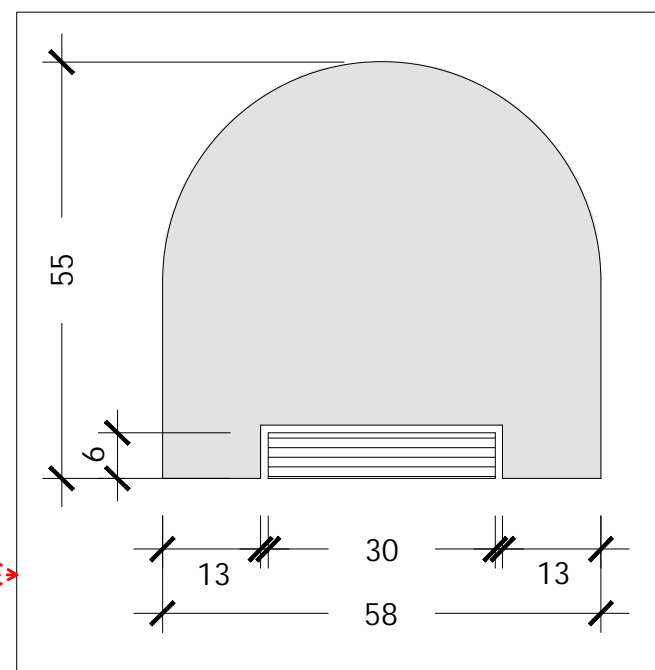

TOP HANDRAIL DETAIL
As Proposed, 1:1

As Proposed, 1:1

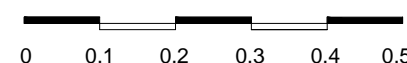

Rails 50 x 12mm

Standards 30m2

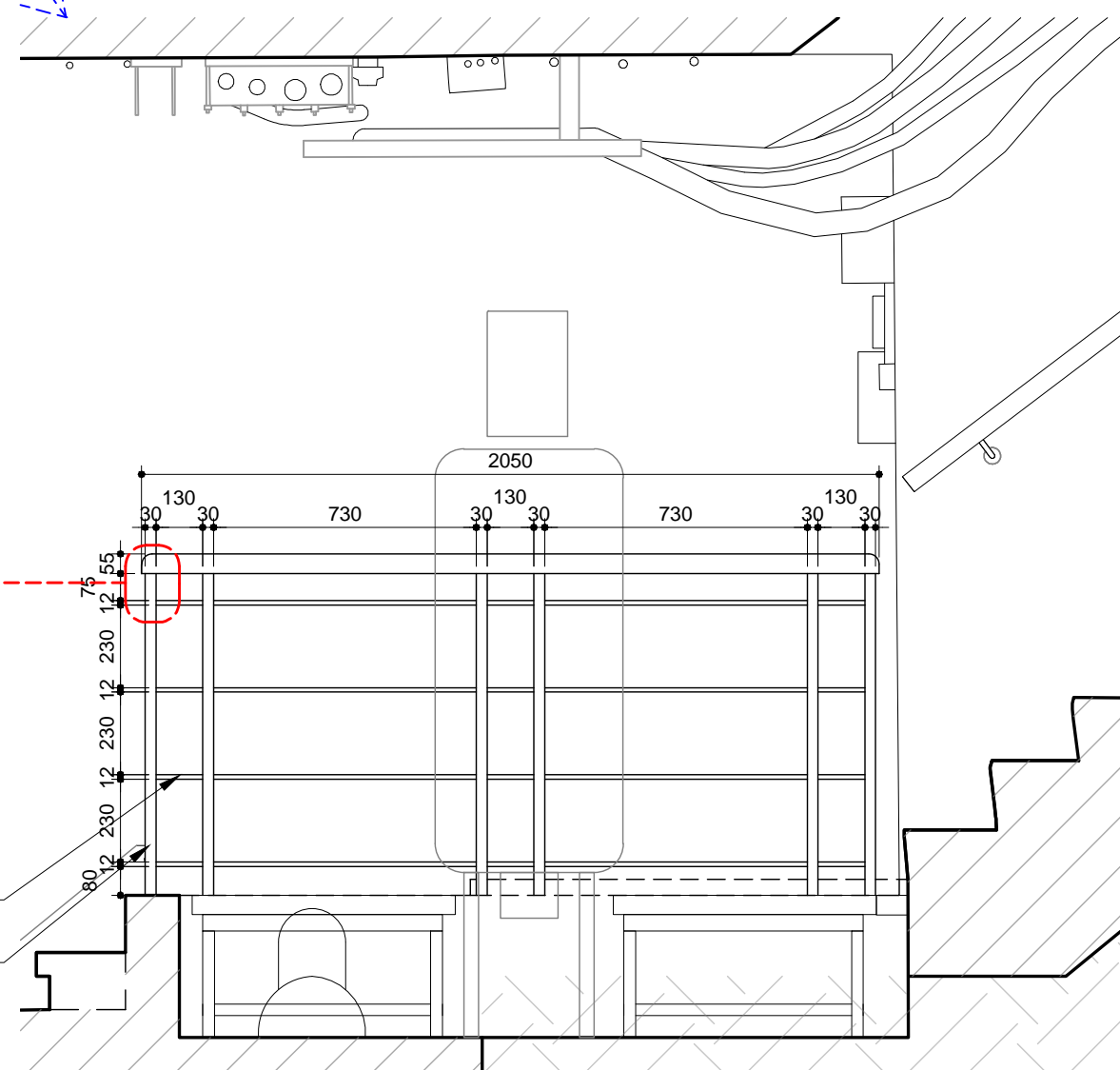

X PLANT ROOM - HANDRAIL DETAIL
As Proposed, 1:50

As Proposed, 1:50



- | | |
|----|---|
| X | GENERAL NOTES: |
| 1. | Do not scale from this drawing. Use figured dimensions only. Contractor to check dimensions on site prior to construction and notify CA of any discrepancy. |
| 2. | This drawing is to be read in conjunction with all other relevant contract drawings, specifications & Schedules. |
| 3. | If in doubt: Ask |
| 4. | Martin Ashley Architects shall be notified in writing of any discrepancies. |

KEY:



Original survey drawing from The Downland Partnership Ltd dated in October 2018.

A	03.03.22	Drawing Status changed	A
-	.	First Issue	.
Rev.	Date.	Reason For Issue.	C

Status

Statutory Approval



46-48 London Road, Twickenham, Middlesex, TW1 3RJ
T +44 (0) 20 8948 7788
www.ma-arch.co.uk

Client	LONDON BOROUGH OF HILLINGDON
--------	------------------------------

Project	BATTLE OF BRITAIN BUNKER
---------	--------------------------

Title
HISTORIC RAILING AS PROPOSED

Date	Scale	Revision
July 2021	1:50 @ A3	
Checked By	Drawn By	
AH	LG	
Drawing Number		
2270/01/20		A