

DO NOT SCALE FROM THIS DRAWING. All dimensions must be verified by the main contractor before the commencement on site of any item of work or the preparation of shop drawings for their own work or that of sub-contractor or suppliers. This drawing is to be read in conjunction with all relevant documents. Any queries or discrepancies must be reported immediately to the architect. This document is copyright of DDWH Architects Ltd.

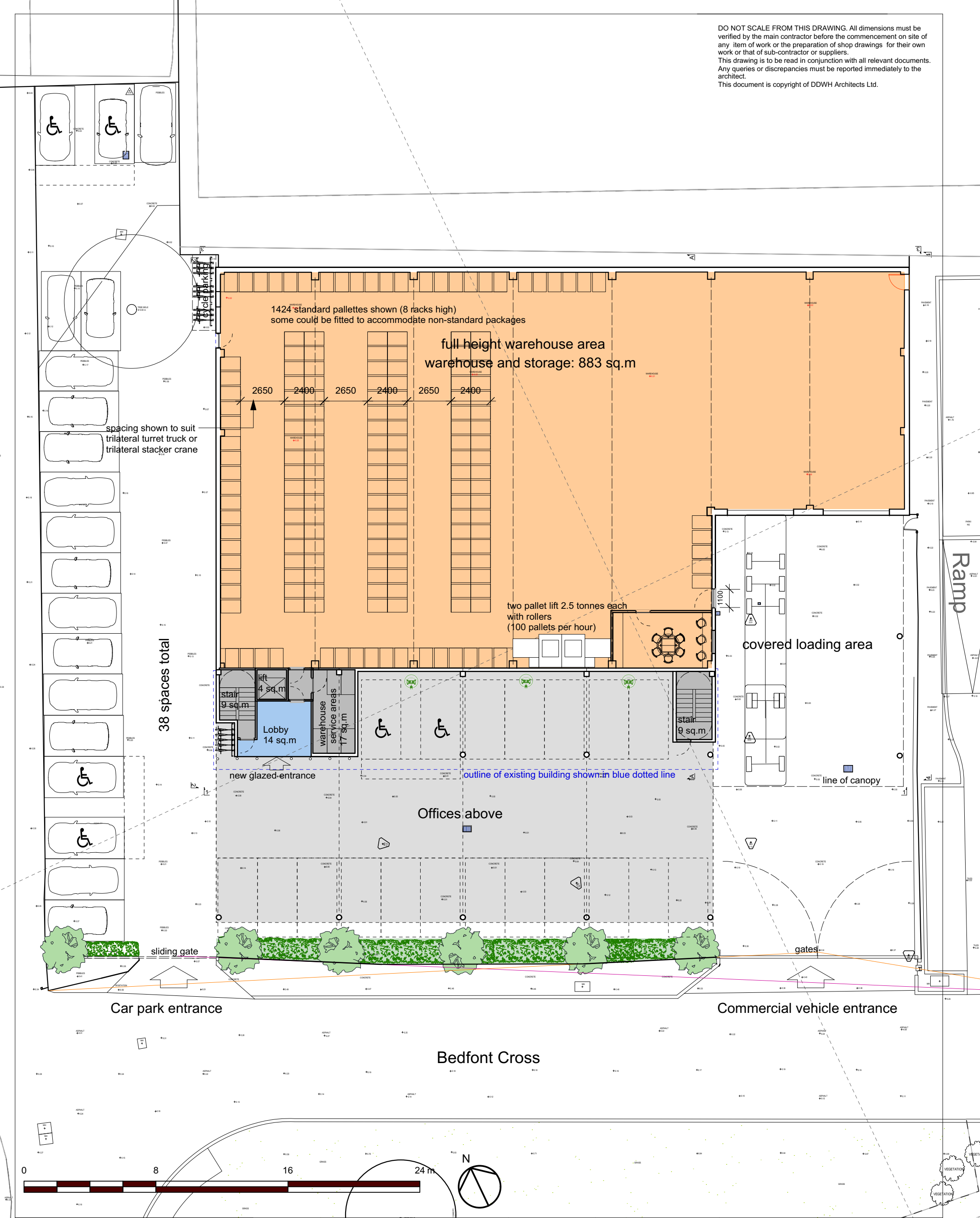

Rev	Date	Notes	Project:	Date:	Architecture
a	May 2022.	entrance amended	NNR Logistics Office and Warehouse	May 2022	Urban design
b	June 2022	racking amended	Client:	Scale:	Interior design
c	January 2023	frontage redesigned	NNR Global Logistics	1:200 at A3	
d	March 2023.	updated with survey	Drawing No:	Drawn:	
e	July 2023.	warehouse staff area added	237-201g	dd	
f	July 2023.	guest cycle spaces added	Drawing Title:		
g	Aug 2023	parking amended	Ground Floor Plan as Proposed		

7 Lovers Walk London N3 1JH
T: 020 8343 0156
F: 020 8346 0160
E: mail@ddwharchitects.com

ddwh
ARCHITECTS