

EXISTING GROUND FLOOR PLAN
SCALE 1:50

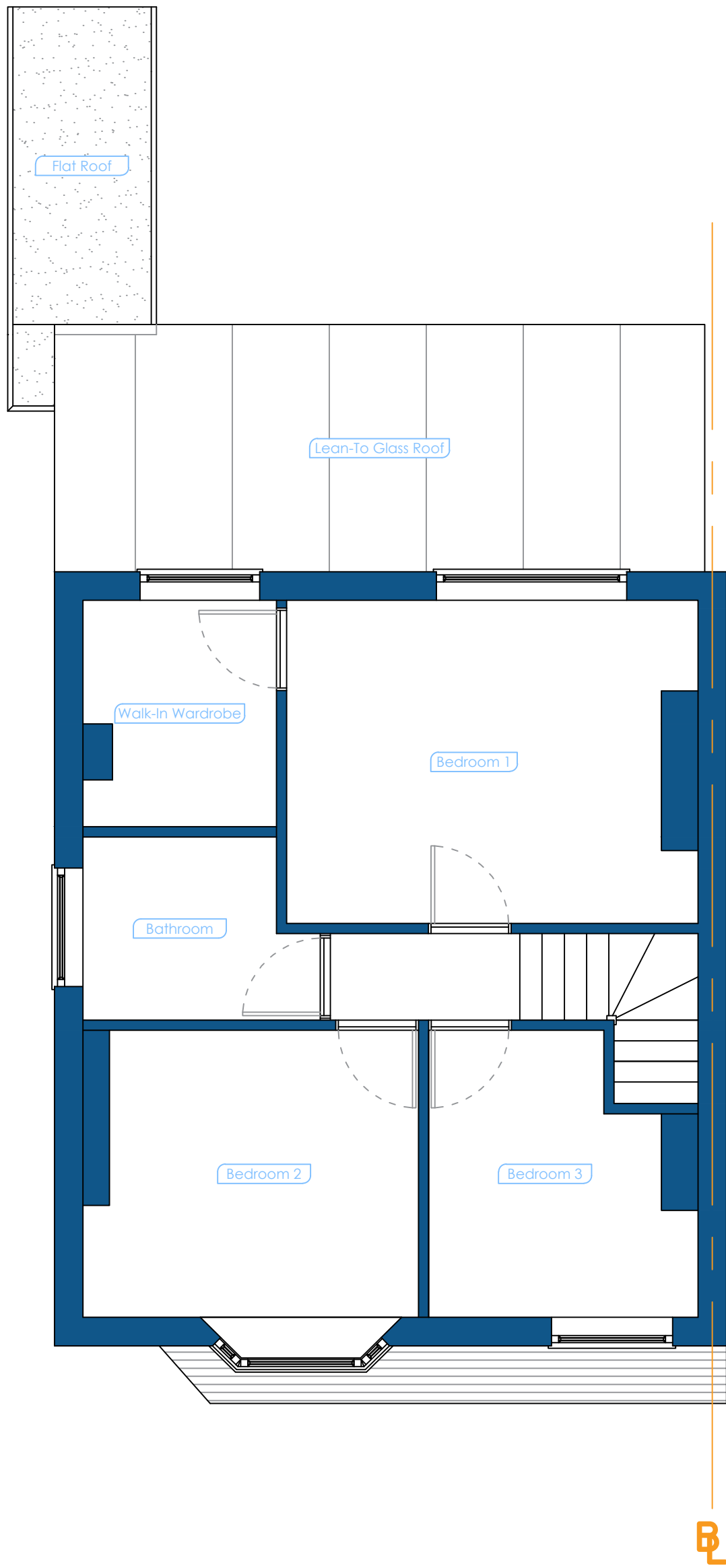

EXISTING FIRST FLOOR PLAN
SCALE 1:50



REV:	DESCRIPTION:	BY:	DATE:
STATUS:		For Planning Approval	
Knightsbridge Prime Development			
21 Colne Avenue West Drayton +44 7791 116 802 a_sahid@hotmail.com			
CLIENT:			
ARCHITECT:			
Mohammed Sahid			
SITE:			
22 Keith Road, Hayes UB3 4HW			
TITLE:			
Existing Floor Plans			
SCALE AT A2:	DATE:	DRAWN:	CHECKED:
1:50	27/10/25	MS	MS
PROJECT NO:	DRAWING NO:	REVISION:	
1.61	22KR-MS-002	A01	