

LOCATION PLAN

19 Courtfield Gardens, Ruislip, HA4 6JL, UK



01856 898 022  
www.UKPlanningMaps.com



Produced on 15 July 2025 from the Ordnance Survey National Geographic Database and incorporating surveyed revision available at this date.  
This map shows the area bounded by 509637 186602,509737 186602,509737 186702,509637 186702,509637 186602  
Crown copyright and database rights 2025 OS 100054135. Supplied by copla ltd trading as UKPlanningMaps.com a licensed Ordnance Survey partner (OS 100054135).  
Data licence expires 15 July 2026. Unique plan reference: v1E/1284411/1722420



This document has been prepared in accordance with the scope of Buildrite's appointment with its client and is subject to the terms of that appointment. It is confidential, addressed to and for the sole use and reliance of Buildrite's client. Buildrite accepts no liability for any use of this document other than by its client and only for the purposes, stated in the document, for which it was prepared and provided. No person other than the client may copy (in whole or in part) use or rely on the contents of this document, without the prior written permission of a Director of Buildrite. Any advice, opinions or recommendations within this document should be read and relied upon only in the context of the document as a whole. The contents of this document are not to be construed as providing legal, business or tax advice or opinion.

- Existing Structure
- Proposed Structure
- Demo Structure

Date	R.No.	Drawn By
18-07-2025	0	Shabbir

Client:  
Subhajit Ghosh

Address:  
19 Courtfield Gardens, Ruislip, HA4 6JL, UK

Title:  
Location Plan

Scale: 1:1250@A3



1 Aston Court, Kingsmead Business Park,  
Frederick Place, Loudwater, High Wycombe,  
HP11 1JU

TEL: +44 01494 973335  
Email: info@build-rite.co.uk  
Web: www.build-rite.co.uk

Drawing No.:    ARCH-001a

BLOCK PLAN

19 Courtfield Gardens, Ruislip, HA4 6JL, UK

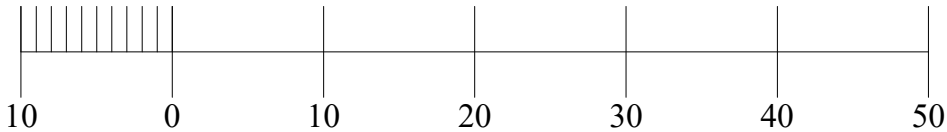
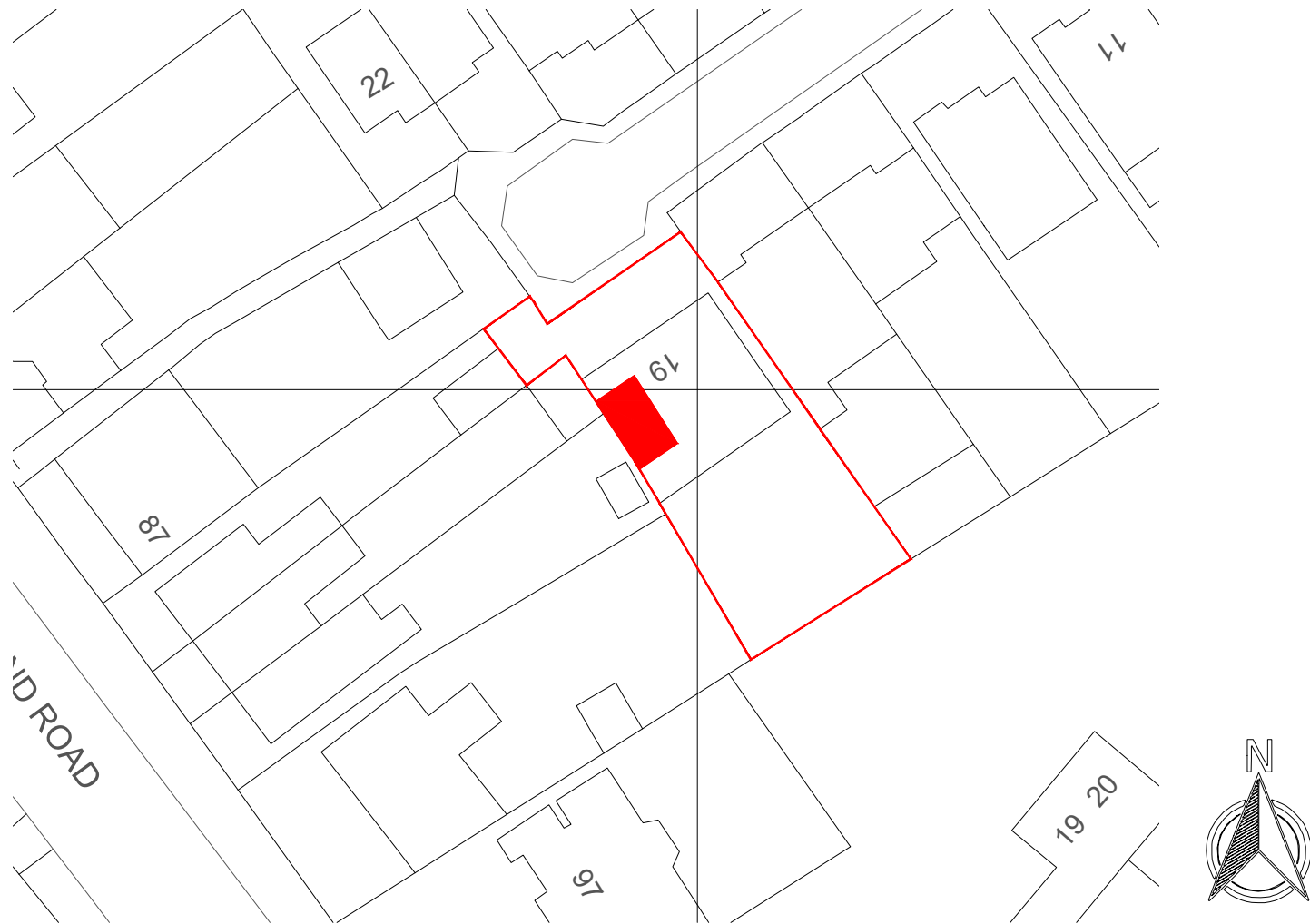

This document has been prepared in accordance with the scope of Buildrite's appointment with its client and is subject to the terms of that appointment. It is confidential, addressed to and for the sole use and reliance of Buildrite's client. Buildrite accepts no liability for any use of this document other than by its client and only for the purposes, stated in the document, for which it was prepared and provided. No person other than the client may copy (in whole or in part) use or rely on the contents of this document, without the prior written permission of a Director of Buildrite. Any advice, opinions or recommendations within this document should be read and relied upon only in the context of the document as a whole. The contents of this document are not to be construed as providing legal, business or tax advice or opinion.

- Existing Structure

Proposed Structure

Demo Structure

Date	R.No.	Drawn By
18-07-2025	0	Shabbir

Client:  
Subhajit Ghosh

Address:  
19 Courtfield Gardens, Ruislip, HA4 6JL, UK

Title:  
Block Plan

Scale: 1:500@A3



1 Aston Court, Kingsmead Business Park,  
Frederick Place, Loudwater, High Wycombe,  
HP11 1JU

TEL: +44 01494 973335  
Email: info@build-rite.co.uk  
Web: www.build-rite.co.uk

Drawing No.:    ARCH-002b