



#### DRAWING NOTES

1. filename: Stair Proposed Elevation.dwg
2. Do not scale from this drawing in either paper or digital form. Use figured dimensions only. Detailed site survey to be carried out to establish tolerances. Figured dimensions are in mm. All dimensions shall be verified on site before proceeding with the work. The architect shall be notified of any discrepancies.
3. This drawing has been produced for sole use on this project and is not intended for use by any other person or for any other purpose. © Copyright RSS (U.K.)
4. All printed copies should be made at 100% of the original page size. Use scale bars, where included, to check that the drawing has been printed to the intended scale as identified in the drawing title block.
5. This drawing is not intended for construction unless specifically described as such.
6. Setting out and details of existing structure to be verified on site

#### REVISIONS

REV	DATE	STATUS
P01	25.03.24	For planning

Changes since last issue:

-

#### Key Plan

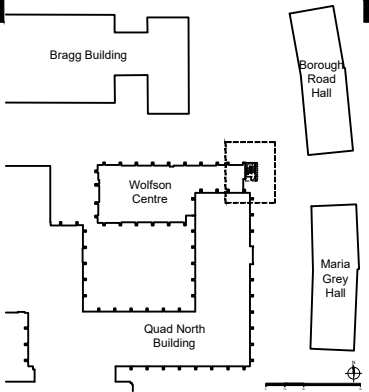

**rivingtonstreetstudio**

28 NAVIGATION ROAD LONDON E3 3TG

T : 020 7739 8945  
E : rss@rssa.co.uk [www.rivingtonstreetstudio.co.uk](http://www.rivingtonstreetstudio.co.uk)

job title **Brunel University Quad North Building. Escape Stair Extension**

drawing title **Proposed North Site Elevation**  
-

scale **1:200@A3**

drawn by	job no.	suitability	revision
RT/JY	1054	S3	P01

PROJECT	ORIGIN	VOLUME	LEVEL	TYPE	ROLE	NUMBER
BQN	RSS	00	ZZ	DR	A	1440