

ITEM	COMMENTS	HEALTH AND SAFETY IMPLICATION	RISK	ITEM	COMMENTS	HEALTH AND SAFETY IMPLICATION	RISK	SPECIFICS RISK ASSESSMENTS AND REGISTER	ITEM	COMMENTS	HEALTH AND SAFETY IMPLICATION	RISK
Cable Ties Used In Installation	Wherever possible electrical cables should not be allowed to trail over the floor. All cables and hoses should be left in a neat and tidy order.	Electrocution, tripping hazard, damage caused by other equipment running over cables.	High	Commando Sockets	Where equipment is mobile electrical connections should be made via Commando sockets.	Best practice, assists with easy movement and cleaning of equipment.	Low		Grids	Do not locate grills over gas oven ranges, either solid top or open top.	Unit will overheat and deteriorate, operators can scald themselves on the handles, difficult for operator to reach rear burners, cold burn themselves.	Medium
Bypass Valves	Water Softeners should be fitted with bypass valves so as to allow full use of the equipment being supplied during breakdowns and maintenance work.	Dishwashing by hand: poor sterilisation could lead to food poisoning.	Low	Safety Chain	Any flexible pipes fitted to gas appliances must be secured to a secure wall or floor mounting by suitably approved mobility restraints.	Non compliance with regulations, danger of gas leaks and explosion if gas hose or mountings are ruptured, death.	High		Water Boilers	Boilers will be fitted with overflows or drained drip trays and taken to a safe area. Commercial equipment is heavy. Attention should be given to equipment loading if installing above ground level. Customer to ensure that floors are strong enough to support weight when fully loaded.	Flooding causing damage to client's property.	Medium
Softener Overflows	All water connected water softeners, where an overflow exists, must be connected to a permanent waste outlet.	Flooding of overflow will cause damage to client property.	Medium	Fryers	Where fryers are located adjacent to ranges or at the end of a line of equipment, side screens will be fitted.	Injury to staff if water mixes with hot oil, this will result in splattering causing serious burns.	High		Structure		Collapses of floor causing costly damage and possible loss of life. Also rupturing of services which could lead to fire and explosions.	High

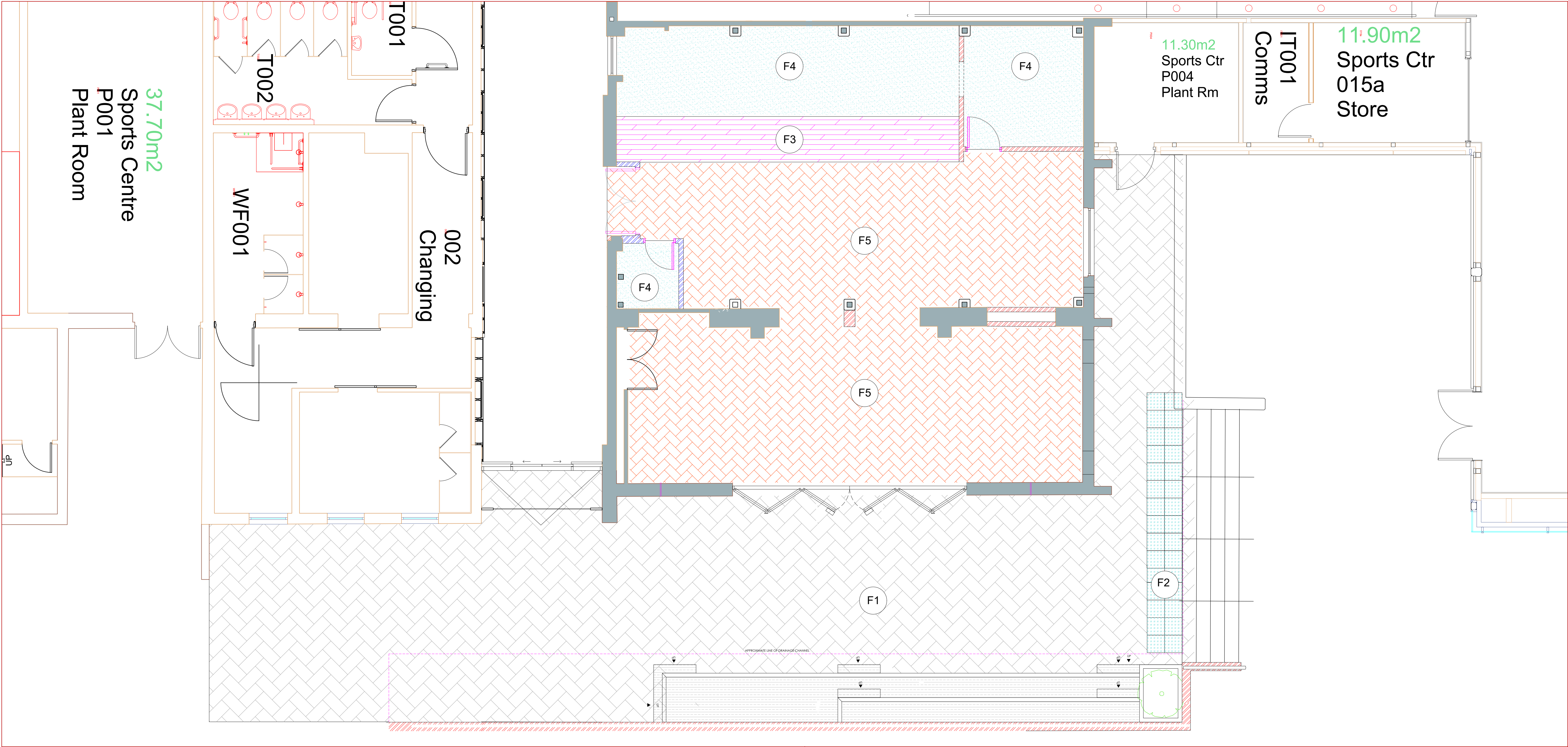

PROPOSED FLOORING DRAWING

KEY	SPECIFICATION	SUPPLIER	KEY	SPECIFICATION	SUPPLIER	KEY	SPECIFICATION	SUPPLIER
F1	EXTERNAL PAVERS Argent coarse paving to be laid in a chevron formation - alternative bands of dark and light pavers Dark 600x 200mm Light 600 x 200mm	MARSHALLS.CO.UK	F3	FLOORING IN FRONT OF COUNTER EXPONA COMMERCIAL Light classic oak 4085 Laid horizontally across space	POLYFLOR	F5	FLOORING TO MAIN AREA Random lay chevron vinyl plank wood effect flooring EXPONA COMMERCIAL white oak 4037 Light elm 4034 Dark classic oak 4088 Light classic oak 4085	POLYFLOR
F2	EXTERNAL BLISTER TACTILE Standard Charcoal 450mm x 450mm	MARSHALLS.CO.UK	F4	Non-slip flooring to behind counter,prep area & electrical cupboard Non-slip vinyl POLYFLOR Vogue Ultra Night sky 4780 with coved skirting profile to prep area	POLYFLOR	SCOPE INTERNALLY - All existing floor finishes internally to be uplifted and removed from site, floor area to be prepared including laying new self leveling compound EXTERNALLY - existing pavers to areas identified to be uplifted and removed, contractor to rectify level of external space prior to laying new pavers.		

Unit 6, The Astra Centre,
Edinburgh Way,
Harlow, Essex. CM20 2BN.
☎ :01279 451335.
📠 :01279 406519.
brian.wells@bunzl.co.uk



<p>Caveat: This drawing and any subsequent related drawings constitute an outline conceptual scheme only and may be subject to revision after completion of a full measured and structural survey and appraisal. No Local Authorities have yet been consulted regarding town planning, building control, emergency services, licensing and other relevant approvals, this scheme must be considered as possibly subject to consequent revision after this consultation process has been completed. Your attention is drawn to the risk assessment and individual design notes for the project identified at this stage to comply with current legislation.</p> <p>© This drawing is the property of Aggora Lockhart Projects which is a trading division of Bunzl UK Limited and must not be copied or reproduced in full or in part without express written permission.</p> <p>Do Not Scale From This Drawing.</p>
All Dimensions To Be Confirmed On Site.

Revision:	Description:	Date:	Rev By:

Revision:	Description:	Date:	Rev By:
C	Flooring revised to suit revised base plan	25.11.22	JHR
B	Extent of external paving increased following site visit. Tactile tiles added to front of steps as requested	10.10.22	JHR
A	Extent of external paving revised	19.09.22	JHR

Accepting Signature:
Print Name:
Company:
Date:
Drawing Approval:

CLIENT:	Brunel University - sports centre cafe		
Drawing Title:	Flooring Drawing		
Scale @ ISO A1 :	1:50	Drawn By :	JHR
Drawing Number :	AGJ1068 -11	Revision :	C
Date :	24.08.22		
Drawing Status :	Preliminary	Information	Approvals
		As Fitted / Built	