

### Site Plan - 1:200

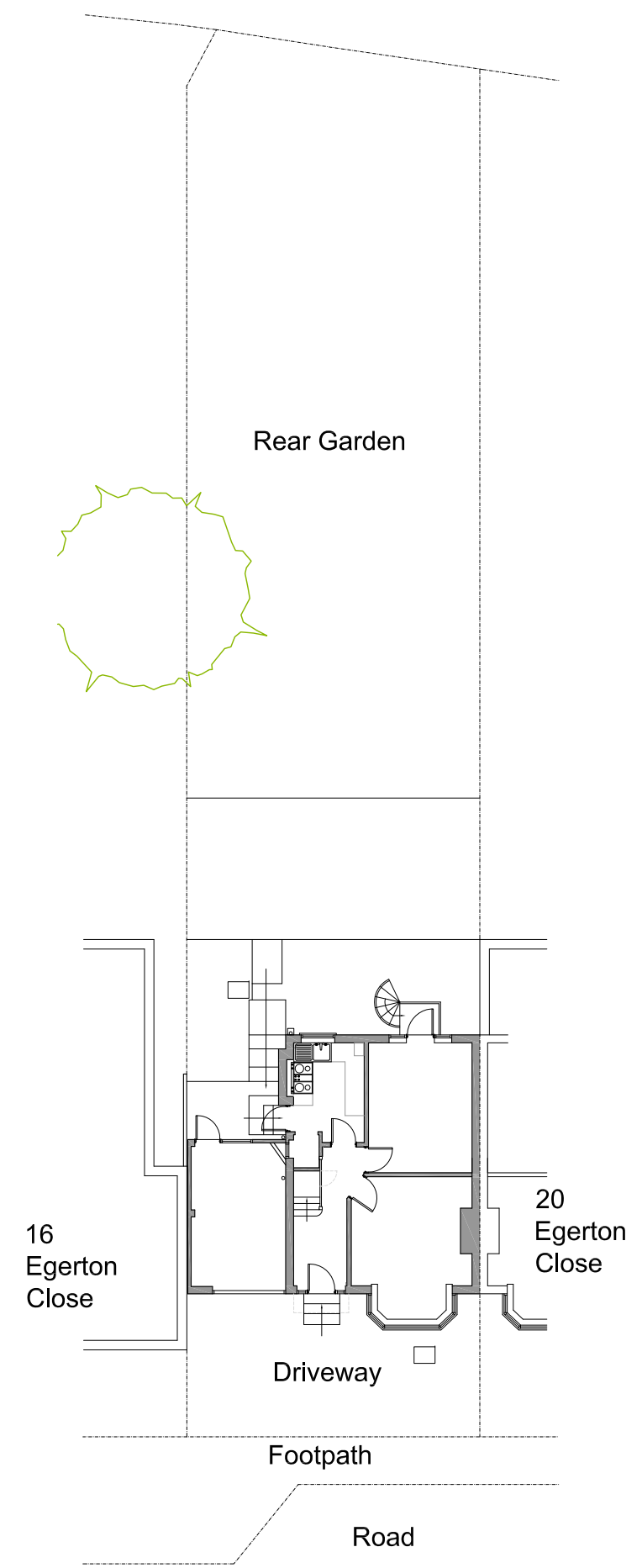

### Location Plan - 1:1250

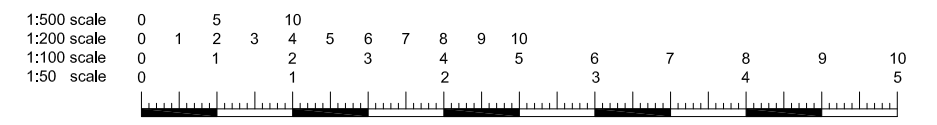
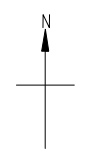
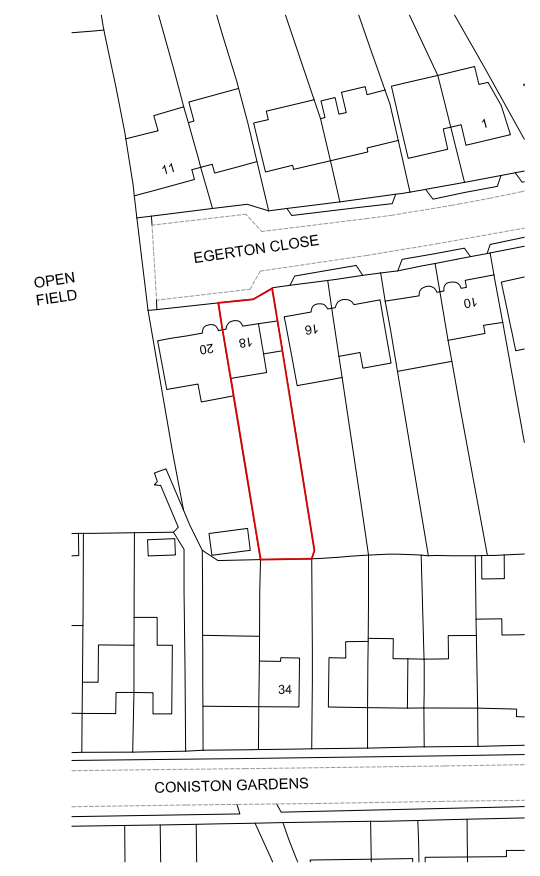

<small>All dimensions and levels to be checked on site by contractor prior to commencement of work. This drawing and the copyrights and patents therein are the property of the Linear Insight Ltd and may not be used or reproduced without consent. This drawing is to be read in conjunction with all relevant consultants and/or specialist's drawings/documents and any discrepancies or variations are to be notified to the designer before the affected work commences. All works on site are to be carried out fully in accordance with current CDM regulations and recommendations, current Building Regulations, British Standards and Codes of Practice as appropriate.</small>	Purpose of Issue	Project	Drawing	<b>LINEAR INSIGHT Ltd</b> <small>Architectural Design and Development Solutions  info@linearinsight.com - www.linearinsight.com</small>
	Preliminary	<input checked="" type="checkbox"/> 18 Egerton Close	Existing Location and Site Plan	
	Information	<input type="checkbox"/> Plinner		
	Approval	<input type="checkbox"/> London		
Tender	<input type="checkbox"/> HA5 2LP	Client	Drawing Scale	Date
Construction	<input type="checkbox"/> Mr and Mrs Rahman	Mr and Mrs Rahman	1:200/1250@A3	Feb 2026
			Drawing No.	Rev.
			1627-001-PD	—