

- NOTES
1. All dimensions are to be checked on site prior to the commencement of work and any discrepancy is to be reported to the construction manager before construction.
 2. All work is to comply with the current Building Regulations and allied legislation.
 3. All contractors and sub-contractors must ensure that they have the latest issue of this drawing and related details before the commencement of work on site.
 4. All materials are to be used and installed in strict compliance with the relevant manufacturers instructions and recommendations.
 5. All works on site managed and represented as a result of the design indicated on this drawing are to be given full consideration for compliance with the Health and Safety (CDM) Regulations in respect of Design and Implementation on site and no works are to be undertaken if it is considered that compliance with the CDM Regulations cannot be achieved.
 6. This drawing is not to be scaled.
 7. All dimensions shown in millimetres.

Flat roof construction as specified is to be finished with Sarnafil G410-15EL polyvinyl chloride(PVC) synthetic waterproofing sheet applied in accordance with manufacturers requirements on min. 150mm Kingspan 'Thermaroof' TR26 LPC/FM rigid urethane insulation board or similar approved on min. 250micron/1000guage polythene sheet vapour control layer on min. 18mm external quality ply decking laid to falls max. 160 on sw firings on sw flat roof joists in accordance with Structural Engineers specification requirements.

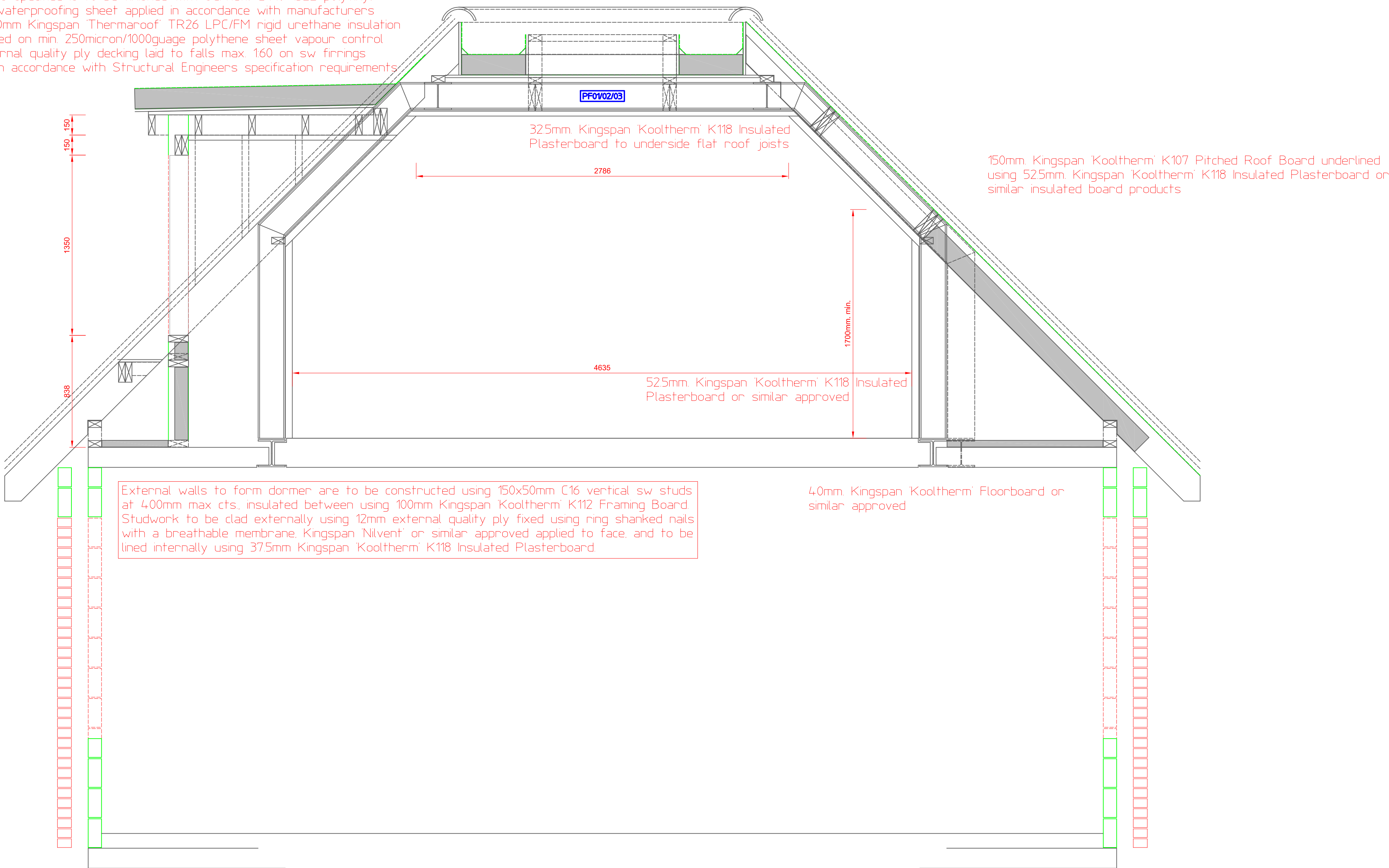

SECTION
Scale 120

Revision	Date	Remarks

MARTYN COX ASSOCIATES
Lower Farm Cottage, Upton Road, Upton
Aylesbury, Bucks. HP17 8UA
tel.no. 01296 749966 mobile 07590 849989
e-mail: martin.cox7@btconnect.com

Contract	Drawing Title ROOF LEVEL SECTION		
Client GAVACAN HOMES LTD.	Scale 120	Date October 25	Drawn mc
	Dwg. No. 2446-br701	Rev.	