

WARM DECK CONSTRUCTION FOR FLAT ROOF EXTENSIONS.

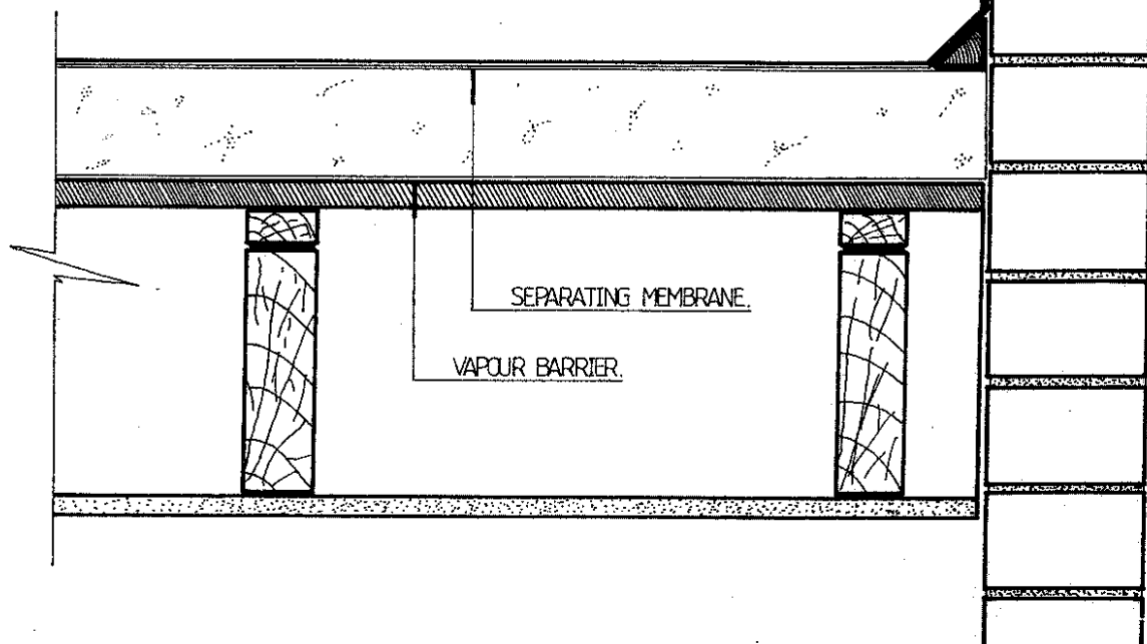

WEATHERING – All felt roofing to be carried out by specialist contractors and be of a type and construction complying with the recommendations of CP 144 pt3 1970. Min 3 layers hot bond type 5u then type 5B on top

E17 REQUIREMENTS – AA, AB, AC rating can be achieved by either: -

- a) 12.5mm thick bitumen, bedded solar reflective stone chippings.
- b) Non-combustible tiles or slabs bedded in hot bitumen.
- c) G.R.P.

SEPARATING MEMBRANE – Positioned immediately on top of insulation.

Single ply felt of the type having 25mm diameter holes at approx. 100mm centres laid dry on insulation. Second layer of felt poured and rolled with hot bitumen.

INSULATION – Laid directly on top on vapour barrier and fixed as recommended by the manufacturers. Insulation to be in accordance with approved documents. Min 135mm thickness, Celotex, Kingspan or similar approved to a U value of 0.18 W/m² K

DECKING / VAPOUR BARRIER

19mm Plywood: 1st layer: Type 3B hot bonded to decking. 2nd layer: High performance roofing fully bonded. Side and end laps fully sealed. Loose lay 3G on top of Insulation.

19mm Timber tongue and grooved.

1st layer: High performance roofing nailed. 2nd layer: Type 2B or 3B felt, fully bonded Side and end laps fully sealed.

VAPOUR CHECK

19mm Plywood: Type 2B or 3B felt fully bonded. End and side lap sealing not necessary.

19mm Timber tongue and grooved.

Type 2B felt nailed. End and side lap not necessary.

FIRRING

- a) Fixed directly on top of joist when deck is timber boarding.
- b) Either directly on top of joist or at right angles to same when deck is external quality plywood.

JOIST – In accordance with detail drawing applicable spanning either side to side or front to back. Preservative treatment is recommended but not essential. No ventilation required to roof void.

Mr & Mrs Lad
34 Ivy House Road, Ickenham

DRG No. 4582/SK/01