

Mr J Gadhia  
9 Linksway  
Northwood  
HA6 2XA

9<sup>th</sup> January 2025

Dear Mr Gadhia,

**RE: Trees at 9 Linksway, Northwood, HA6 2XA**

Thank you for your instruction to undertake an assessment of the above site in relation to your landscape proposals which include the removal of a small number of tree as well as the provision for planting of 33 new trees (including 24 pleached trees). I duly visited the site on the 5<sup>th</sup> December 2024 and can now advise as follows.

The landscape scheme has been produced for planning condition 3 relating to the approved new house which is now under construction. I previously visited the site as part of the application for the main house and produced the tree plans for this application; the plan below updates this survey as some trees have been removed and I also undertook a more detailed survey of trees to the rear of the site near to some new landscape proposals.

*Below: excerpt from tree survey updated December 2024:*

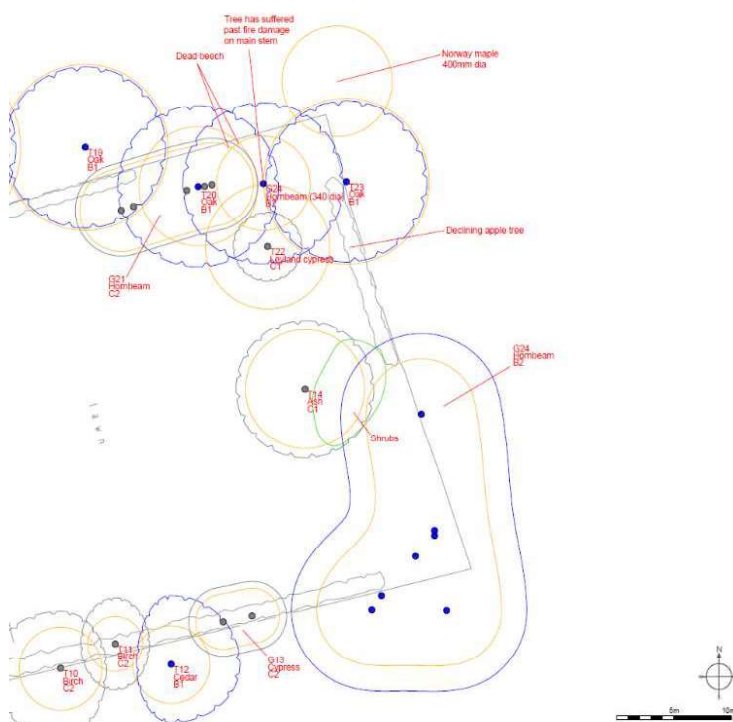

Having reviewed the DDA landscape plan (ref: 1363/P/7F) I note that trees G21 and the northern standalone hornbeam from G24 require removal. Please note that T14 and T22 have already been removed as these trees were not covered by the Tree Preservation Order (TPO).

G21 is a lapsed hedge and was previously graded as C category. Whilst these trees are covered by the TPO, they are suppressed low value trees with little prospect of ever developing into fully formed trees given the other nearby trees and their tightly packed stems.

The northern tree of G24 has suffered from historic fire damage as can be seen on the photo below. This tree is also of limited visual amenity given its rear garden location and the presence of T20 and T23, oak trees which are either side of this tree and which will be retained.

*Below: tree in G24 proposed for removal:*



Where sections of the new hard and soft landscaping are in the RPAs of retained trees, a no-dig construction will be necessary to ensure that satisfactory moisture and oxygen can be obtained from the underlying soil by any tree roots in this area. The implementation of this must be undertaken in close coordination with the retained arboriculturalist and porous materials used to ensure rainwater can penetrate the soil beneath the new patio.

In conclusion, the trees proposed for removal are either of low value or are compromised due to their condition. The loss of these trees will not adversely impact the local or wider landscape, especially when considering the substantial number of new trees proposed for planting.

I hope this is of assistance to you, however should you have any queries please do not hesitate to contact me.

Best regards



Glen Harding MICFor, MSc (Forestry), MArborA  
For and on behalf of GHA Trees

