

NOTES

1. All dimensions are to be checked on site prior to the commencement of work and any discrepancy is to be reported to the construction manager before construction.
2. All work is to comply with current Building Regulations and allied legislation.
3. All contractors and sub-contractors must ensure that they have the latest issue of this drawing and details before the commencement of work on site.
4. All materials are to be used and installed in strict compliance with the relevant manufacturers instructions and recommendations.
5. All works on site, managed and implemented as a result of the designs indicated on this drawing, are to be given full consideration for compliance with the Health and Safety CDM Regulations in respect of design and implementation on site and no works are to be undertaken if it is considered that compliance with the Building Regulations cannot be achieved.
6. All dimensions shown in millimetres.
7. Footprint of buildings shown at 10m above ground level.

LEGEND

- Refuse skip
- Approved dwelling
- Existing structure to be demolished
- Fixed tree protective fencing
- 1m scaffold framework
- Site office and welfare
- WC facilities
- Site personnel and visitor parking
- Materials storage compound
HW - heavy weight
LW - light weight
- Onsite vehicle movement area
- Distribution of materials by crane
- High pressure extendable water hose for wheel washing
- Secure site access gates
- Site hoarding

LEGEND

- Extent of proposed building
- Existing structures to be demolished
- Existing trees & planting to remain
- Root protection area (RPA)
- Fixed tree protective fencing as per GHA tree report
- Proposed ground protection

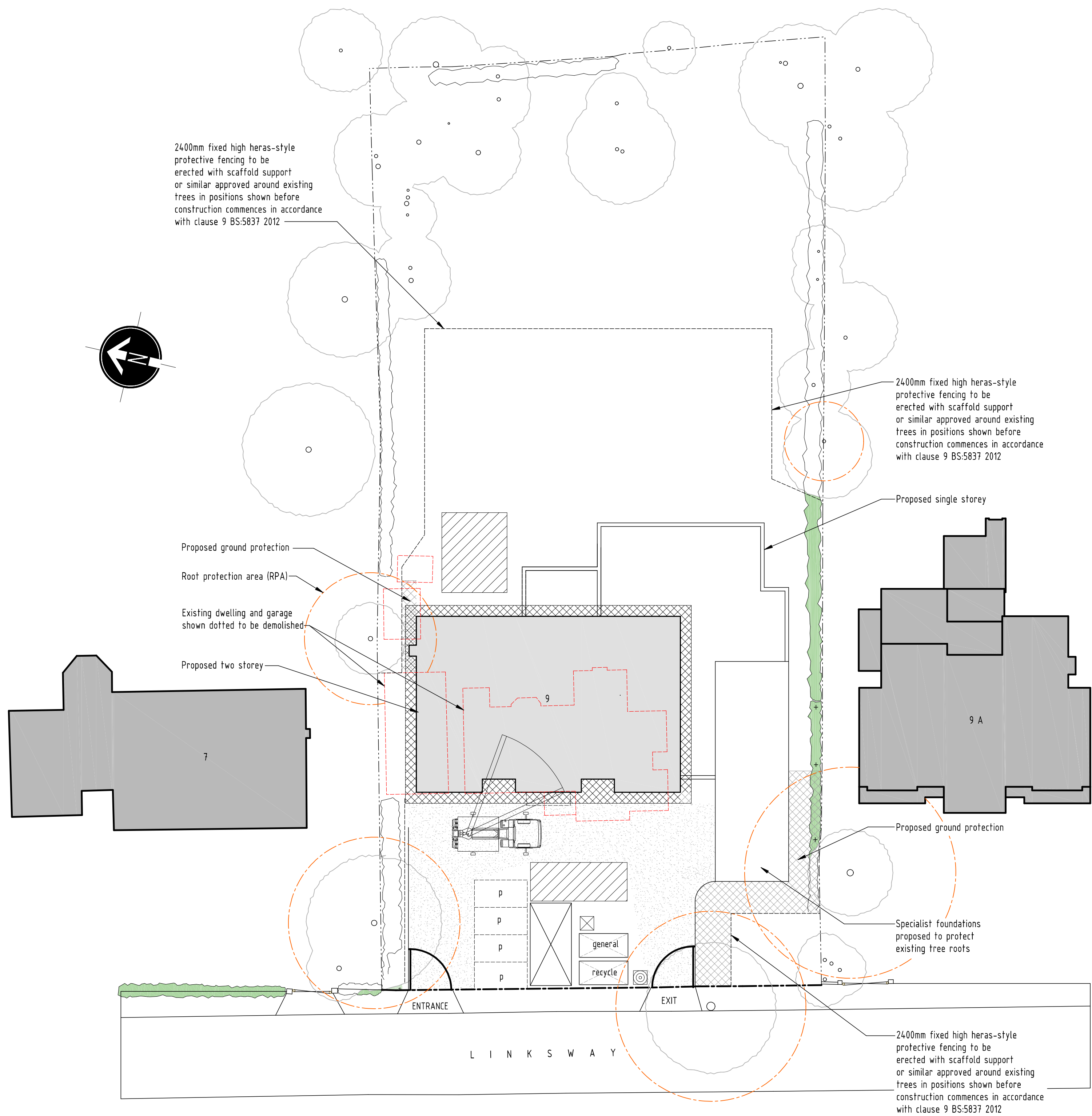

SITE LAYOUT PLAN - SCALE 1:250

TREE AND GROUND PROTECTION DETAILS TO BE READ IN CONJUNCTION WITH GHA ARBORICULTURAL REPORT

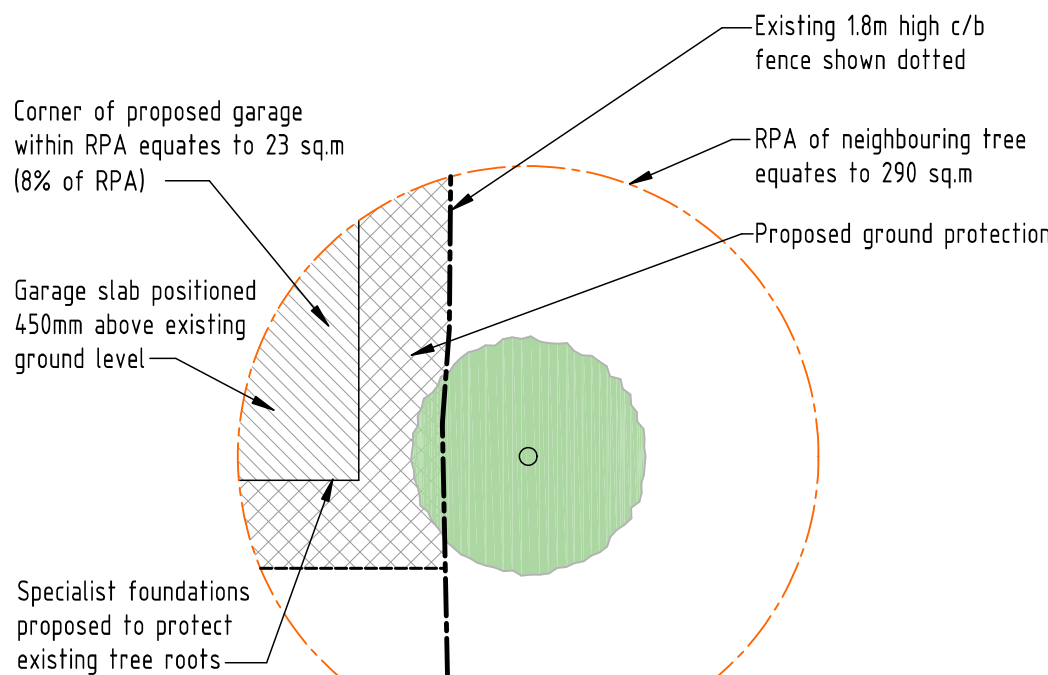

RPA DETAIL - SCALE 1:250

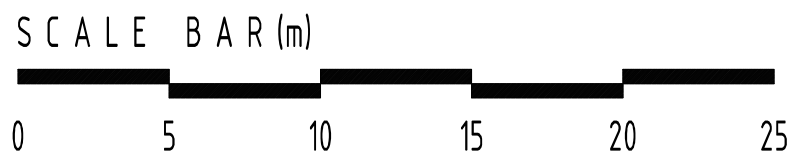

rev:	date:	description:
scale:	1 : 250	A1 date: 12 / 11 / 2020
drawing no:	1363 / P / 10	drawn: AT
drawing:	PLANNING PROPOSALS, SITE WORKS PLAN	
project:	LAND AT 9 LINKSWAY, NORTHWOOD, MIDDLESEX, HA6 2XA	
client:	DDA	



DUSEK DESIGN ASSOCIATES LTD
ARCHITECTURE + PLANNING

01895 831 103
info@dusek.co.uk
www.dusek.co.uk

print history: Tuesday, 24 May, 2022 12:59:27

S:\000P\0000\1363\000001\9 LINKSWAY, NORTHWOOD\0001\1363-P-4.dwg