

NOTES

1. All dimensions are to be checked on site prior to the commencement of work and any discrepancy is to be reported to the construction manager before construction.
2. All work is to comply with current Building Regulations and allied legislation.
3. All contractors and sub-contractors must ensure that they have the latest issue of this drawing and details before the commencement of work on site.
4. All materials are to be used and installed in strict compliance with the relevant manufacturers instructions and recommendations.
5. All works on site, managed and implemented as a result of the designs indicated on this drawing are to be given full consideration for compliance with the Health and Safety (CDM) Regulations in respect of design and implementation on site and no works are to be undertaken if it is considered that compliance with the Building Regulations cannot be achieved.
6. All dimensions shown in millimetres.
7. Footprint of buildings shown at 10m above ground level.

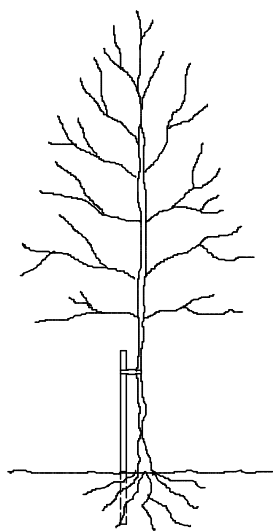

TREE STAKING DETAIL

TREE STAKING SPECIFICATION

For selected standard trees o/a height 3.0-3.5m. Support using stakes extending to 1.0-1.2m above ground and 0.6-0.75m below ground level (depending on ground conditions).

Supported by single non reinforced tie 75mm from top of stake.

Remove stake on onset of or during the second growing season after planting.

LANDSCAPE SPECIFICATION

Landscaping generally to be carried out in accordance with BS.4428. All new trees to be supplied as selected standards unless otherwise noted.

Overall height 3.0-3.5m and 1.8-2.1m, straight stem to BS.3936 Part 1 1992. Trees supplied with bareroots with polythene wrapping or as noted otherwise, and planted in a min of 3.0 litres peat. Planting beds to be excavated and lined with screened topsoil enriched with peat free compost/fertiliser or similar manure 50mm deep, top dressed with 75mm deep forest bark mulch.

Site to be cleared of all builders rubble and rotavated levelled and filled before planting commences. Front gardens to be turfed and rear gardens seeded.

All turfing to BS.3936 1990.

Pernicious weeds are to be treated with trans-located herbicide during growing season (spot treated).

Tree and shrub planting to BS.3936 Part 1 1992.

Sub-soil areas below planting to be de-compacted before planting commences.

Tree protection to be carried out in accordance with BS.5837 2012.

DRIVEWAY SPECIFICATION

Driveways to be finished with Addastone Resin Bonded Gravel bedded on 50mm sharp sand on GEOTEXTILE membrane on 6-20mm graded aggregate sub-base on geotextile membrane on compacted sub-grade to falls.

Pavers to be finished with compatible edgings.

Crossover to be finished in black tarmac. Construction specification in accordance with local authorities requirements.



STREET SCENE FROM LINKSWAY  
SCALE 1:200

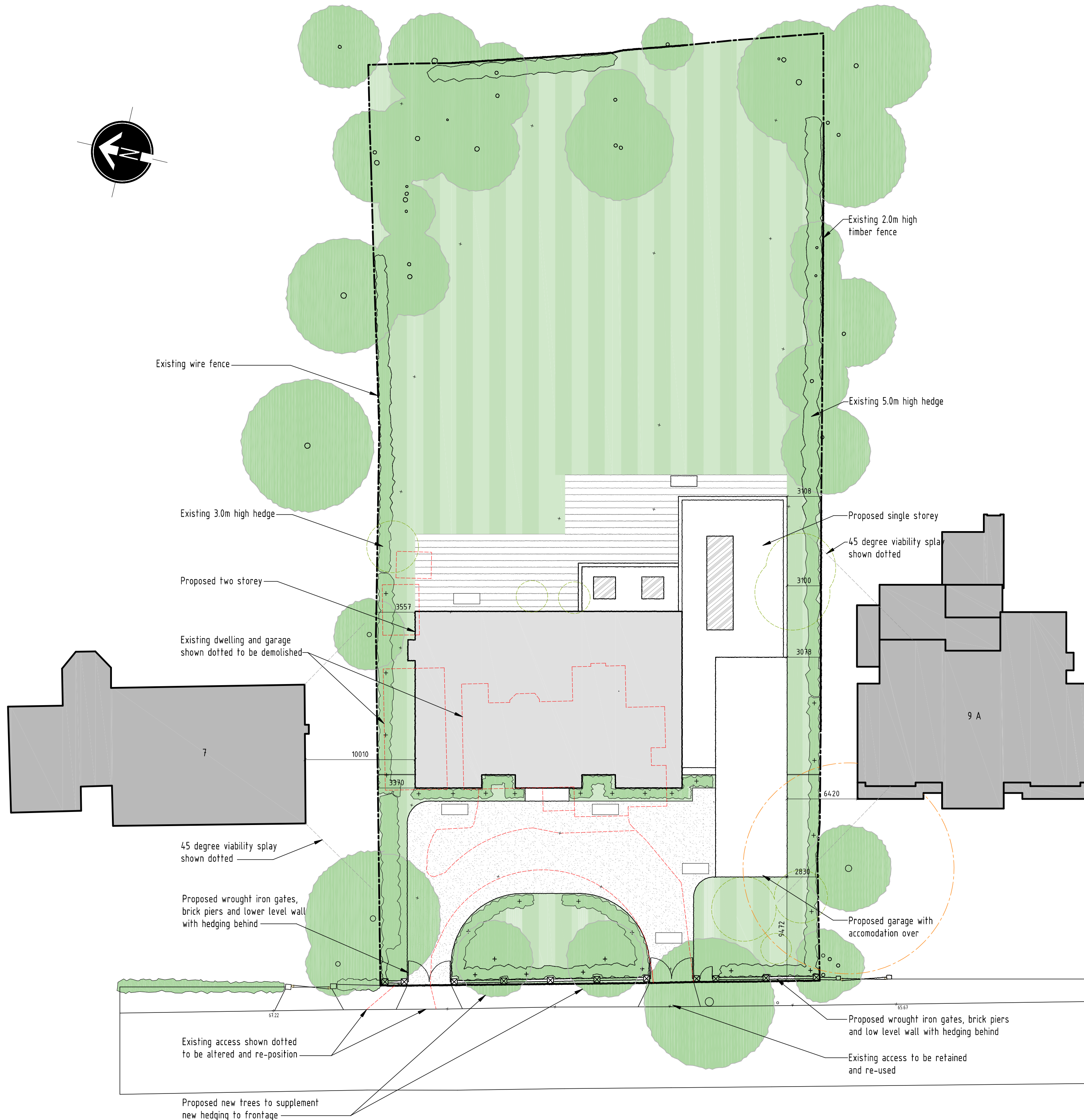

SITE LAYOUT PLAN - SCALE 1:250

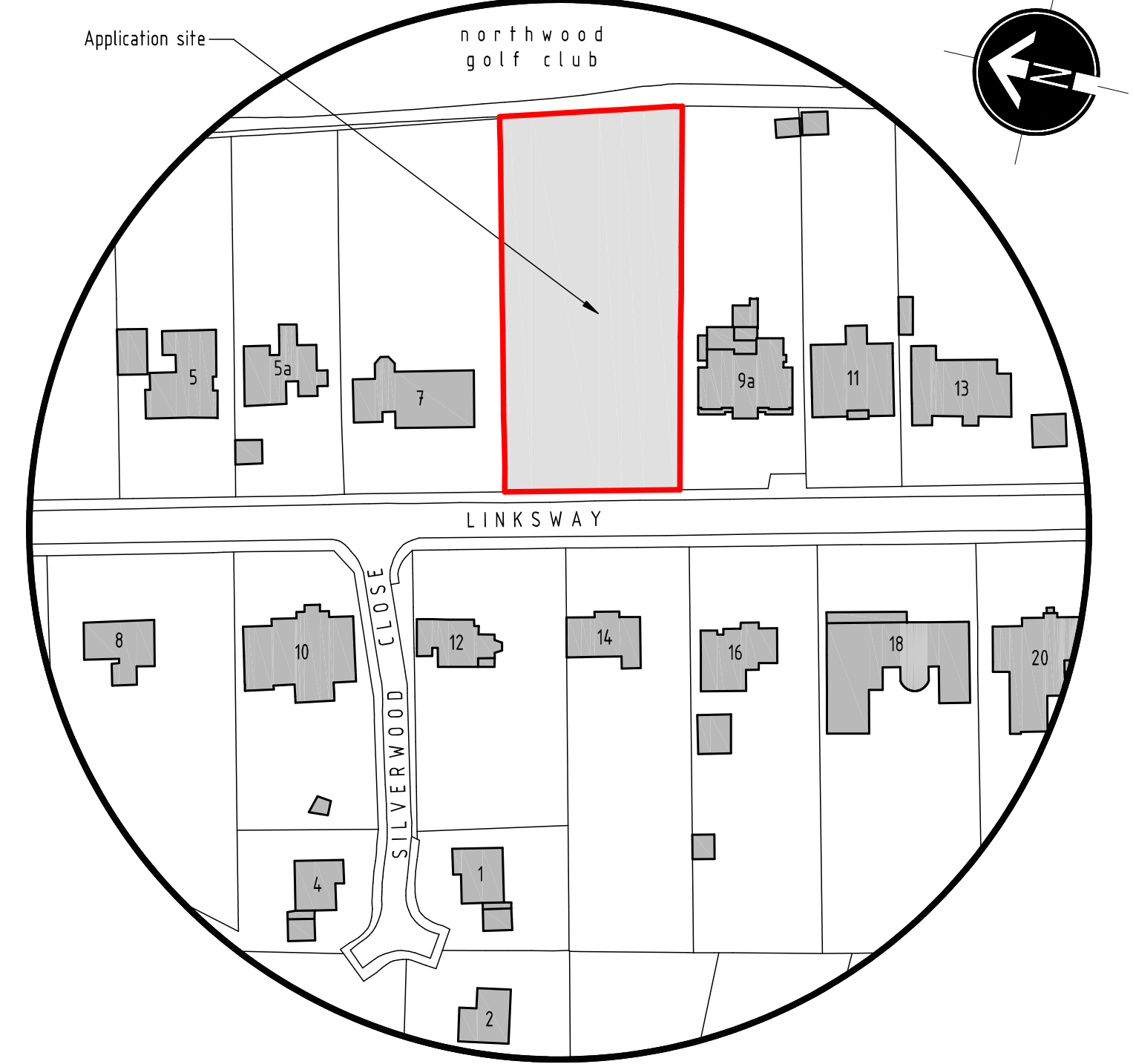

LOCATION PLAN - SCALE 1:1250



LEGEND	
Proposed two storey	Proposed structural ground floor slab level S L 6 6 . 4 5 0
Proposed single storey	Proposed Levels 66.450
Existing structures to be demolished	Existing Levels + 66.46
Existing trees & hedging to be cut back or removed	Refuse and recycling storage & collection points
Proposed new trees & planting	Surface water soakaway
Existing trees & planting to remain	Root protection area (RPA)
	Grassed areas

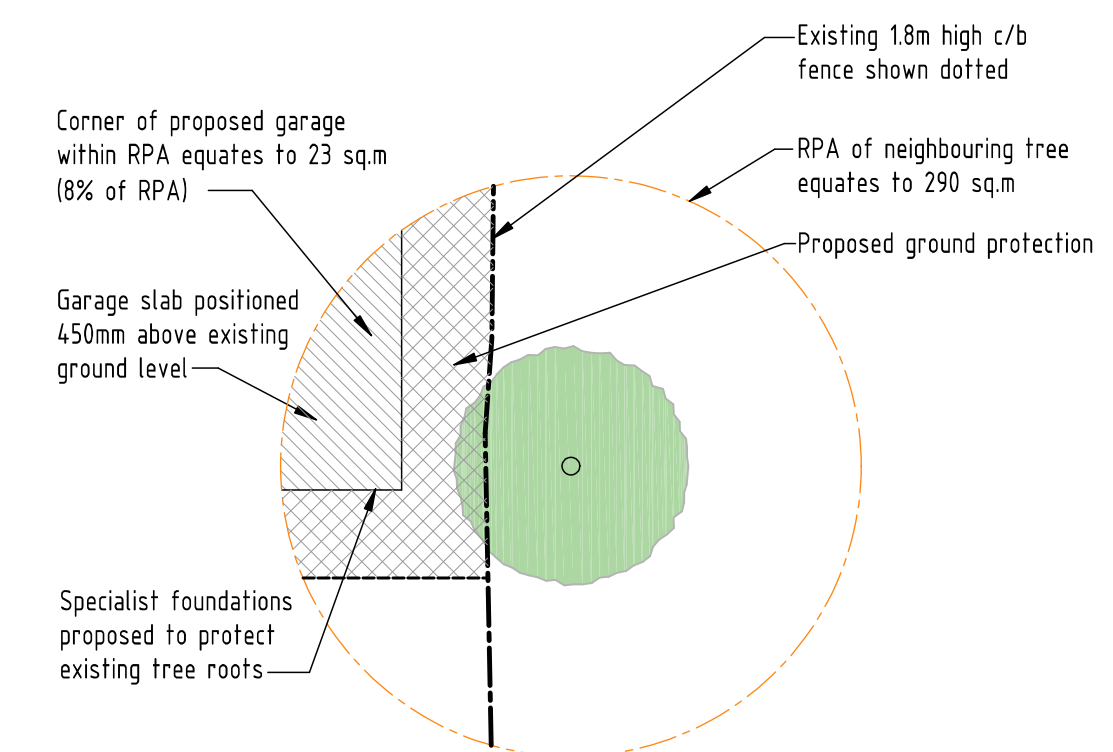

RPA DETAIL - SCALE 1:250

C	14-06-2024	Piers adjusted	
B	27-03-2024	Proposed single storey amended	
A	12-03-2024	Drive finish amended.	
rev:	date:	description: 0.343 ha	
scale:	1 : 250	A1	date: 12 / 11 / 2020
drawing no:	1363 / P / 1 <sup>C</sup>		drawn: FJ
drawing:	PLANNING PROPOSALS, SITE LAYOUT PLAN & LOCATION PLAN		
project:	LAND AT 9 LINKSWAY, NORTHWOOD, MIDDLESEX, HA6 2XA		
client:	DDA		



DUSEK DESIGN ASSOCIATES LTD  
ARCHITECTURE + PLANNING  
01895 831 103  
info@dusek.co.uk  
www.dusek.co.uk

print history: Friday, 14 June, 2024 17:08:42

C:\Users\ANDY\OneDrive - Dusek Design Associates Ltd\Documents\1363 - LAND AT 9 LINKSWAY, NORTHWOOD\1363-P-1.dwg

