

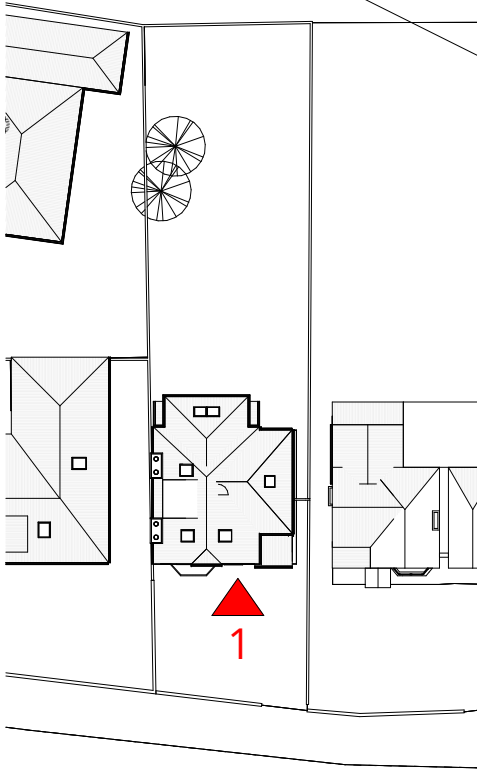

01 PROPOSED FRONT VIEW
NTS @ A3

SIDE & REAR DOUBLE STOREY EXTENSION SCHEME



01 KEY PLAN
1:500 @ A3



PLANNING ISSUE 1

J79 STUDIO

T: +44 (0)7742 071 052
W: info@j79studio.co.uk

Unit 312
Wey House
15 Church Street
Weybridge
KT13 8NA

FOR
ALL DIMENSIONS TO BE CHECKED ON SITE
OBTAINED BUILDING CONTROL /PLANNING
APPROVAL BEFORE WORK COMMENCE

This drawing is the property of J79 Studio. Copyright is reserved & this drawing is issued on the condition that it is not copied, reproduced, retained or disclosed to any unauthorised person, either wholly or in part, without our consent. Do not scale from this drawing, check all dimensions on site. Any errors please notify architect in the first instance.

Rev	Date	Note
P1	28-04-22	Planning issue 1
PROJECT		
117 Belmont Rd, Uxbridge UB8 1QZ		
DRAWING TITLE		
PROPOSED DEVELOPMENT / STATUS		
Rear Extension / Front porch + front bay window		
DRAWN BY		CHECKED BY
Author		Checker

PROJECT NO.	DATE	SCALE
1900	APR 2022	1:100 @ A3
DRAWING NO.		REVISION
A300		P1