

- THIS DRAWING IS NOT TO BE SCALED
- FIGURED DIMENSIONS TO TAKE PREFERENCE TO SCALED DIMENSIONS
- ALL CONTRACTORS WORK TO COMPLY WITH THE LATEST CODES OF PRACTICE AND TO BE TO THE SATISFACTION OF THE LOCAL AUTHORITIES
- ANY DISCREPANCY/ISSUE TO BE REPORTED TO THE ARCHITECT BEFORE COMMENCING
- THE CONTRACTOR IS TO VERIFY ALL LEVELS, DIMENSIONS AND BUILDING LINES BEFORE ANY WORK COMMENCES ON SITE
- ALL SETTING OUT TO BE THE CONTRACTORS ENTIRE RESPONSIBILITY
- ALL SERVICES TO BE COORDINATED BY THE CONTRACTOR BEFORE COMMENCING
- THE CONTRACTOR IS RESPONSIBLE FOR ANY SITE VISITS BY LOCAL AUTHORITIES FOR THE REASONED RESEARCH OF THE PROJECT AND FOR THE CONSULTANTS AND OTHER CONSULTANT DRAWINGS AND DETAILS WHERE APPLICABLE

[illegible][illegible]

**MARK ZUDINI**  
ARCHITECTURE + DESIGN

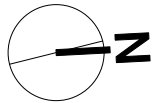

- THIS DRAWING IS NOT TO BE SCALED
- FIGURED DIMENSIONS TO TAKE PREFERENCE TO SCALED DIMENSIONS
- ALL CONTRACTORS WORK TO COMPLY WITH THE LATEST CODES OF PRACTICE AND TO BE TO THE ENTIRE SATISFACTION OF LOCAL AUTHORITIES .
- ANY DISCREPANCIES TO BE REPORTED TO THE ARCHITECT BEFORE COMMENCING
- THE CONTRACTOR IS TO VERIFY ALL LEVELS, DIMENSIONS AND BUILDING LINES BEFORE ANY WORK COMMENCES ON SITE
- ALL SETTING OUT TO BE THE CONTRACTORS ENTIRE RESPONSIBILITY
- ALL SERVICES TO BE COORDINATED BY THE CONTRACTOR BEFORE COMMENCING
- THE CONTRACTOR IS RESPONSIBLE FOR ANY SITE VISITS BY LOCAL AUTHORITIES
- READ THESE ARCHITECTURAL DRAWINGS IN CONJUNCTION WITH ENGINEERS AND OTHER CONSULTANT DRAWINGS AND DETAILS WHERE APPLICABLE

[illegible]

29 CHENEY ST HA5 2TG

DRAWING TITLE

ROOF PLAN AS EXISTING

SCALE

1:50 @ A3

DRAWING NO. 2205 - 104

DATE	DRAWN BY
11/09/2022	EA

[illegible]

**29 CHENEY ST HA5 2TG**



## GENERAL NOTES

- THIS DRAWING IS NOT TO BE SCALED
  - FIGURED DIMENSIONS TO TAKE PREFERENCE TO SCALED DIMENSIONS
  - ALL CONTRACTORS TO COMPLY WITH THE LATEST CODES OF PRACTICE AND TO BE TO THE ENTIRE SATISFACTION OF LOCAL AUTHORITIES .
  - ANY DISCREPANCY TO BE REPORTED TO THE ARCHITECT BEFORE COMMENCING
  - THE CONTRACTOR IS RESPONSIBLE FOR ALL LEVELS, DIMENSIONS AND BUILDING LINES BEFORE ANY WORK COMMENCES ON SITE
  - ALL SETTING OUT TO BE THE CONTRACTORS ENTIRE RESPONSIBILITY
  - ALL SERVICES TO BE COORDINATED BY THE CONTRACTOR BEFORE COMMENCING
  - THE CONTRACTOR IS RESPONSIBLE FOR ANY SITE VISITS BY LOCAL AUTHORITIES
- READ THESE ARCHITECTURAL DRAWINGS IN CONJUNCTION WITH ENGINEERS AND**  
**NOTES AND TAKE INTO ACCOUNT ALL THE INFORMATION CONTAINED THEREIN.**

## REVISION NOTES

[illegible]

## PROJECT TITLE

29 CHENEY ST HA5 2TG

## DRAWING TITLE

FRONT ELEVATION AS EXISTING

## SCALE

1:50 @ A3

## DRAWING NO.

2205 - 107

## DATE \_\_\_\_\_

11/09/2022

## DRAWN BY

EA

## REVISION

[illegible]

**29 CHENEY ST HA5 2TG**

**MARK ZUDINI**  
ARCHITECTURE + DESIGN  
2 Lane Close London NW2 6QZ t. 07908916182 e.mark@zudini.com

1 FRONT ELEVATION AS EXISTING  
107 Scale: 1:50



## GENERAL NOTES

- THIS DRAWING IS NOT TO BE SCALED
  - FIGURED DIMENSIONS TO TAKE PREFERENCE TO SCALED DIMENSIONS
  - ALL CONTRACTORS TO COMPLY WITH THE LATEST CODES OF PRACTICE AND TO BE TO THE ENTIRE SATISFACTION OF LOCAL AUTHORITIES .
  - ANY DISCREPANCY TO BE REPORTED TO THE ARCHITECT BEFORE COMMENCING
  - THE CONTRACTOR IS RESPONSIBLE FOR ALL LEVELS, DIMENSIONS AND BUILDING LINES BEFORE ANY WORK COMMENCES ON SITE
  - ALL SETTING OUT TO BE THE CONTRACTORS ENTIRE RESPONSIBILITY
  - ALL SERVICES TO BE COORDINATED BY THE CONTRACTOR BEFORE COMMENCING
  - THE CONTRACTOR IS RESPONSIBLE FOR ANY SITE VISITS BY LOCAL AUTHORITIES
- READ THESE ARCHITECTURAL DRAWINGS IN CONJUNCTION WITH ENGINEERS AND**  
**NOTES AND TAKE INTO ACCOUNT ALL THE INFORMATION CONTAINED THEREIN.**

## REVISION NOTES

[illegible]

## PROJECT TITLE

29 CHENEY ST HA5 2TG

## DRAWING TITLE

REAR ELEVATION AS EXISTING

## SCALE

1:50 @ A3

## DRAWING NO.

2205 - 108

## DRAWN BY

EA

## REVISION

[illegible]

**29 CHENEY ST HA5 2TG**



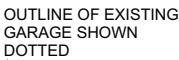

## GENERAL NOTES

- THIS DRAWING IS NOT TO BE SCALED
- FIGURED DIMENSIONS TO TAKE PREFERENCE TO SCALED DIMENSIONS
- ALL CONTRACTORS WORK TO COMPLY WITH THE LATEST CODES OF PRACTICE AND TO BE TO THE ENTIRE SATISFACTION OF LOCAL AUTHORITIES
- ANY DISCREPANCY IS TO BE REPORTED TO THE ARCHITECT BEFORE COMMENCING
- THE CONTRACTOR IS TO VERIFY ALL LEVELS, DIMENSIONS AND BUILDING LINES BEFORE ANY WORK COMMENCES ON SITE
- ALL SETTING OUT TO BE THE CONTRACTORS ENTIRE RESPONSIBILITY
- ALL SERVICES TO BE COORDINATED BY THE CONTRACTOR BEFORE COMMENCING
- THE CONTRACTOR IS RESPONSIBLE FOR ANY SITE VISITS BY LOCAL AUTHORITIES
- READ THESE ARCHITECTURAL DRAWINGS IN CONJUNCTION WITH ENGINEERS AND OTHER CONSULTANT DRAWINGS AND DETAILS WHERE APPLICABLE

## REVISION NOTES

[illegible]

## PROJECT TITLE

29 CHENEY ST HA5 2TG

## DRAWING TITLE

SIDE ELEVATION AS EXISTING

## SCALE

1:50 @ A3

## DRAWING NO.

2205 - 109

## DATE \_\_\_\_\_

11/09/2022

## DRAWN BY

EA

## REVISION

[illegible]

**29 CHENEY ST HA5 2TG**

**MARK ZUDINI**  
ARCHITECTURE + DESIGN  
Lanes Close London NW2 6QZ    t. 07906916182    e. mark@zudini.com

2 Lane Close London NW2 6QZ 1-07906916182 e.mark@zudini.com

a.mark@zuidini.com

1 SIDE ELEVATION AS EXISTING  
109 Scale: 1:50

