

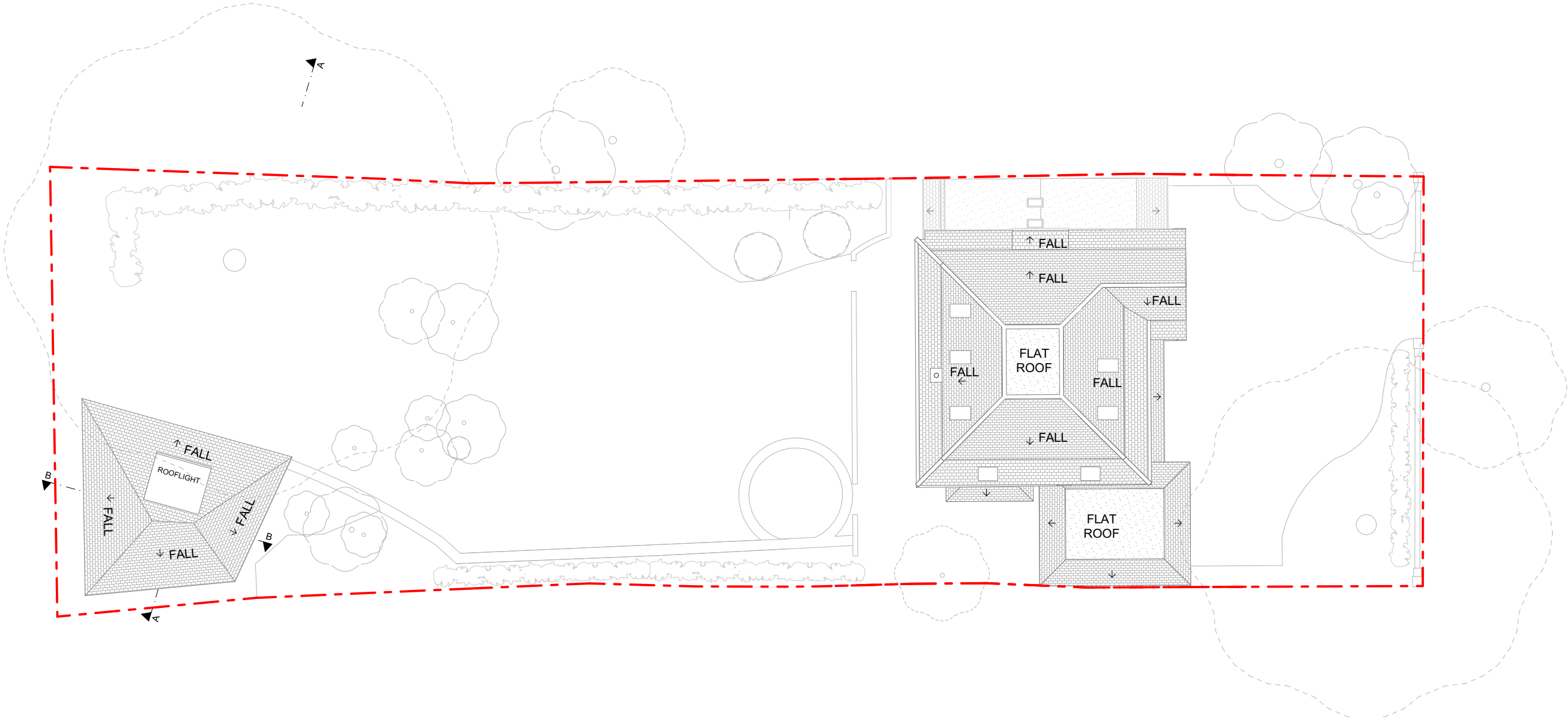

All dimensions to be checked on site. DO NOT SCALE FROM DRAWING.
Discrepancies ambiguities and/or omissions between this drawing and
information given elsewhere must be reported to the Architect immediately
before proceeding.THIS DRAWING IS COPYRIGHT.

Revision	Description	Date
P1	Revised drawings for Planning	02/2023
P2	Revised drawings for Planning	11/2023



GH (0) 09

Site Plan as Proposed

1:200

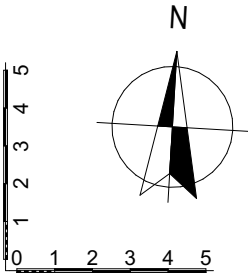

Scale:
1:200 @ A3

Date:
November/2023

Drawing Status:
Planning

Rev:
P2

Drawn By:
MS

Drawing Number:
GH (0) 09

Project Title:
37 St Martins Approach,
Ruislip HA4 7QH

Drawing Title:
Site Plan as Proposed

GK Architects Limited | London Office
Niddry Lodge | 51 Holland Street | London W8 7JB
T: 0203 280 3630 E: office@gkarchitects.co.uk

GK Architects Limited | Durham Office
Clavering House | Clavering Place | Newcastle upon Tyne NE1 3NG
T: 0191 666 0196 E: office@gkarchitects.co.uk

RIBA Chartered Practice

www.gkarchitects.co.uk

