

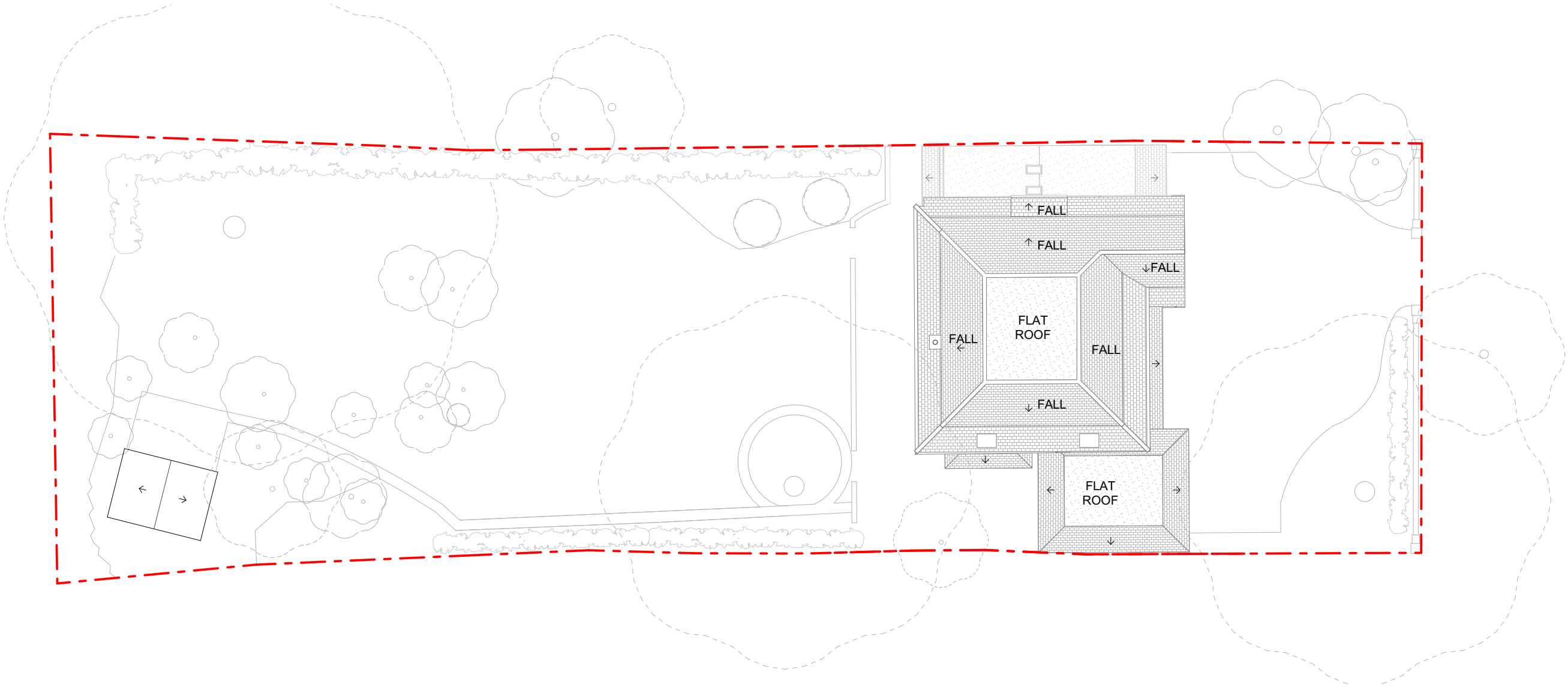

All dimensions to be checked on site. DO NOT SCALE FROM DRAWING.
Discrepancies ambiguities and/or omissions between this drawing and
information given elsewhere must be reported to the Architect immediately
before proceeding.THIS DRAWING IS COPYRIGHT.

Revision	Description	Date



E_GH (0) 09

Site Plan as Existing

1:200

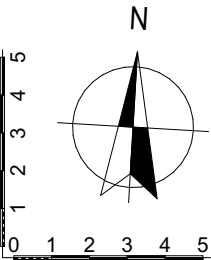

Scale:
1:200 @ A3

Date:
December/2022

Drawing Status:
Planning

Rev:

Drawn By:
MS

Drawing Number:
E_GH (0) 09

Project Title:

37 St Martins Approach,
Ruislip HA4 7QH

Drawing Title:

Site Plan as Existing

GK Architects Limited | London Office

Niddry Lodge | 51 Holland Street | London W8 7JB
T: 0203 280 3630 E: office@gkarchitects.co.uk

GK Architects Limited | Durham Office

Clavering House | Clavering Place | Newcastle upon Tyne NE1 3NG
T: 0191 666 0196 E: office@gkarchitects.co.uk

RIBA Chartered Practice

www.gkarchitects.co.uk

