

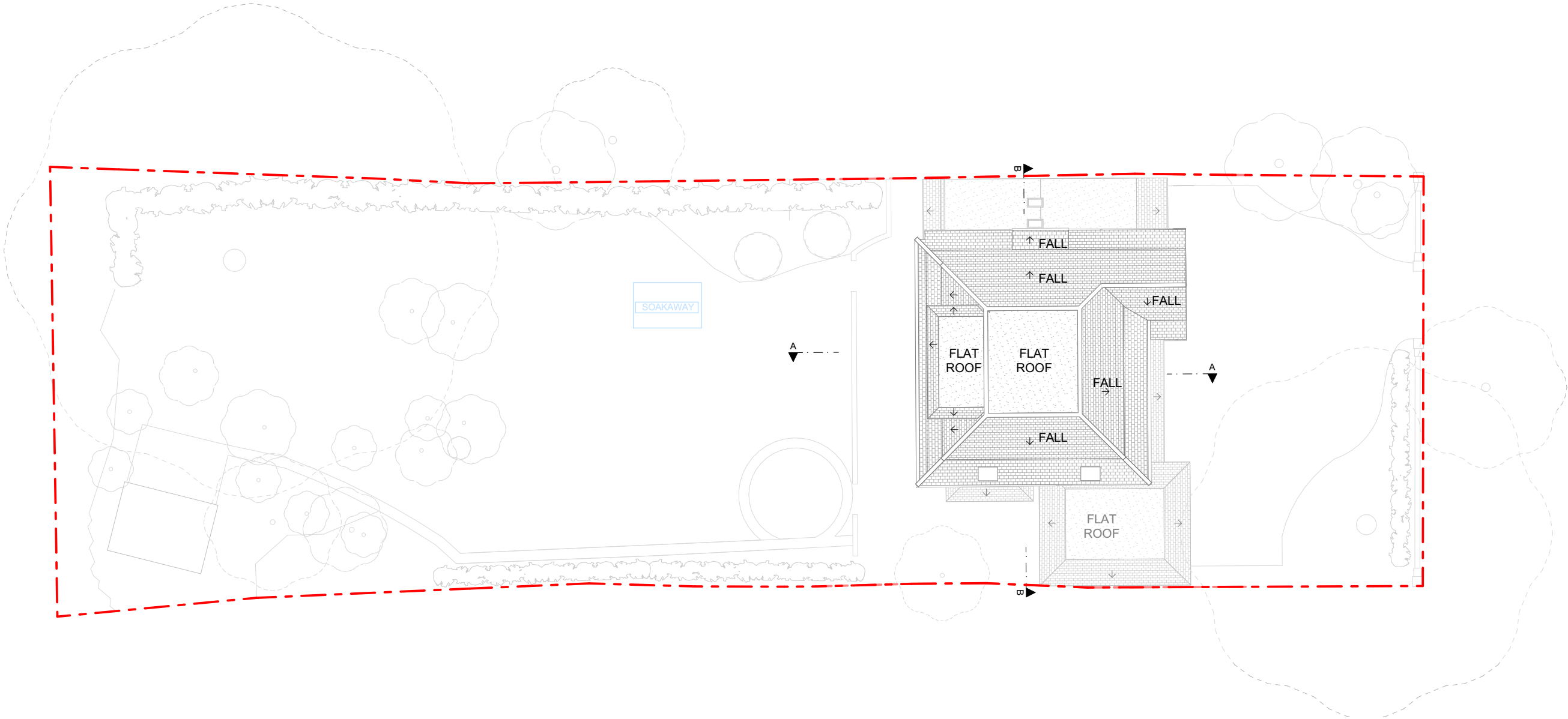

All dimensions to be checked on site. DO NOT SCALE FROM DRAWING.
Discrepancies ambiguities and/or omissions between this drawing and
information given elsewhere must be reported to the Architect immediately
before proceeding. THIS DRAWING IS COPYRIGHT.

Revision	Description	Date
P1	Revised and issued to planning	23/11/07



GA (0) 09

Site Plan as Proposed

1:200

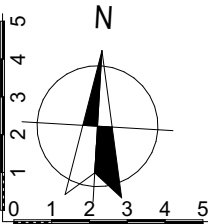

Scale:	Date:	Drawing Status:
1:200 @ A3	November/2023	Planning
Rev:	Drawn By:	Drawing Number:
P1	MS	GA (0) 09

Project Title:
37 St Martins Approach, Ruislip HA4 7QH
Drawing Title:
Site Plan as Proposed

GK Architects Limited London Office
Niddry Lodge 51 Holland Street London W8 7JB
T: 0203 280 3630 E: office@gkarchitects.co.uk
GK Architects Limited Durham Office
Clavering House Clavering Place Newcastle upon Tyne NE1 3NG
T: 0191 666 0196 E: office@gkarchitects.co.uk
RIBA Chartered Practice
www.gkarchitects.co.uk

